

THE INFORMATION CONTAINED IN THIS DRAWING IS THE SOLE PROPERTY OF ANDERSON POWER PRODUCTS. ANY REPRODUCTION IN PART OR WHOLE WITHOUT THE WRITTEN PERMISSION OF ANDERSON POWER PRODUCTS IS PROHIBITED.

Copyright 2007

ANDERSON POWER PRODUCTS RESERVES THE RIGHT TO ALTER PRODUCT TYPES, THEIR TECHNICAL DATA, DIMENSION, STYLE AND ACCESSORIES WITHOUT PRIOR NOTIFICATION.

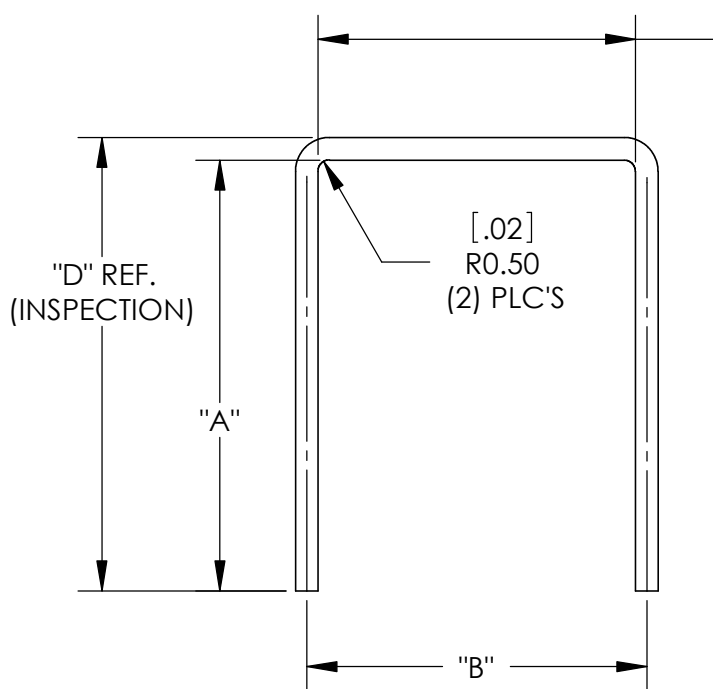

"C" REF.
(INSPECTION)

"D" REF.
(INSPECTION)

[.02]
R0.50
(2) PLC'S

"A"

"B"

[.039]
Ø1.00

Part #	Configuration	"A"		"B"		"C"		"D"	
		mm	in	mm	in	mm	in	mm	in
P1	1X1 Short	12.0	0.47	7.0	0.28	6.0	0.24	13.0	0.51
P2	1X2 Short	12.0	0.47	14.5	0.57	13.5	0.53	13.0	0.51
P3	1x3 Short	12.0	0.47	22.5	0.89	21.5	0.85	13.0	0.51
P4	3x2 Short	28.0	1.10	14.5	0.57	13.5	0.53	29.0	1.14
P5									
P6	2x2 Short	20.0	0.79	14.5	0.57	13.5	0.53	21.0	0.83
P7	1x4 Short	12.0	0.47	30.5	1.20	29.5	1.16	13.0	0.51
P8	1x6 Short	12.0	0.47	46.5	1.83	45.5	1.79	13.0	0.51
P9	2x2 Long	23.0	0.91	14.5	0.57	13.5	0.53	24.1	0.95
P10	2x1 Short	20.0	0.79	7.0	0.28	6.0	0.24	21.0	0.83
P11	1X2 Long	17.0	0.67	14.5	0.57	13.5	0.53	18.0	0.71
P13	1x6 Long	17.0	0.67	46.5	1.83	45.5	1.79	18.0	0.71

DIMENSIONS ARE IN:		MM[INCH]	APPROVALS		<p>ANDERSON POWER PRODUCTS</p> <p>TITLE</p> <p>PP 15/45 STAPLES FOR PCB ASSEMBLIES</p>					
UNLESS OTHERWISE STATED			DRAWN	LH 10/24/06						
TOLERANCES:			CHECKED	DJD 10/31/06						
DECIMALS (INCH) DECIMALS (MM) ANGLES .XX ± .015 .X ± .1 ±.5° .XXX ± .005 .XX ± .05			MFG APP	CHB 10/31/06						
SURFACE FINISH:			QC APP							
MACHINED 128 [3.2] ✓ MOLDED 64 [1.6] ✓			ENG APP	DAM 10/31/06						
MATERIAL: PRE-PLATED COPPER ALLOY			SIZE	A/A4	DWG NO.	114555P	REV.	5		
FINISH: TIN PLATE			-CAD GENERATED DRAWING- DO NOT MANUALLY UPDATE DO NOT SCALE		SCALE	3X	CADFILE	02603	SHEET	1 OF 1

REV.	DESCRIPTION OF CHANGES	APPROVED	DATE
5	ECN 2015-0010	CPD	08/12/2016
4	ECRN 14270 - ADD INSP. DIMENSIONS	AMS	05/22/08
3	ECRN 14212 - UPDATE DIMENSION SCHEME	AMS	01/21/08
2	ECRN 14191 - ADD -P14 TO TABLE	AMS	10/04/07
1	- ADD -P11 THRU -P13 TO TABLE	LH	02/27/07