



- **Robust and compact design**
- **Fast response time**
- **Wide environmental temperature range**

The ETP-AM-SP-ASL-PT temperature probe provides a measurement solution where heat, dust and moisture are prevalent and where a compact and robust high-reliability design is required. This sensor is particularly suitable for demanding temperature monitoring

applications on vehicles, especially in the motorsports industry. With its fast response time and wide environmental temperature range, it is equally well-equipped for measurement of liquids and gases used in test machinery and industrial instrumentation.

Specifications

Element:	PT100B	PT1000A
Accuracy:	$\pm (0.3 \text{ K} + 0,005 \times t)$	$\pm (0.15 \text{ K} + 0,002 \times t)$
Working temperature:	-55°...+170 °C, short term 230 °C	
Environmental temperature:	-55°...+170 °C	
Sealing:	IP67	
Response time in still water t90:	7 s	
Recommended applied current (self heating must be considered)	1 mA at 100 Ω 0.3 mA at 1000 Ω	
Housing:	316 stainless steel	
Connector	ASL-106-05PN-HE	
recommended Mating Connector	ASL-606-05SN-HE	
Weight:	16 g	

Dimensions and Wiring

Connector wiring:
Pin 1 - Sensor leg 1
Pin 2 - Sensor leg 1 LINK
Pin 3 - Sensor leg 2 LINK
Pin 4 - Sensor leg 2
Pin 5 - No connect

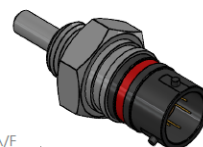
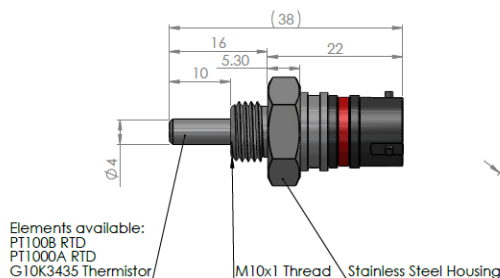

Ordering information

Ordering Code: 94805-ETP-AM-SP-ASL-PT100A
94807-ETP-AM-SP-ASL-PT1000A

Ordering Code mating connector: 20875 - ASL606-05SN-HE