

# Illuminated pushbutton

K14-131.111061

Distribution by  
DigiKey

**DigiKey**



<https://digikey.eao.com/p/K14-131.111061>

Your product:

---



## K14-131.111061 Illuminated pushbutton

### **MOUNTING**

**Mounting cut-out:** Ø 22.3 mm

### **OPERATING-/INDICATION PART**

**Lens illumination:** illuminative

**Lens colour:** Blue

**Lens optics:** transparent

**Lens shape:** flush

**Illumination colour:** Blue

**Lens material:** Plastic

### **ELECTRICAL CHARACTERISTICS**

<b>Switching voltage and switching current:</b>	250 VAC, 5 A (ohmic) 250 VAC, 2 A (inductive, $\cos(\phi) = 0.7$ ) 220 VDC, 0.1 A (inductive, L:R = 30 ms) 110 VDC, 0.2 A (inductive, L:R = 30 ms) 60 VDC, 0.7 A (inductive, L:R = 30 ms) 24 VDC, 2 A (inductive, L:R = 30 ms)
<b>Standards:</b>	According to EN/IEC 61058-1
<b>Rated Operational Voltage <math>U_e</math>:</b>	250 VAC/DC according to EN IEC 61058-1
<b>Operating voltage:</b>	24 V AC/DC
<b>Operation current:</b>	7/14 mA $\pm 15\%$
<b>Electrical lifetime:</b>	50 000 cycles of operation
<b>Contacts:</b>	1 NC / 1 NO
<b>Electric strength:</b>	3000 VAC, 50 Hz, 1 min. between all terminals and earth, according to EN/IEC 61058-1
<b>Thermal current <math>I_{th}</math>:</b>	5 A

## MECHANICAL CHARACTERISTIC

<b>Wire cross section:</b>	Max. wire cross-section 2 wires with 1 mm Max. wire cross-section of stranded cable 2 of 0.75 mm <sup>2</sup> or 1 x 1.0 mm <sup>2</sup>
<b>Operating force:</b>	3 N ... 6 N
<b>Contact material:</b>	Gold-plated silver
<b>Switching system:</b>	Self-cleaning, double-break snap action switching system (contact opening width 2 mm x 1.5 mm).
<b>Terminal:</b>	Plug-in terminal, 2.8 x 0.5 mm
<b>Mechanical lifetime:</b>	2 Mio. cycles of operation
<b>Switching action:</b>	Momentary
<b>Operating Travel:</b>	3 mm
<b>Switching system:</b>	Snap-action switching element
<b>Tightening torque:</b>	Fixing nut max. 0.25 Nm
<b>Weight:</b>	0.021 kg

## AMBIENT CONDITION

<b>Climate resistance:</b>	Standard condition, as per DIN EN 60068-2-78 Standard cyclic, as per DIN IEC 60068-2-30
<b>Operating temperature:</b>	- 25 °C ... + 55 °C, mounted as a block, make sure the heat can escape freely
<b>Shock resistance:</b>	Max. 150 m / s <sup>2</sup> , pulse width 11 ms, 3-axis, (semi-sinusoidal as per EN IEC 60068-2-27)

**Storage temperature:** - 40 °C ... + 85 °C

**Vibration resistance:** Max. 100 m / s<sup>2</sup> from 10 Hz ... 500 Hz, (sinusoidal EN IEC 60068-2-6)

**IP front protection:** IP67, according to DIN EN 60529

**CERTIFICATE**

**Approbations:** CB (IEC 61058-1), CQC, CSA, DNV, ENEC (EN 61058-1), UL

**Conformities:** CE, UKCA, 2011 / 65 / EC (RoHS), 2014 / 35 / EU (LVD)

**OTHER**

**Housing material:** Plastic

**Housing colour:** Black

**Short Description:** Illuminated pushbutton, Momentary, 250 V AC @ 5 A, 24 V AC/DC, 1 NC / 1 NO, Plug-in terminal, 2.8 x 0.5 mm, Blue, Blue

**Wiring diagrams:**

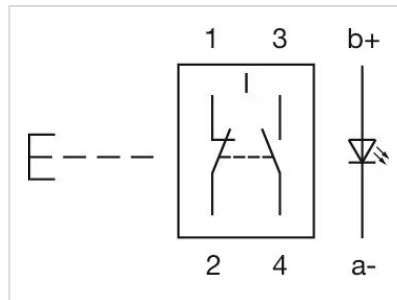

**Mounting cut-outs:**

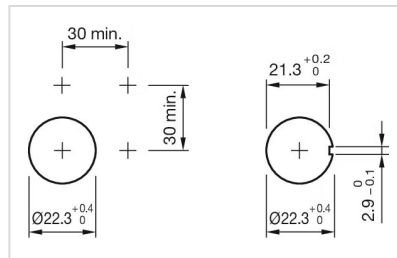

**Dimension drawings:**

