

03

SGV ... C

Circular connectors with threaded joint M16 acc. to IEC 61076-2-106, IP40/IP68



Chassis plug acc. to IEC 61076-2-106, IP40, with threaded joint, empty housing for reception of crimp contacts, for back side mounting

03

SGV ... C

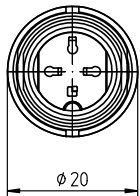
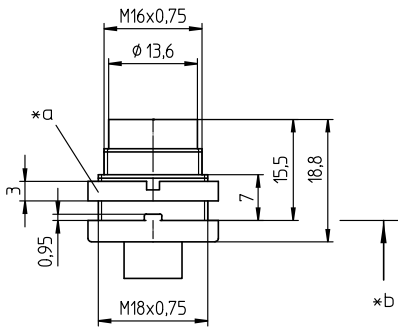
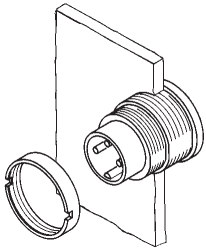

*c

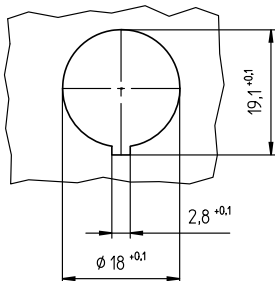

Environmental conditions

Temperature range -40 °C/+85 °C

Materials

Insulating body PA GF, V-0 according to UL94
Housing Zn diecast, pre-copper and nickel-plated
Ring screw CuZn, nickel-plated

Mechanical data

Tightening torque connector 1-3 Nm
Tightening torque nut 1-3 Nm
Protection class IP40¹

¹ according to IEC DIN EN 60529, only in locked condition with an appropriate counterpart

Electrical data (at T_{amb} 20 °C)

Rated current 5 A
Rated voltage with pollution degree 1:
300 V (versions 30, 40, 50/6, 60, 70)
100 V (versions 50, 71, 81)
with pollution degree 2:
250 V (versions 30, 40)
32 V (versions 50, 71, 81)
160 V (versions 50/6, 60, 70)
Rated impulse voltage 1500 V (versions 30, 40, 50/6, 60, 70)
500 V (versions 50, 71, 81)
Material group II (IEC)/I (UL) (400 ≤ CTI < 600)
Overvoltage category I
Insulation resistance > 100 MΩ

Associated products

Counterparts
☞ KV ☞ KV ... C ☞ KV ...-8
☞ WKV ☞ WKV ... C

Accessories
☞ 0369 ☞ 0383 ☞ 038399
☞ 0384 ☞ 0385 ☞ 038899

Harnessing equipment
☞ ZMS 20

03

SGV ... C

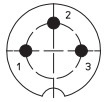

03-a
SGV 30 C

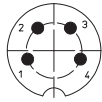

04-a
SGV 40 C

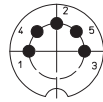

05-b
SGV 50 C

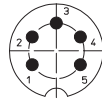

05-a
SGV 50/6 C

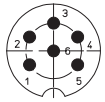

06-a
SGV 60 C

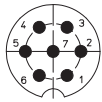

07-a
SGV 70 C

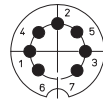

07-b
SGV 71 C

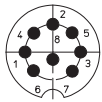

08-a
SGV 81 C

- *a nut enclosed separately
- *b mounting direction
- *c port in mounting plate

03

SGV ... C

Designation	Pole Number	PU (Pieces)	MDQ (Pieces)
SGV 30 C	3	50	100
SGV 40 C	4	50	100
SGV 50 C	5	50	100
SGV 50/6 C	5	50	100
SGV 60 C	6	50	100
SGV 70 C	7	50	100
SGV 71 C	7	50	100
SGV 81 C	8	50	100

Packaging:

in a cardboard box