

P	LTR	DESCRIPTION	DATE	DWN	APVD
	A2	AS PER ECR-23-18551	30AUG2023	SSM	WH

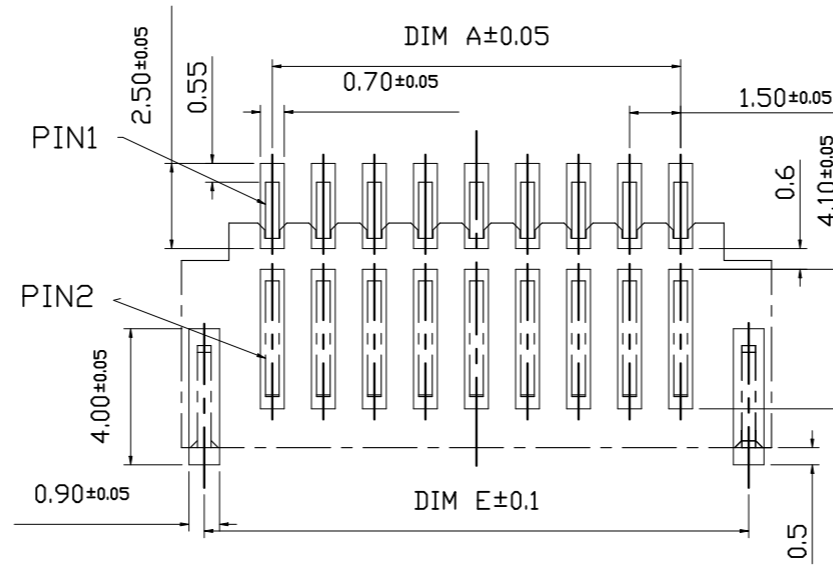
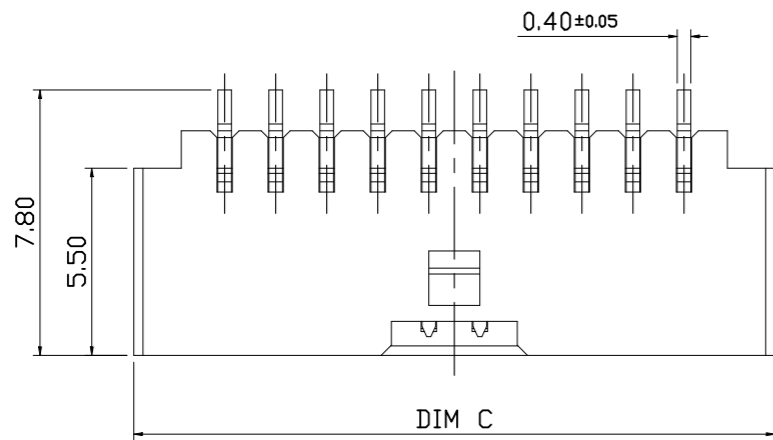

PCB PATTERN LAYOUT
GENERAL TOLERANCE ±0.05

NOTES:

- MATERIAL:
 - 1.1 HOUSING: THERMOPLASTIC, HIGH TEMP., UL94V-0. COLOR: SEE PART NUMBER
 - 1.2 CONTACT: Boway ALLOY.
 - 1.3 FITTING NAIL: STAINLESS STEEL
- FINISH:
 - 2.1 CONTACT:
 - 50u" MIN NICKEL UNDERPLATING OVERALL.
 - TYPE 1: 100u" MIN MATT TIN PLATING OVERALL
 - TYPE 2: GOLD FLASH ON CONTACT AND SOLDER
 - 2.2 FITTING NAIL:
 - 50u" MIN NICKEL UNDER PLATING OVERALL
 - 60u" MATT MIN TIN PLATING OVERALL
- REFLOW SOLDER CAPABLE TO 260°C

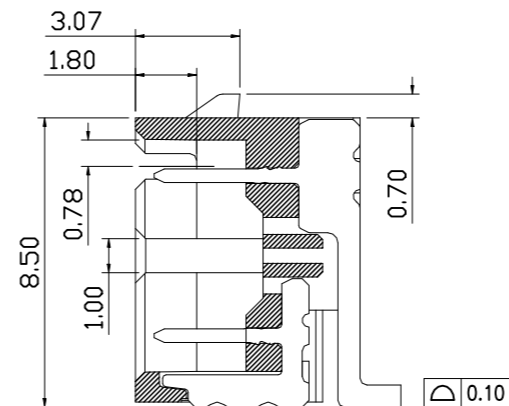
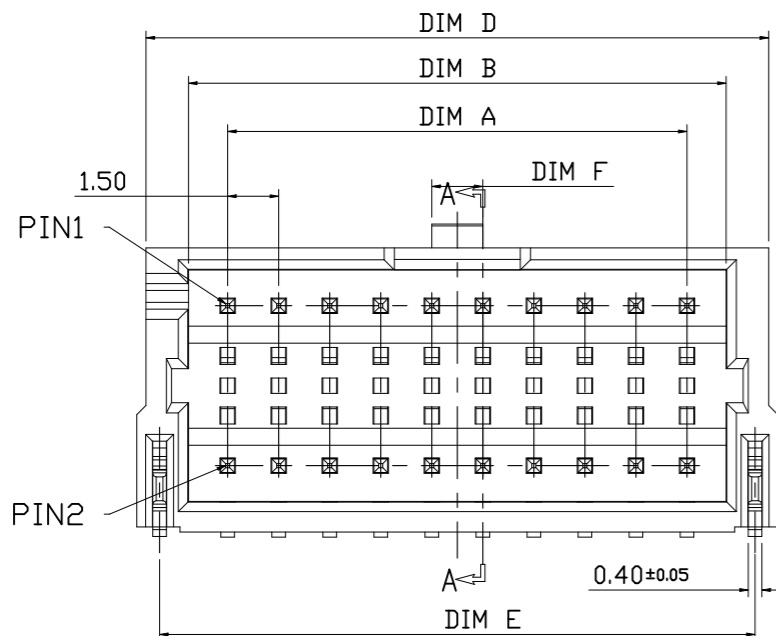
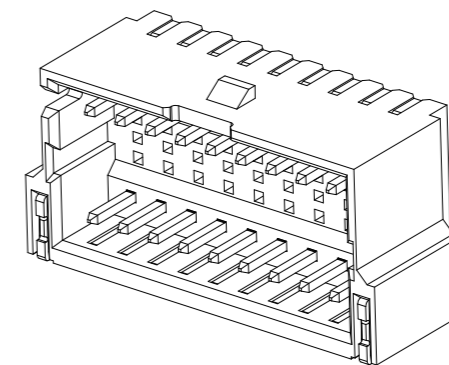

SECTION A-A
SCALE 1:1

COLOR	DIM F	DIM E	DIM D	DIM C	DIM B	DIM A	Pos.No	P/N	
								TYPE 2	TYPE 1
BLACK	3.00	25.00	25.80	26.34	23.30	21.00	30	3-2394521-3	2-2394521-3
	1.50	17.50	18.30	18.84	15.80	13.50	20	3-2394521-2	2-2394521-2
NATURAL		10.00	10.80	11.34	8.30	6.00	10	3-2394521-1	2-2394521-1
	3.00	25.00	25.80	26.34	23.30	21.00	30	1-2394521-3	2394521-3
1.50		17.50	18.30	18.84	15.80	13.50	20	1-2394521-2	2394521-2
	10.00	10.80	11.34	8.30	6.00	10	1-2394521-1	2394521-1	

THIS DRAWING IS A CONTROLLED DOCUMENT.		DWN Tommy Qian 12APR2021	TE Connectivity Ltd.				
DIMENSIONS: mm		CHK Niki Shi 12APR2021					
TOLERANCES UNLESS OTHERWISE SPECIFIED:		APVD Niki Shi 12APR2021	NAME				
0 PLC ± 0.5 1 PLC ± 0.25 2 PLC ± 0.15 3 PLC ± 0.1 4 PLC ± - ANGLES ± 2°		PRODUCT SPEC 108-115188	1.5mm PITCH WTB Conn. SMT R/A TYPE DOUBLE ROW				
MATERIAL		APPLICATION SPEC	SIZE	CAGE CODE	DRAWING NO	RESTRICTED TO	
NOTE 1		FINISH	WEIGHT	A3	00779	C-2394521	
NOTE 2		FINISH	CUSTOMER DRAWING		SCALE	SHEET	REV
					N/A	1 OF 7	A2

P	LTR	DESCRIPTION	DATE	DWN	APVD
-	-	SEE SHEET 1	-	-	-

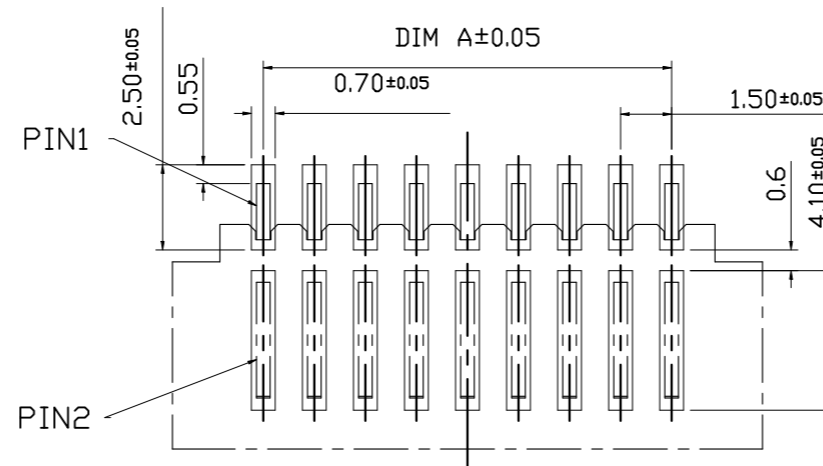
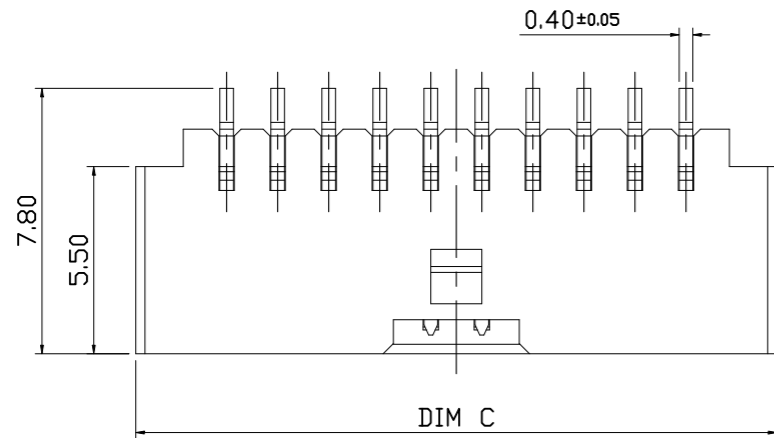

PCB PATTERN LAYOUT
GENERAL TOLERANCE ±0.05

NOTES:

- MATERIAL:
 - HOUSING: THERMOPLASTIC, HIGH TEMP., UL94V-0. COLOR: SEE PART NUMBER
 - CONTACT: COPPER ALLOY BRASS.
- FINISH:
 - CONTACT:
 - 50u" MIN NICKEL UNDERPLATING OVERALL.
 - TYPE 1: 100u" MIN MATT TIN PLATING OVERALL
 - TYPE 2: GOLD FLASH ON CONTACT AND SOLDER
- REFLOW SOLDER CAPABLE TO 260°C

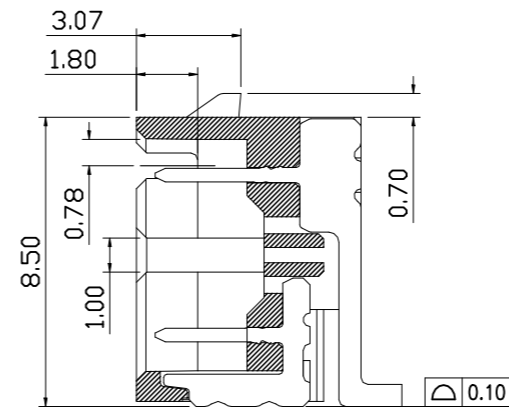
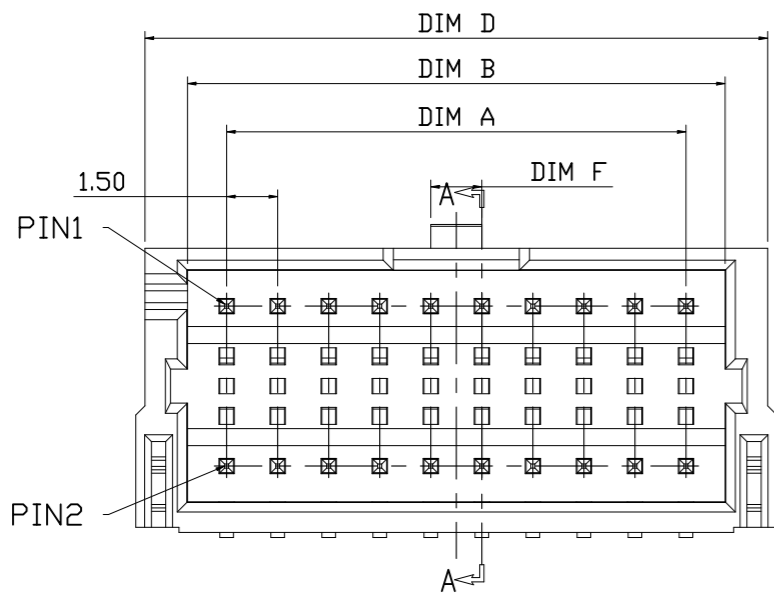

SECTION A-A
SCALE 1:1

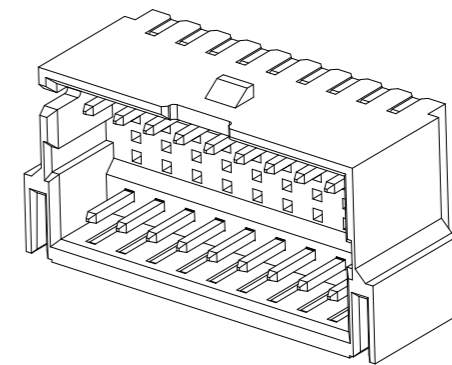

COLOR	DIM F	DIM E	DIM D	DIM C	DIM B	DIM A	Pos.No	TYPE 2	TYPE 1
BLACK	3.00	25.00	25.80	26.34	23.30	21.00	30	7-2394521-3	6-2394521-3
	1.50	17.50	18.30	18.84	15.80	13.50	20	7-2394521-2	6-2394521-2
NATURAL	3.00	25.00	25.80	26.34	23.30	21.00	30	5-2394521-3	4-2394521-3
	1.50	17.50	18.30	18.84	15.80	13.50	20	5-2394521-2	4-2394521-2
							10	5-2394521-1	4-2394521-1

THIS DRAWING IS A CONTROLLED DOCUMENT.		DWN Tommy Qian 12APR2021	TE Connectivity Ltd.		
DIMENSIONS: mm		CHK Niki Shi 12APR2021			
TOLERANCES UNLESS OTHERWISE SPECIFIED:		APVD Niki Shi 12APR2021	NAME		
0 PLC ± 0.5		PRODUCT SPEC	1.5mm PITCH WTB Conn. SMT R/A TYPE DOUBLE ROW		
1 PLC ± 0.25		APPLICATION SPEC	-		
2 PLC ± 0.15		WEIGHT N/A	SIZE A3	CAGE CODE 00779	DRAWING NO C-2394521
3 PLC ± 0.1		NOTE 1	RESTRICTED TO		
4 PLC ± -		NOTE 2	-		
ANGLES ± 2°		CUSTOMER DRAWING	SCALE N/A	SHEET 2 OF 7	REV A2

P	LTR	DESCRIPTION	DATE	DWN	APVD
-	-	SEE SHEET 1	-	-	-

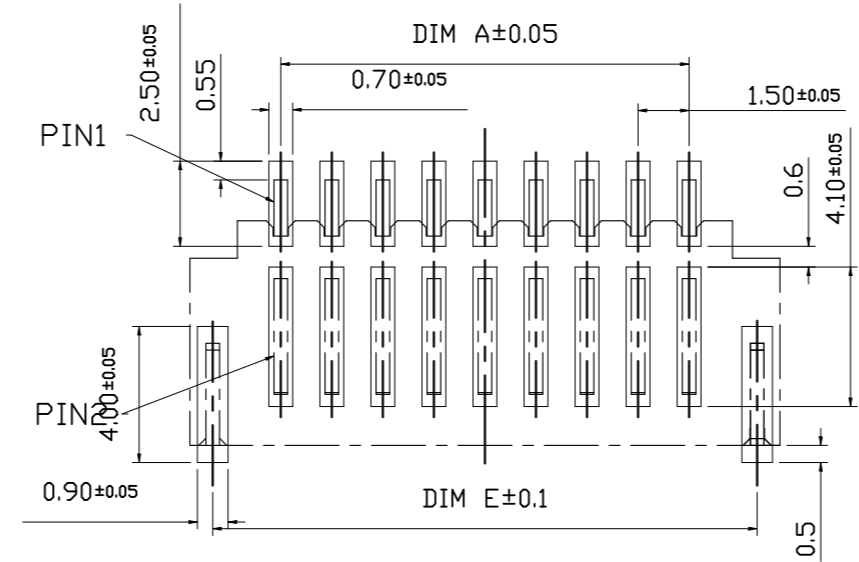
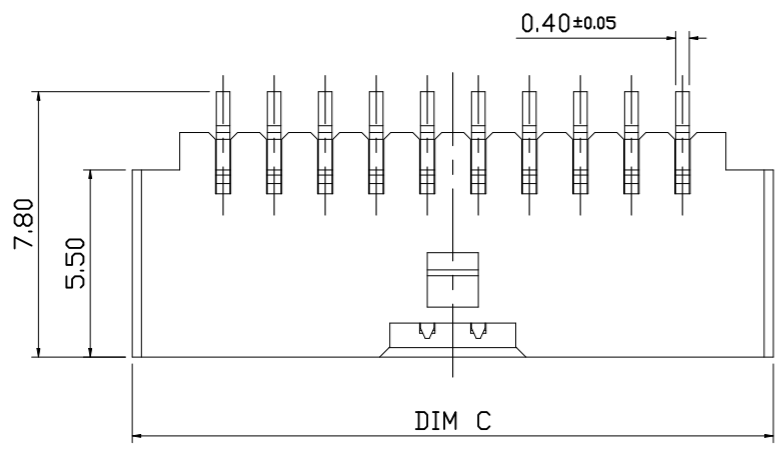

PCB PATTERN LAYOUT
GENERAL TOLERANCE ±0.05

- NOTES:
- MATERIAL:
 - HOUSING: THERMOPLASTIC, HIGH TEMP.,UL94V-0. COLOR:SEE PART NUMBER
 - CONTACT: Boway ALLOY .
 - FITTING NAIL: STAINLESS STEEL
 - FINISH:
 - CONTACT:
 - 50u" MIN NICKEL UNDERPLATING OVERALL.
 - TYPE 1: 100u" MIN MATT TIN PLATING OVERALL
 - TYPE 2: GOLD FLASH ON CONTACT AND SOLDER
 - FITTING NAIL:
 - 50u" MIN NICKEL UNDER PLATING OVERALL
 - 100u" MATT MIN TIN PLATING OVERALL
 - REFLOW SOLDER CAPABLE TO 260°C

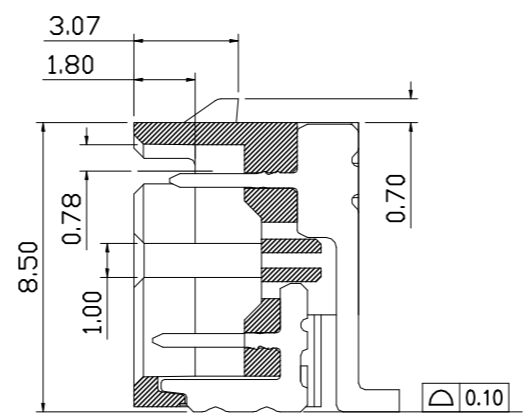
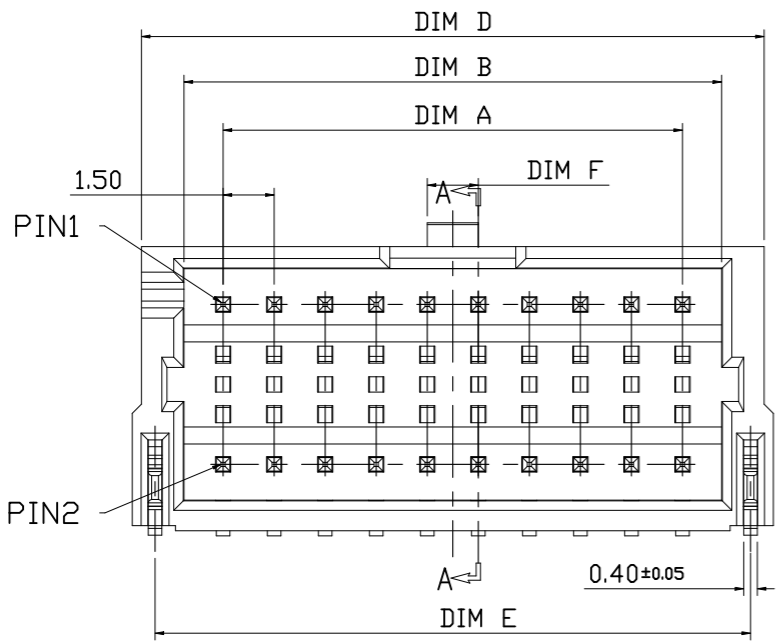

SECTION A-A
SCALE 1:1

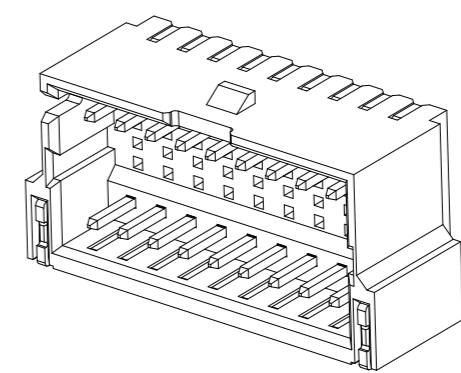

COLOR	DIM F	DIM E	DIM D	DIM C	DIM B	DIM A	Pos.No	TYPE 2	TYPE 1
BLACK	3.00	32.50	33.30	33.84	30.80	28.50	40	3-2394521-4	2-2394521-4
NATURAL	3.00	32.50	33.30	33.84	30.80	28.50	40	1-2394521-4	2394521-4

THIS DRAWING IS A CONTROLLED DOCUMENT.		DWN Tommy Qian 12APR2021		TE Connectivity Ltd.	
DIMENSIONS: mm		CHK Niki Shi 12APR2021			
TOLERANCES UNLESS OTHERWISE SPECIFIED:		APVD Niki Shi 12APR2021		NAME	
0 PLC ± 0.5 1 PLC ± 0.25 2 PLC ± 0.15 3 PLC ± 0.1 4 PLC ± - ANGLES ± 2°		PRODUCT SPEC		1.5mm PITCH WTB Conn. SMT R/A TYPE DOUBLE ROW	
MATERIAL NOTE 1		FINISH NOTE 2		APPLICATION SPEC	
		WEIGHT N/A		RESTRICTED TO	
		CUSTOMER DRAWING		SCALE N/A SHEET 3 OF 7 REV A2	

P	LTR	DESCRIPTION	DATE	DWN	APVD
-	-	SEE SHEET 1	-	-	-

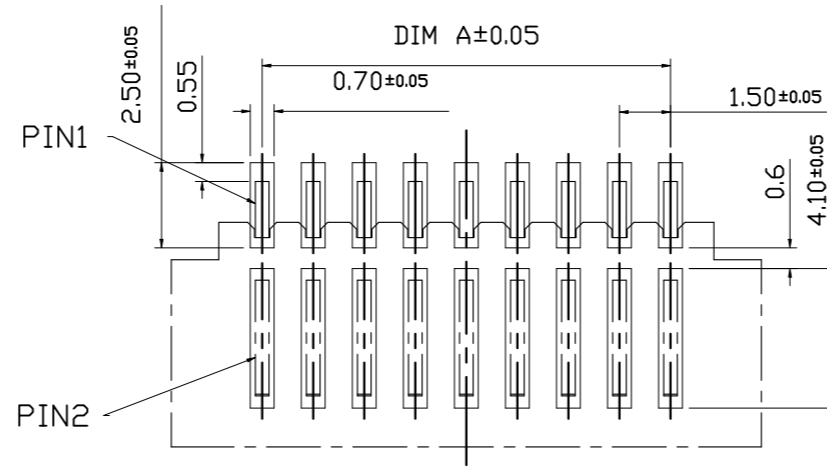
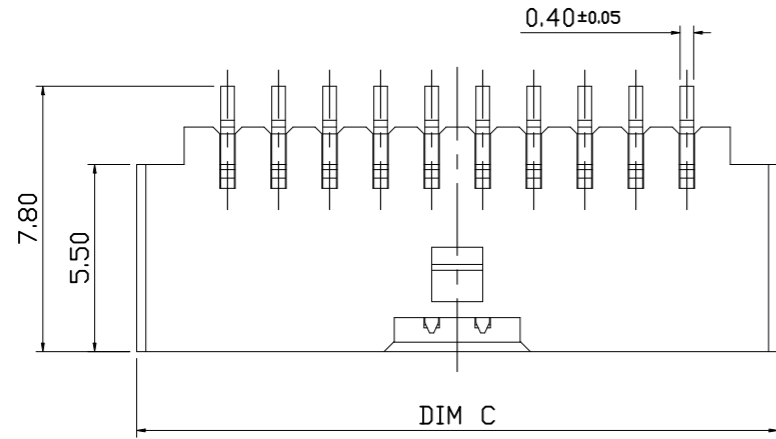

PCB PATTERN LAYOUT
GENERAL TOLERANCE ±0.05

NOTES:

- MATERIAL:
 - HOUSING: THERMOPLASTIC, HIGH TEMP.,UL94V-0. COLOR:SEE PART NUMBER
 - CONTACT: COPPER ALLOY BRASS.
- FINISH:
 - CONTACT: 50u" MIN NICKEL UNDERPLATING OVERALL. TYPE 1: 100u" MIN MATT TIN PLATING OVERALL TYPE 2: GOLD FLASH ON CONTACT AND SOLDER
- REFLOW SOLDER CAPABLE TO 260°C

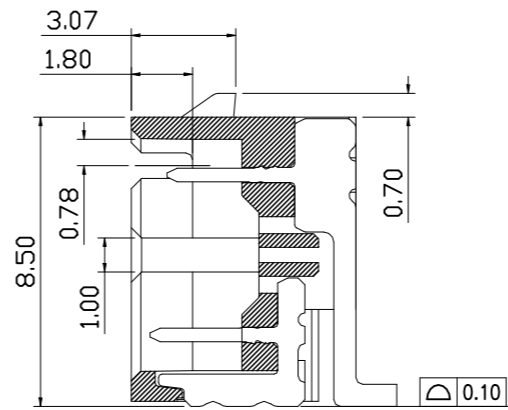
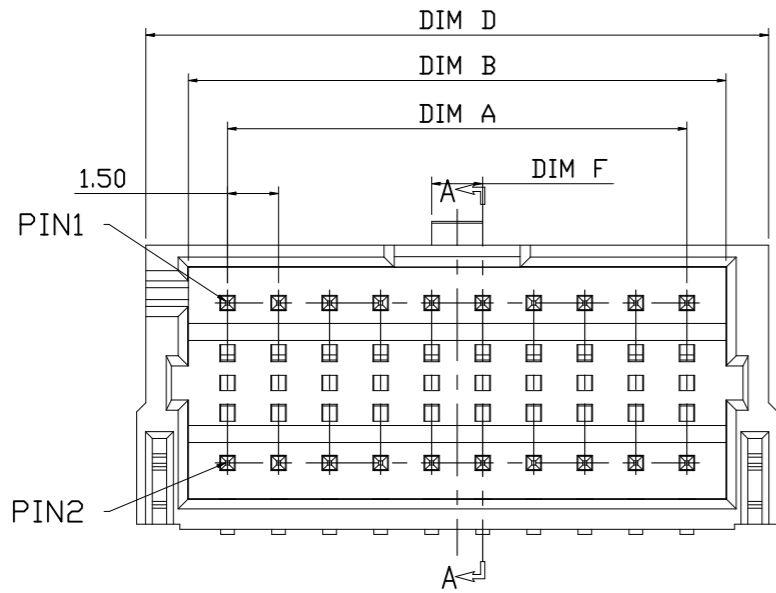

SECTION A-A
SCALE 1:1

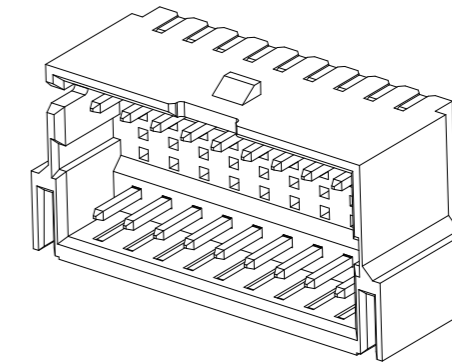

BLACK	3.00	32.50	33.30	33.84	30.80	28.50	40	7-2394521-4	6-2394521-4
NATURAL	3.00	32.50	33.30	33.84	30.80	28.50	40	5-2394521-4	4-2394521-4
COLOR	DIM F	DIM E	DIM D	DIM C	DIM B	DIM A	Pos.No	TYPE 2	TYPE 1
								P/N	

THIS DRAWING IS A CONTROLLED DOCUMENT.		DWN Tommy Qian 12APR2021	TE Connectivity Ltd.			
DIMENSIONS: mm		CHK Niki Shi 12APR2021				
TOLERANCES UNLESS OTHERWISE SPECIFIED:		APVD Niki Shi 12APR2021				
0 PLC ± 0.5 1 PLC ± 0.25 2 PLC ± 0.15 3 PLC ± 0.1 4 PLC ± - ANGLES ± 2°		NAME				
MATERIAL NOTE 1		FINISH NOTE 2	1.5mm PITCH WT B Conn. SMT R/A TYPE DOUBLE ROW			
WEIGHT N/A		CUSTOMER DRAWING	SIZE A3	CAGE CODE 00779	DRAWING NO C-2394521	RESTRICTED TO -
		SCALE N/A	SHEET 4 OF 7	REV A2		

P	LTR	DESCRIPTION	DATE	DWN	APVD
-	-	SEE SHEET 1	-	-	-

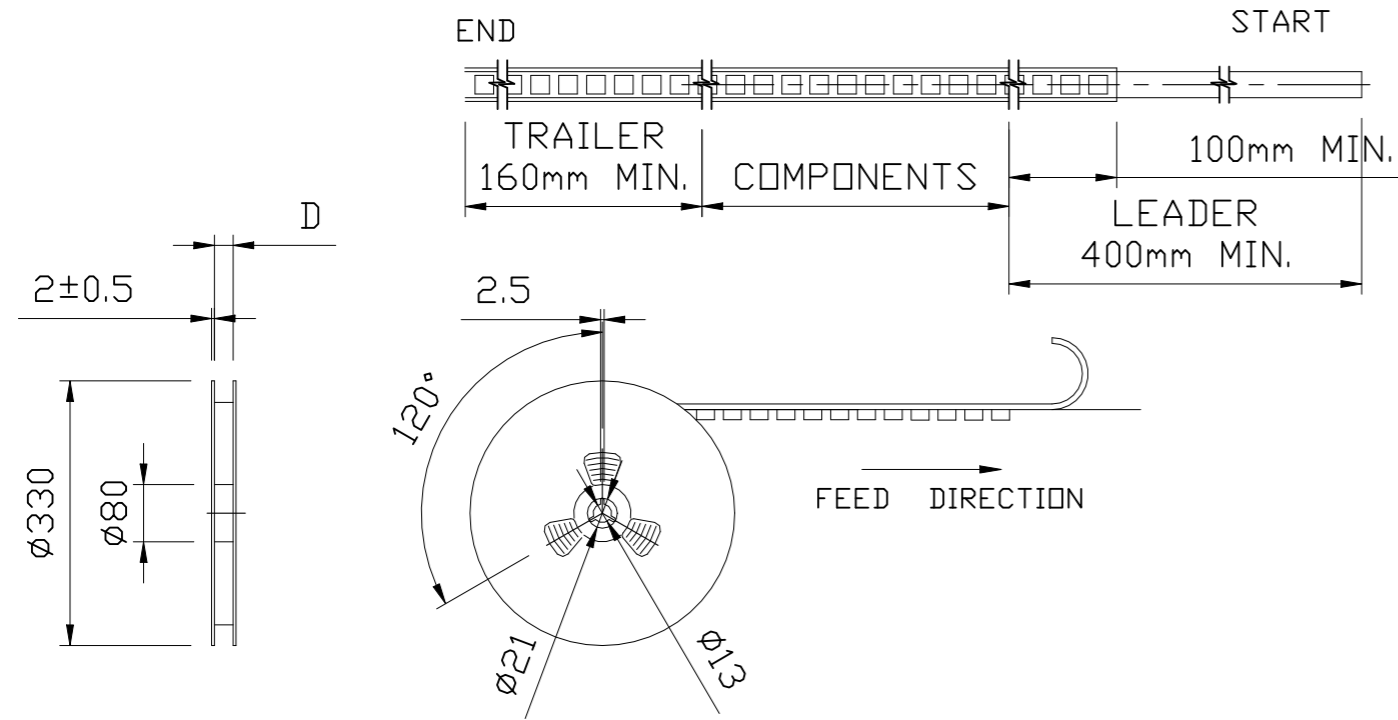

- NOTES:
- 10 SPROCKET HOLE PITCH CUMULATIVE TOLERANCE: ±0.20mm
 - CARRIER CAMBER NOT TO EXCEED 1mm IN 250mm.
 - ALL DIMENSIONS MEET EIA-481 REQUIREMENTS.
 - MATERIAL: BLACK ANTI-STATIC POLYSTYRENE.
 - THICKNESS: 0.50 ± 0.05 mm.
 - PACKING LENGTH PER 13" REEL : 7.5 METERS.
 - COMPONENT LOAD PER 13" REEL : 400 PCS.

24.4	11.65	9.06	6.96	24.00	11.50	10P	*-2394521-1
DIM D	DIM B2	DIM B1	DIM B0	DIM W	DIM F	POS.	PART NUMBER

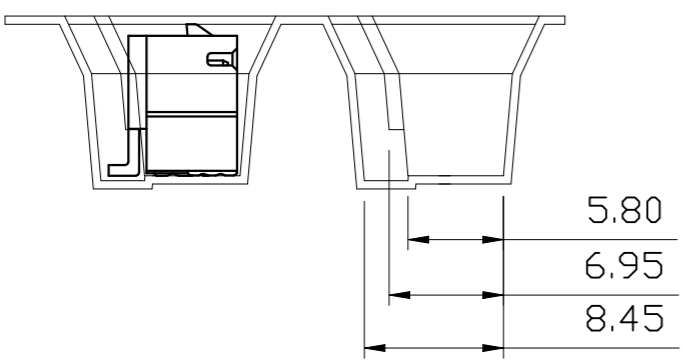
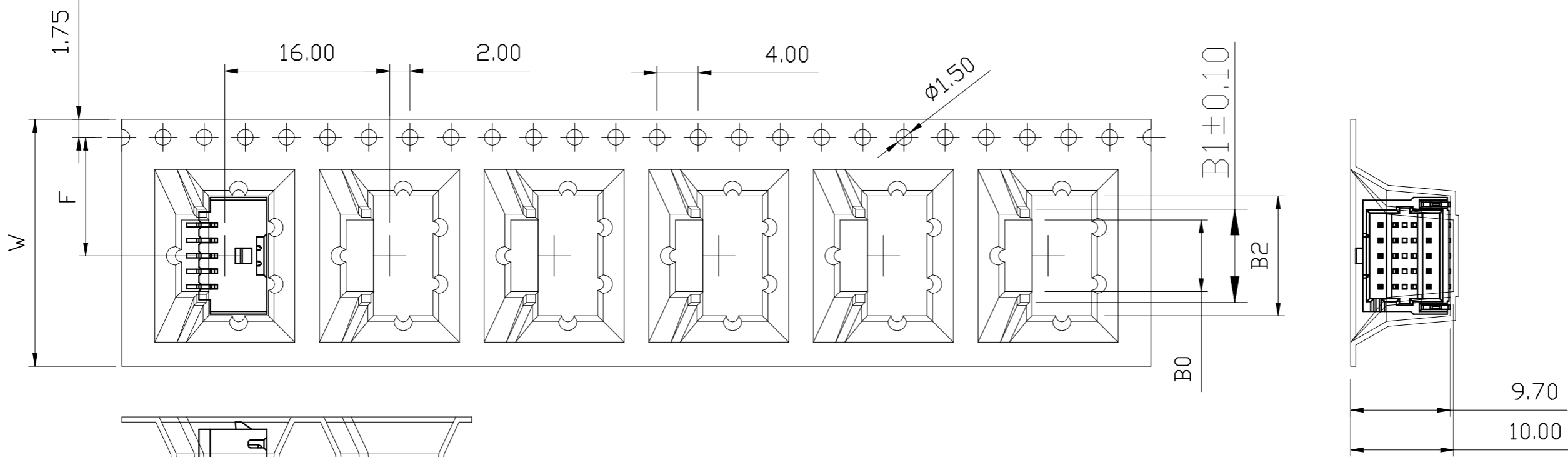

THIS DRAWING IS A CONTROLLED DOCUMENT.

DIMENSIONS:	TOLERANCES UNLESS OTHERWISE SPECIFIED:
mm	
0 PLC	± 0.5
1 PLC	± 0.25
2 PLC	± 0.15
3 PLC	± 0.1
4 PLC	± -
ANGLES	± 2°
MATERIAL	FINISH
-	-

DWN	Tommy Qian	12APR2021
CHK	Niki Shi	12APR2021
APVD	Niki Shi	12APR2021
PRODUCT SPEC	-	
APPLICATION SPEC	-	
WEIGHT	-	
CUSTOMER DRAWING		



1.5mm PITCH WT B Conn.
SMT VERTICAL TYPE DOUBLE ROW

SIZE	CAGE CODE	DRAWING NO	RESTRICTED TO
A3	00779	C-2394521	-
SCALE		SHEET	REV
N/A		5 of 7	A2

P	LTR	DESCRIPTION	DATE	DWN	APVD
-	-	SEE SHEET 1	-	-	-

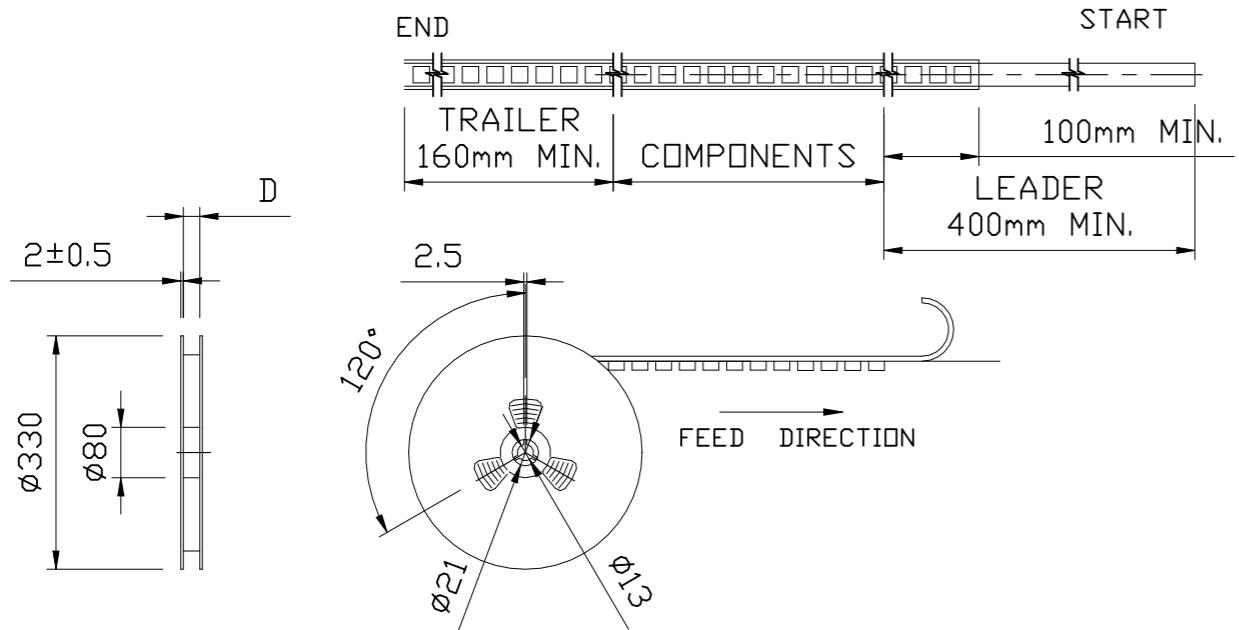

- NOTES:
- 10 SPROCKET HOLE PITCH CUMULATIVE TOLERANCE: ±0.20mm
 - CARRIER CAMBER NOT TO EXCEED 1mm IN 250mm.
 - ALL DIMENSIONS MEET EIA-481 REQUIREMENTS.
 - MATERIAL: BLACK ANTI-STATIC POLYSTYRENE.
 - THICKNESS: 0.50 ± 0.05 mm.
 - PACKING LENGTH PER 13" REEL : 7.5 METERS.
 - COMPONENT LOAD PER 13" REEL : 400 PCS.

34.20	31.61	29.51	56.40	56.00	26.20	40P*-2394521-4
26.71	24.12	22.02	44.40	44.00	20.20	30P*-2394521-3
19.15	16.56	14.46	44.40	44.00	20.20	20P*-2394521-2
DIM B2	DIM B1	DIM B0	DIM D	DIM W	DIM F	POS. PART NUMBER

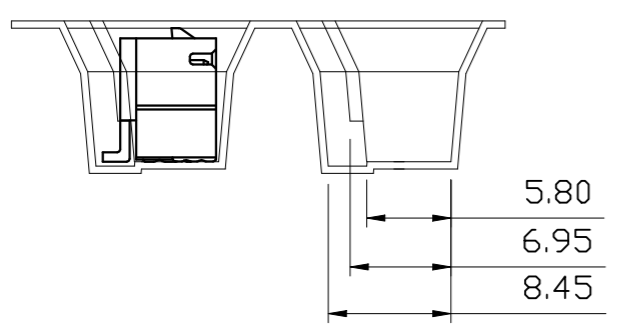
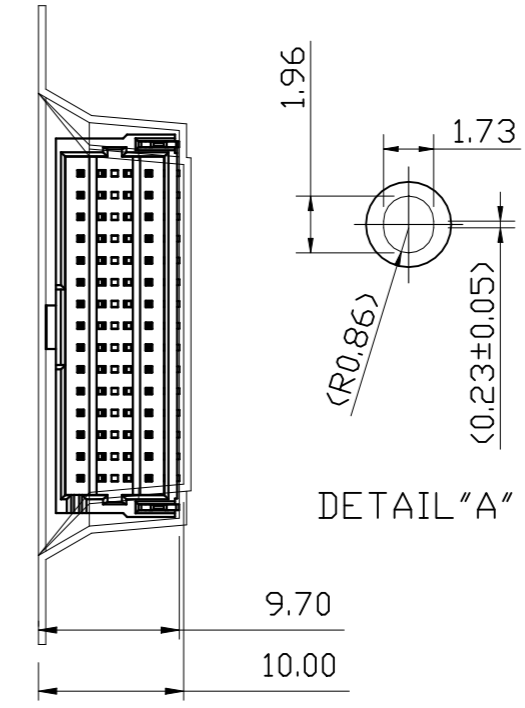
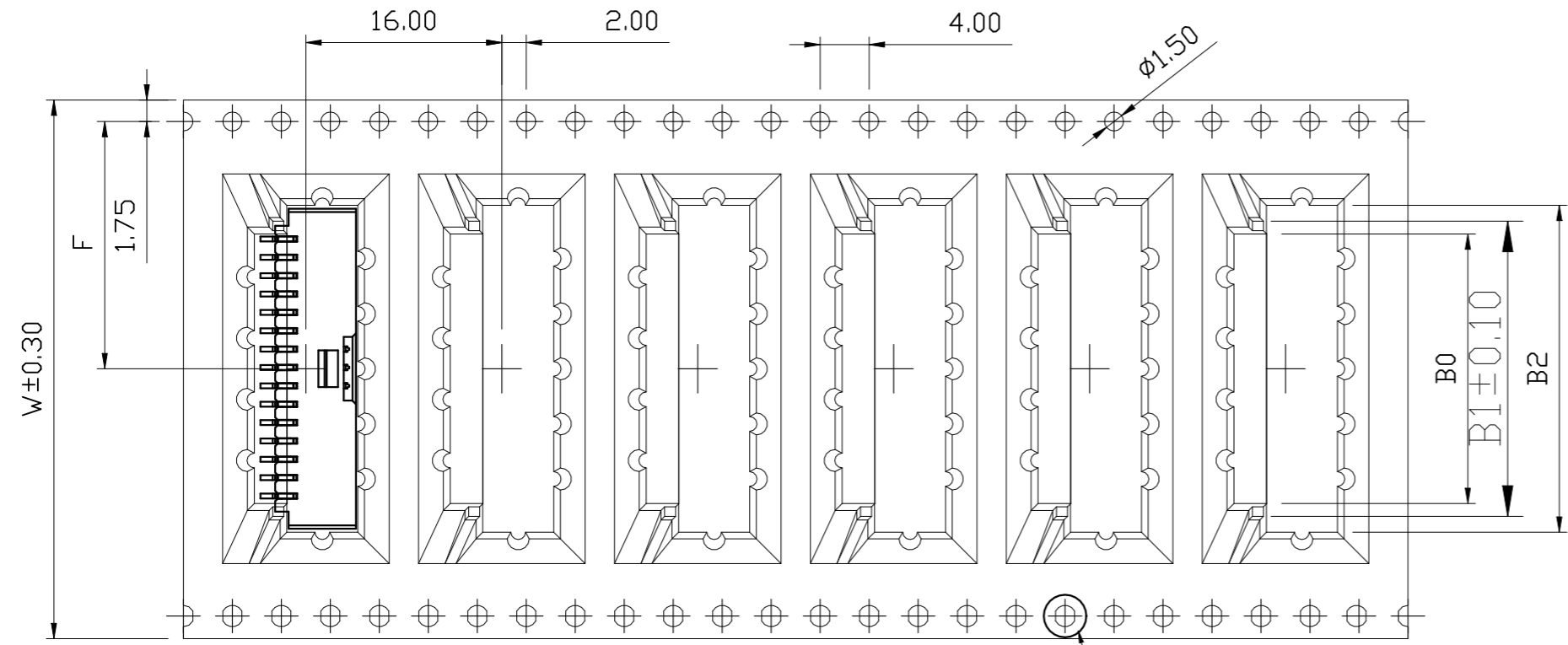

THIS DRAWING IS A CONTROLLED DOCUMENT.

DIMENSIONS:	TOLERANCES UNLESS OTHERWISE SPECIFIED:
mm	
0 PLC	± 0.5
1 PLC	± 0.25
2 PLC	± 0.15
3 PLC	± 0.1
4 PLC	± -
ANGLES	± 2°
MATERIAL	FINISH
-	-

DWN	Tommy Qian	12APR2021
CHK	Niki Shi	12APR2021
APVD	Niki Shi	12APR2021
PRODUCT SPEC	-	
APPLICATION SPEC	-	
WEIGHT	-	



1.5mm PITCH WT B Conn.
SMT VERTICAL TYPE DOUBLE ROW

SIZE	CAGE CODE	DRAWING NO	RESTRICTED TO
A3	00779	C-2394521	-
CUSTOMER DRAWING		SCALE	SHEET
		N/A	6 OF 7
		REV	A2

REVISIONS

P	LTR	DESCRIPTION	DATE	DWN	APVD
-	-	SEE SHEET 1	-	-	-

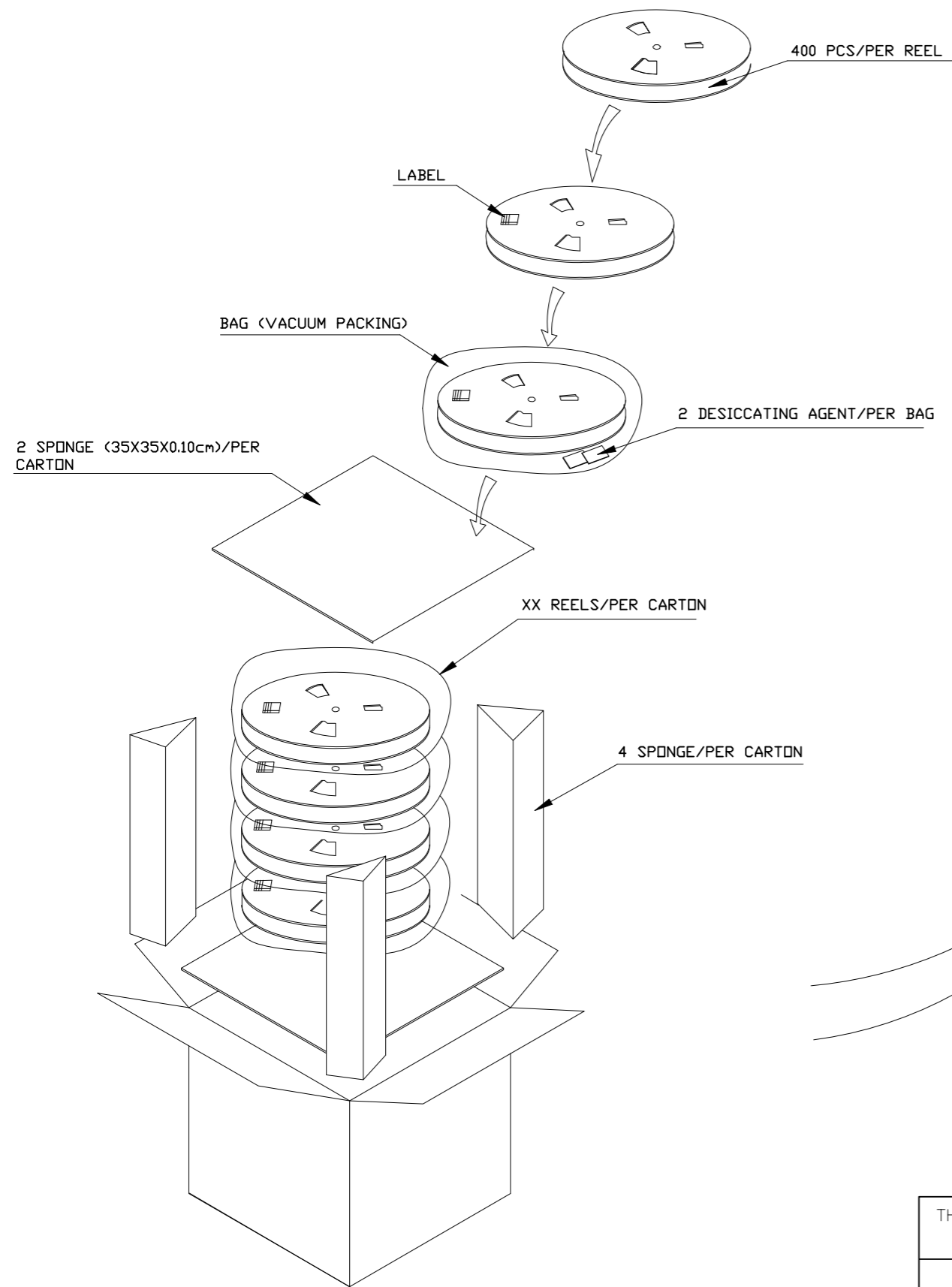

NOTE:

1. STAPLES SHOULD ONLY BE USED TO SET UP CARTON
ALL CARTONS CLOSURES MUST BE DONE WITH TAPE.
2. FILL PACKAGING REEL WITH THE QUANTITIES AS INDICATED

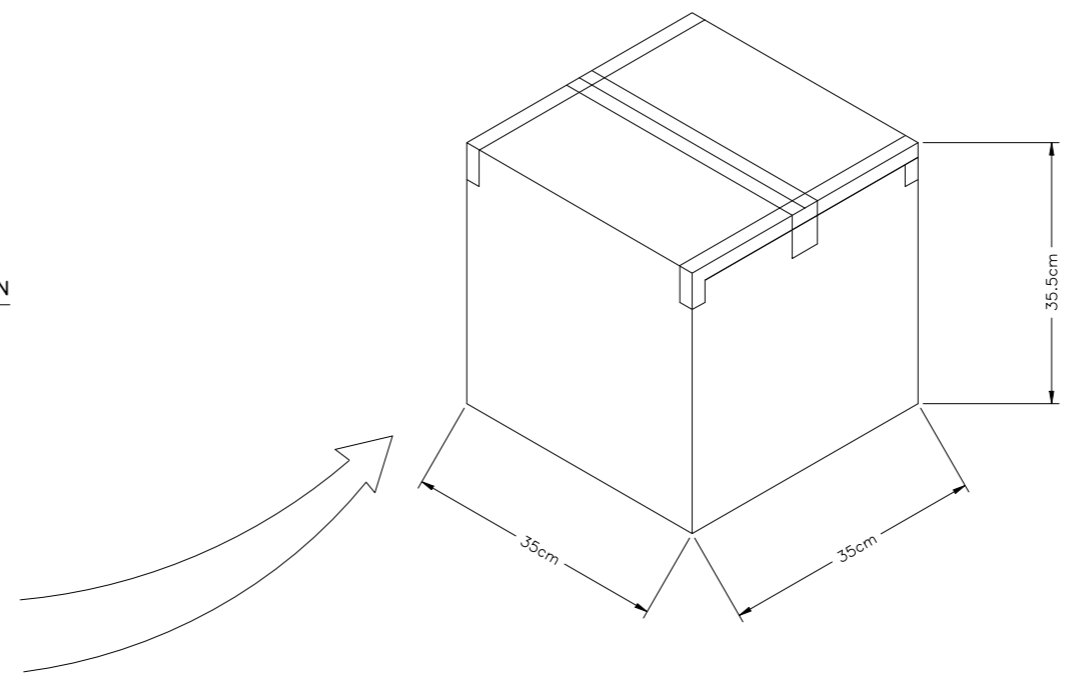

2000(PCS)	400(PCS)	5	40P	*-2394521-4
2800(PCS)	400(PCS)	7	30P	*-2394521-3
2800(PCS)	400(PCS)	7	20P	*-2394521-2
4400(PCS)	400(PCS)	11	10P	*-2394521-1
PARTS PER CARTON	PARTS PER REEL	REELS PER CARTON	POS.	PART NUMBER

THIS DRAWING IS A CONTROLLED DOCUMENT.		DWN Tommy Qian 12APR2021	 TE Connectivity Ltd.														
DIMENSIONS: mm		CHK Niki Shi 12APR2021				NAME											
TOLERANCES UNLESS OTHERWISE SPECIFIED:		APVD Niki Shi 12APR2021	1.5mm PITCH WTB Conn. SMT VERTICAL TYPE DOUBLE ROW														
<table border="1"> <tr> <td>0 PLC</td> <td>± 0.5</td> </tr> <tr> <td>1 PLC</td> <td>± 0.25</td> </tr> <tr> <td>2 PLC</td> <td>± 0.15</td> </tr> <tr> <td>3 PLC</td> <td>± 0.1</td> </tr> <tr> <td>4 PLC</td> <td>± -</td> </tr> <tr> <td>ANGLES</td> <td>± 2°</td> </tr> </table>		0 PLC	± 0.5	1 PLC	± 0.25	2 PLC	± 0.15	3 PLC	± 0.1	4 PLC	± -	ANGLES	± 2°	PRODUCT SPEC -	APPLICATION SPEC -		
0 PLC	± 0.5																
1 PLC	± 0.25																
2 PLC	± 0.15																
3 PLC	± 0.1																
4 PLC	± -																
ANGLES	± 2°																
MATERIAL -		FINISH -	SIZE A3	CAGE CODE 00779	DRAWING NO C-2394521												
		WEIGHT N/A	RESTRICTED TO -														
CUSTOMER DRAWING			SCALE N/A	SHEET 7 OF 7	REV A2												