

REVISIONS					
REV	ECO	DESCRIPTION	DATE	BY	APPR
A1	--	RELEASE NEW PRODUCT	03DEC19	ROOKIE	TOMMY

2X Ø3.10±0.1 2X11.18 DP
 RECOMMENDED SCREW: 6-19 [M3.63 X 1.34]
 THREAD-FORMING SCREW,
 TORQUE: 11-15 IN-LB [1.24-1.70 NM]

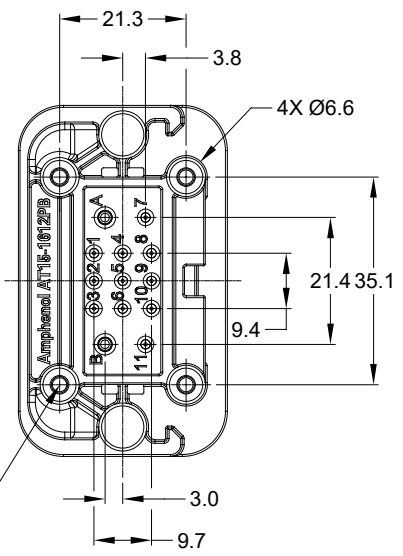

4X Ø2.79±0.12X8.0 DP
 RECOMMENDED SCREW: 4-20 [M3.12 X 1.27]
 THREAD-FORMING SCREW,
 TORQUE: 6-10 IN-LB [0.68-1.13 NM]

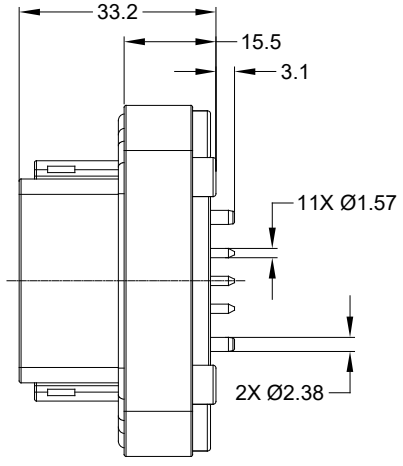
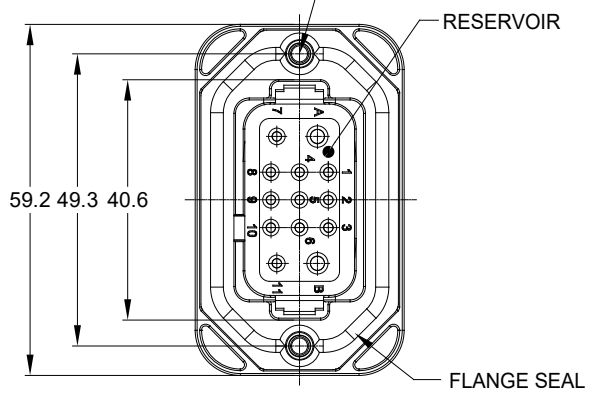
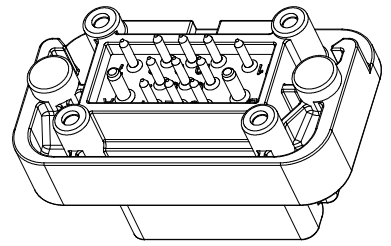

NOTES: UNLESS OTHERWISE SPECIFIED

- MATERIAL:
 HOUSING: THERMOPLASTIC; COLOR: BLACK
 SEAL: SILICONE RUBBER
 CONTACT: COPPER ALLOY
- MODIFICATIONS: FLANGE, PCB MOUNT, STRAIGHT
- SPECIFICATIONS:
 - CURRENT RATING: #12, 25AMPS; #16, 13AMPS
 WHEN USED WITH #12 CROWN CONTACT
 (AT62-210-1231CR OR AT62-210-1231CR-10) IT IS 30 AMPS
 - OPERATING TEMPERATURE: -55°C TO +125°C
 - DIELECTRIC WITHSTANDING VOLTAGE: LESS THAN 2
 MILLIAMPS CURRENT LEAKAGE @ 1500 VOLTS AC.
 - INSULATION RESISTANCE: 1000 MEGOHMS MIN @ 25°C.
 - MOISTURE RESISTANCE: IP67 (MATED CONDITION)
 - MATING CYCLE DURABILITY: 100 CYCLES
 - RoHS COMPLIANT
- MATING PART: AT1612-13SB* PLUG
 (* = MODIFICATIONS)
- ALL DIMENSIONS ARE FOR REFERENCE USE ONLY.

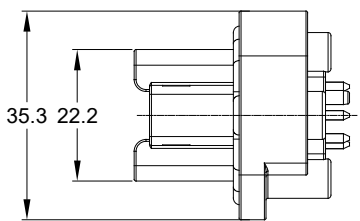

SEE SHEET 2		PART NUMBER		DESCRIPTION		ITEM	
QUANTITY		MATERIALS LIST					
UNLESS OTHERWISE SPECIFIED		SIGNATURES		DATE		Amphenol Sine Systems - www.amphenol-sine.com 44724 Morley Drive Clinton Township, MI 48036 BOARDLOCK PCB MOUNT RECEPTACLE 13 PIN, STRAIGHT, AT SERIES	
1) All dimensions are in metric (mm).		DRAWN: ROOKIE		03DEC19			
2) Tolerances are as follows:		CHECKED: ORION		03DEC19			
1 PL DEC ±0.30 2 PL DEC ±0.15 3 PL DEC ±0.08		APPROVAL: TOMMY		03DEC19			
3) Note reference =		CUSTOMER:					
MATERIAL SPECIFICATIONS:		THIS DRAWING IS SUPPLIED FOR INFORMATION ONLY. DESIGN FEATURES, SPECIFICATIONS AND PERFORMANCE DATA SHOWN HEREON ARE THE PROPERTY OF THE AMPHENOL CORPORATION. NO RIGHTS OF REPRODUCTION ARE IMPLIED. ALL DIMENSIONS ARE SUBJECT TO NORMAL MANUFACTURING VARIATIONS.		SIZE	TYPE	DWG NO.	REVISION
PROCESS SPECIFICATIONS:		NEXT ASSY:		B	C-	AT15-1612PB-BMXX	A1
				SCALE:	NONE	SHEET 1 OF 2	

TITLE: PCB MOUNT RECEPTACLE, 13PIN, STRAIGHT, AT SERIES
 DWG NO: AT15-1612PB-BMXX
 REV: A1
 SH: 1
 OF: 2

REVISIONS					
REV	ECO	DESCRIPTION	DATE	BY	APPR
A1	--	RELEASE NEW PRODUCT	03DEC19	ROOKIE	TOMMY

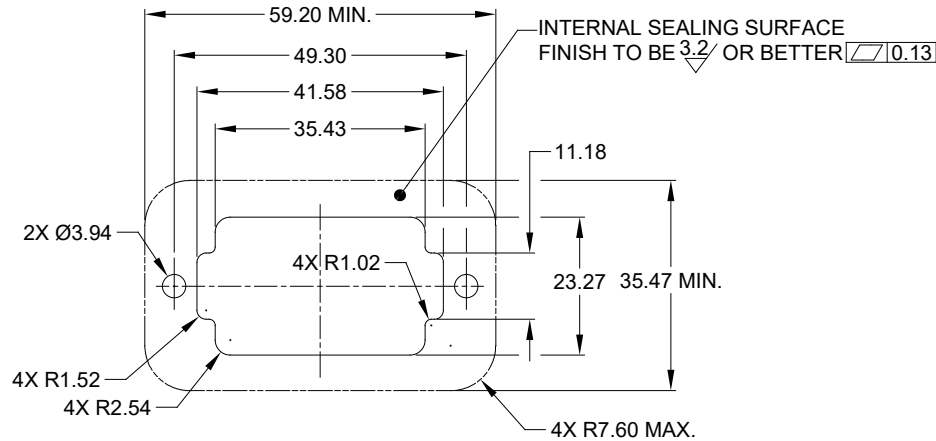

RECOMMENDED PANEL CUTOUT

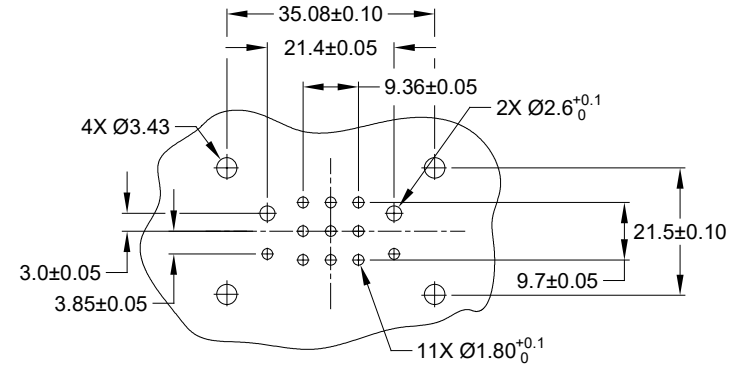

RECOMMENDED PCB LAYOUT

P/N CHART		
CONTACT PLATING	POTTING OR NOT IN RESERVOIR	PART NUMBER
GOLD	NO POTTING	AT15-1612PB-BM01
GOLD	POTTING	AT15-1612PB-BM02
TIN	NO POTTING	AT15-1612PB-BM03
TIN	POTTING	AT15-1612PB-BM04

SEE P/N CHART		PART NUMBER		DESCRIPTION		ITEM
QUANTITY	MATERIALS LIST					
UNLESS OTHERWISE SPECIFIED 1) All dimensions are in metric(mm). 2) Tolerances are as follows: 1 PL DEC ±0.30 Fractions ±1/64 2 PL DEC ±0.15 Angles ±1° 3 PL DEC ±0.08 3) Note reference =		SIGNATURES		DATE		<p style="text-align: center;">Amphenol</p> <p style="text-align: center;">Sine Systems - www.amphenol-sine.com 44724 Morley Drive Clinton Township, MI 48036</p> <p style="text-align: center;">BOARDLOCK PCB MOUNT RECEPTACLE 13 PIN, STRAIGHT, AT SERIES</p>
		DRAWN: ROOKIE	03DEC19	CHECKED: ORION	03DEC19	
		ENGINEER:		APPROVAL: TOMMY	03DEC19	
MATERIAL SPECIFICATIONS:		CUSTOMER:		THIS DRAWING IS SUPPLIED FOR INFORMATION ONLY. DESIGN FEATURES, SPECIFICATIONS AND PERFORMANCE DATA SHOWN HEREON ARE THE PROPERTY OF THE AMPHENOL CORPORATION. NO RIGHTS OF REPRODUCTION ARE IMPLIED. ALL DIMENSIONS ARE SUBJECT TO NORMAL MANUFACTURING VARIATIONS.		
PROCESS SPECIFICATIONS:		CUSTOMER:		SIZE: B C-	TYPE: AT15-1612PB-BMXX	REVISION: A1
NEXT ASSY:		CUSTOMER:		SCALE: NONE	SHEET 2 OF 2	

TITLE: PCB MOUNT RECEPTACLE, 13PIN STRAIGHT, AT SERIES
DWG NO: AT15-1612PB-BMXX
REV/A1
SH: 2
OF: 2