

SPECIFICATIONS:

MATERIALS:

HOUSING:	PA66, UL94 V-0, BLACK
CONTACTS:	GOLD FLASH PLATED BRASS
MAIN BODY:	NICKEL PLATED ZINC ALLOY
LOCK SHELL:	NICKEL PLATED BRASS
SPRING:	STAINLESS STEEL
ISOLATION:	PVC
CLAMPS BODY:	NICKEL PLATED ZINC ALLOY
CLAMPS:	NICKEL PLATED ZINC ALLOY
SCREW:	NICKEL PLATED SPCC
BACK BODY:	NICKEL PLATED BRASS
GLAND CAGE:	POM, WHITE
GLAND NUT:	SATIN NICKEL PLATED AL
GLAND:	SILICONE
ORING:	SILICONE

ELECTRICAL:

RATED CURRENT:	7A (3,4,5A,5B) // 5A (6,7A,7B,8)
RATED VOLTAGE:	250V
INSULATION RESISTANCE:	100 MOhms MIN.
CONTACT RESISTANCE:	10 mOhms MAX.

ENVIRONMENT:

OPERATING TEMPERATURE:	-40°C TO +85°C
WATER PROOF:	IP67 (IN MATED CONDITION)

MAX WIRE AWG: 18 AWG

TORQUE: 0.7Nm to 1.5Nm

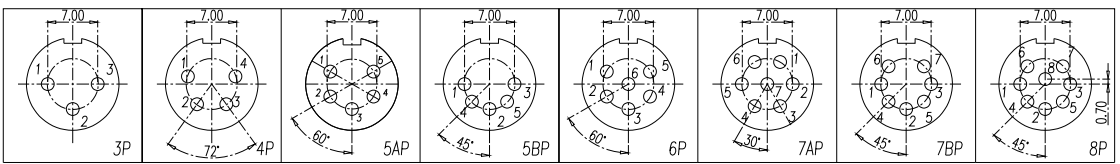
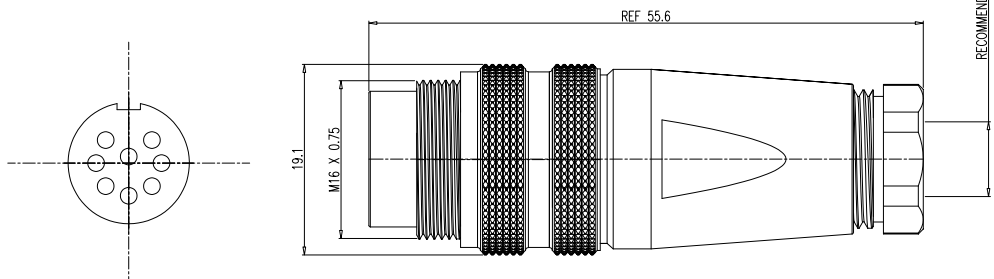
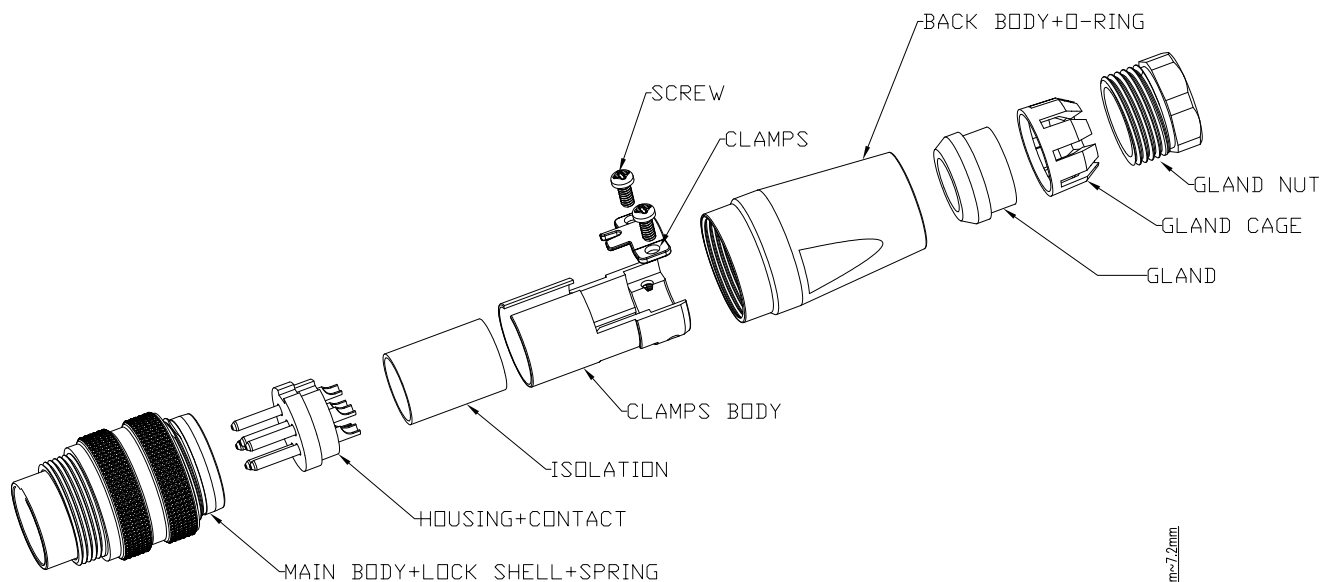

POSITION CHART (MATING SIDE SHOWN)

878-YYY-103RKT1

- POSITIONS (SEE POSITION CHART)
- 003 = 3 POSITION
 - 004 = 4 POSITION
 - 05A = 5(A) POSITION
 - 05B = 5(B) POSITION
 - 006 = 6 POSITION
 - 07A = 7(A) POSITION
 - 07B = 7(B) POSITION
 - 008 = 8 POSITION

RoHS COMPLIANT

UNITS = mm

DO NOT SCALE FROM DRAWING



THESE DRAWINGS AND SPECIFICATIONS ARE THE PROPERTY OF NorComp AND SHALL NOT BE REPRODUCED, COPIED OR USED AS THE BASIS FOR THE MANUFACTURE OR SALE OF APPARATUS WITHOUT WRITTEN PERMISSION.

DRAWN:
J. KADEL
DATE:
09/05/2023

NorComp

SCALE: NTS	SHEET 1	OF 2	REV 1
DWG NO. 878-YYY-103RKT1			

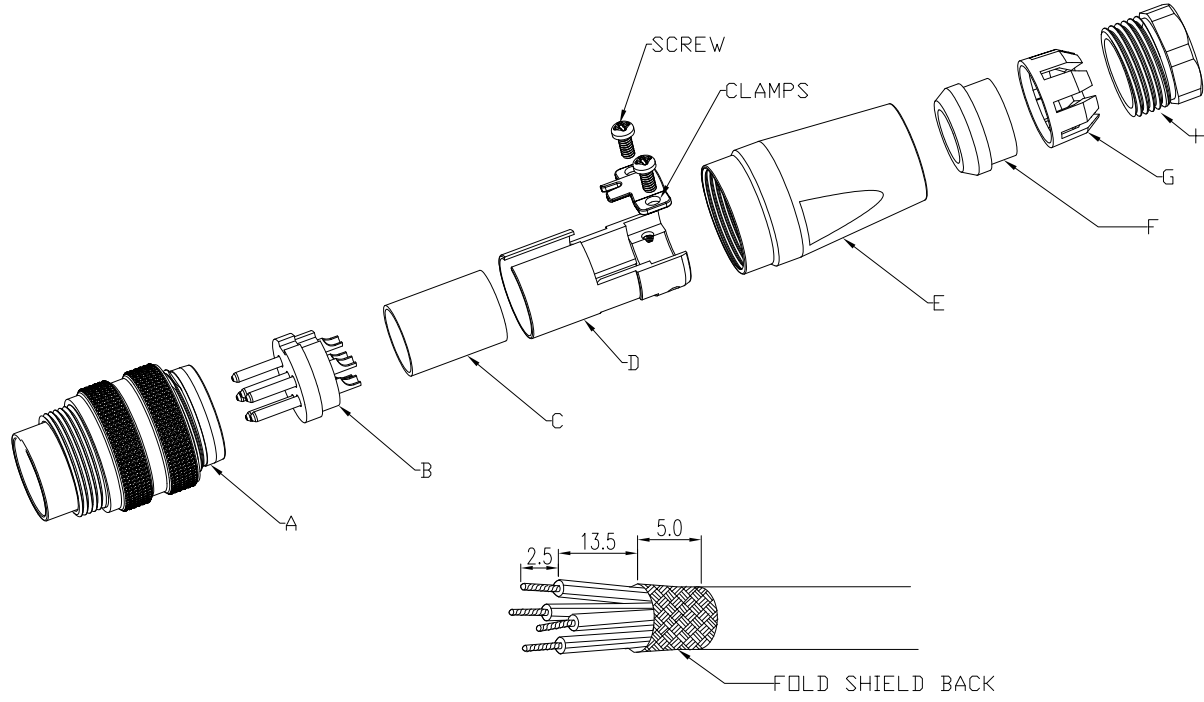

ASSEMBLY INSTRUCTIONS

1. Note assembly position & orientation.
2. Strip the cable according to cable diagram above.
3. Slide the stripped cable through all components in reverse order H-C.
4. Solder the conductors to the contacts on housing and contacts, component B .
5. Once soldering is complete, assemble (collapse) components B, C, D and use screw and clamps to secure cable to component D. Ensure cable shield is clamped by screw and clamps.
6. Continue assembly by inserting component B, C, D in component A. There will be a key and key way to align components.
7. Continue assembly by sliding up components E, F, G, and H. Screw component E into component A. Screw component H into component E. You may need to use a female mating connector to hold A stationary while screwing in component E to A. Use torque range specified on page 1.

RoHS COMPLIANT

UNITS = mm

DO NOT SCALE FROM DRAWING



THESE DRAWINGS AND SPECIFICATIONS ARE THE PROPERTY OF NorComp AND SHALL NOT BE REPRODUCED, COPIED OR USED AS THE BASIS FOR THE MANUFACTURE OR SALE OF APPARATUS WITHOUT WRITTEN PERMISSION.

DRAWN:
J. KADEL
DATE:
09/05/2023

NorComp

SCALE: NTS	SHEET 2	OF 2	REV 1
DWG NO.		878-YYY-103RKT1	