

| LOOSE PIECE | | TAPE MOUNTED | | SPECIFICATIONS | | | | | |
|-----------------|--------------------|-----------------|--------------------|----------------|---------------------|---------------------|-------------|---------------|--------------|
| MATERIAL NUMBER | ENGINEERING NUMBER | MATERIAL NUMBER | ENGINEERING NUMBER | STUD SIZE | "S" ±.005 [0.13] | "W" ±.010 [0.25] | "C" MIN. | "L" MAX. | "H" |
| 191440037 | C-241-06X | 191440038 | C-241-06XT | 6 | .146 [3.71] | .375 [9.53] | .301 [7.65] | 1.103 [28.02] | .980 [24.89] |
| 191440039 | C-241-08X | 191440041 | C-241-08XT | 8 | .173 [4.39] | | | | |
| 191440042 | C-241-10X | 191440043 | C-241-10XT | 10 | .198 [5.03] | | | | |
| --- | --- | --- | --- | 10 | .198 [5.03] | .533 [13.54] | .393 [9.98] | 1.256 [31.90] | --- |
| --- | --- | --- | --- | 14 | .265 [6.73] | | | | |
| --- | --- | --- | --- | 56 | .328 [8.33] | | | | |

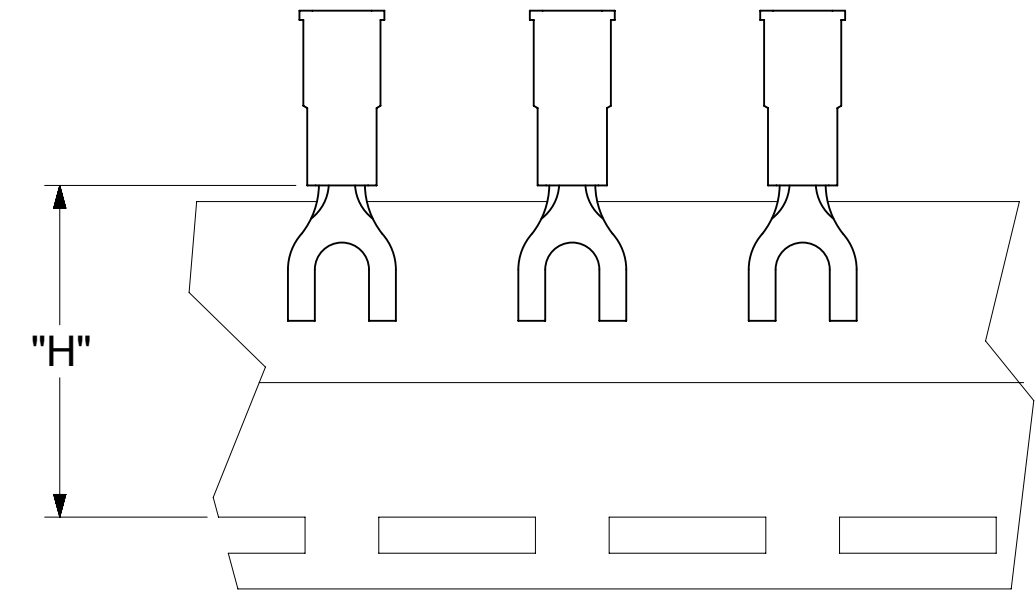
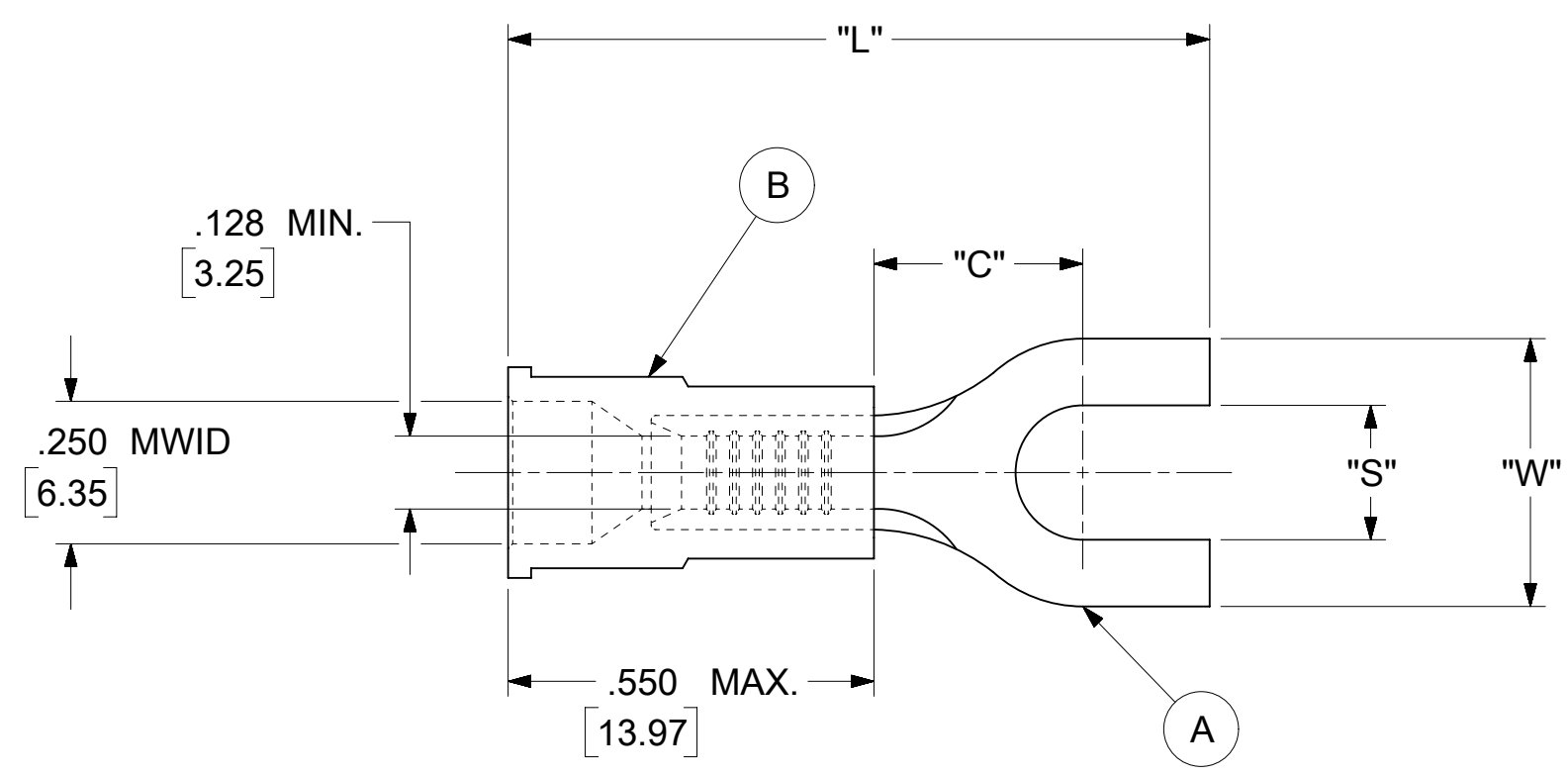

PARTS ON TAPE

NOTES:

- MATERIAL:
 - (A). TERMINAL: COPPER (STOCK THICKNESS .040±.001 [1.02])
PLATING: ELECTRO-TIN (.0003 MIN.)
 - (B). INSULATION: MOLDED PVC (YELLOW)
- MWID: MAXIMUM WIRE INSULATION DIAMETER
- WIRE SIZE: 12 - 10 AWG
4.0 - 6.0 MM²
- "UL" LISTING #E32244
"CSA" LISTING #18689
- ALL DIMENSIONS IN INCHES/[MM].
- PARTS ARE ROHS COMPLIANT.
- DIMS. SHOWN ARE FOR REFERENCE ONLY.

| | | | | | |
|--|---|---------|--|---------|---|
| SYMBOLS ▽ = 0 ▽ = 0 ▽ = 0 ▽ = 0 ▽ = 0 ▽ = 0 ▽ = 0 ▽ = 0 ▽ = 0 ▽ = 0 ▽ = 0 ▽ = 0 | THIS DRAWING CONTAINS INFORMATION THAT IS PROPRIETARY TO MOLEX ELECTRONIC TECHNOLOGIES, LLC AND SHOULD NOT BE USED WITHOUT WRITTEN PERMISSION | | CURRENT REV DESC: MIGRATION TO ECTR/NX | | |
| | DIMENSION UNITS | SCALE | EC NO: 620268 | | |
| | INCH/MM | NTS | DRWN: ABENJAMINLW 2019/07/05 | | |
| | GENERAL TOLERANCES (UNLESS SPECIFIED) | | CHK'D: DMYRICK 2019/07/08 | | |
| | MM | INCH | APPR: JMACNEIL 2019/07/10 | | PRODUCT CUSTOMER DRAWING DOCUMENT NUMBER: 191440037 DOC TYPE: PSD DOC PART: 000 REVISION: A |
| 4 PLACES | ± | ± | INITIAL REVISION: | | |
| 3 PLACES | ± | ± 0.005 | DRWN: JJ 1984/10/31 | | MATERIAL NUMBER: SEE TABLE CUSTOMER: GENERAL MARKET SHEET NUMBER: 1 OF 1 |
| 2 PLACES | ± 0.13 | ± 0.01 | APPR: JMACNEIL 2019/07/10 | | |
| 1 PLACE | ± 0.25 | ± | DRAFT WHERE APPLICABLE MUST REMAIN WITHIN DIMENSIONS | | |
| 0 PLACES | ± | ± | THIRD ANGLE PROJECTION | DRAWING | SERIES |
| ANGULAR TOL | ± ° | | | C-SIZE | 19144 |