

A  
↑  
A  
open

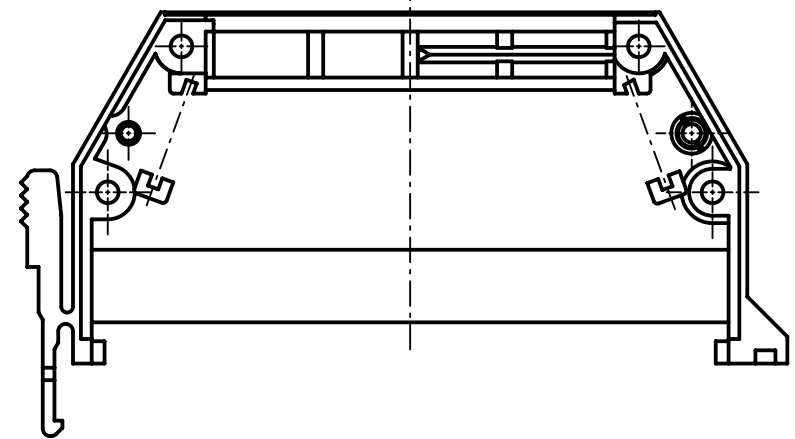

content shell housing		
pos.	qty.	description
03	4	hexagonal nut ISO 4032-M3-8
02	4	cheese head screw ISO 1207-M3x12-4.8
01	2	shell A flat cable entry
parts not assembled		

	All Dimensions in mm Original Size DIN A3		Scale 1:1	Free size tol.		Ref. Sub. TB 09 03 048 0401 / 36101 / 23.02.2011	
	All rights reserved Department EC PD - DE		Created by HAGEMEYERE	Inspected by TADJE	Standardisation HOFFMANN	Date 2016-09-23	State Final Release
HARTING Electronics GmbH D-32339 Espelkamp		Title DIN Power shell housing A flat cable entry				Doc-Key / ECM-Nr. 100101834/UGD/002/B 50000091787	
		Type TB	Number 09060480401			Rev. B	Page 1/1