

DRAWING REVISIONS
(RELEASE DATE ON FILE)

| REV | DOCUMENT | APP | APPROVAL DATE |
|-----|----------|--------|---------------|
| E | CO 3274 | V.RICE | 7/18/16 |

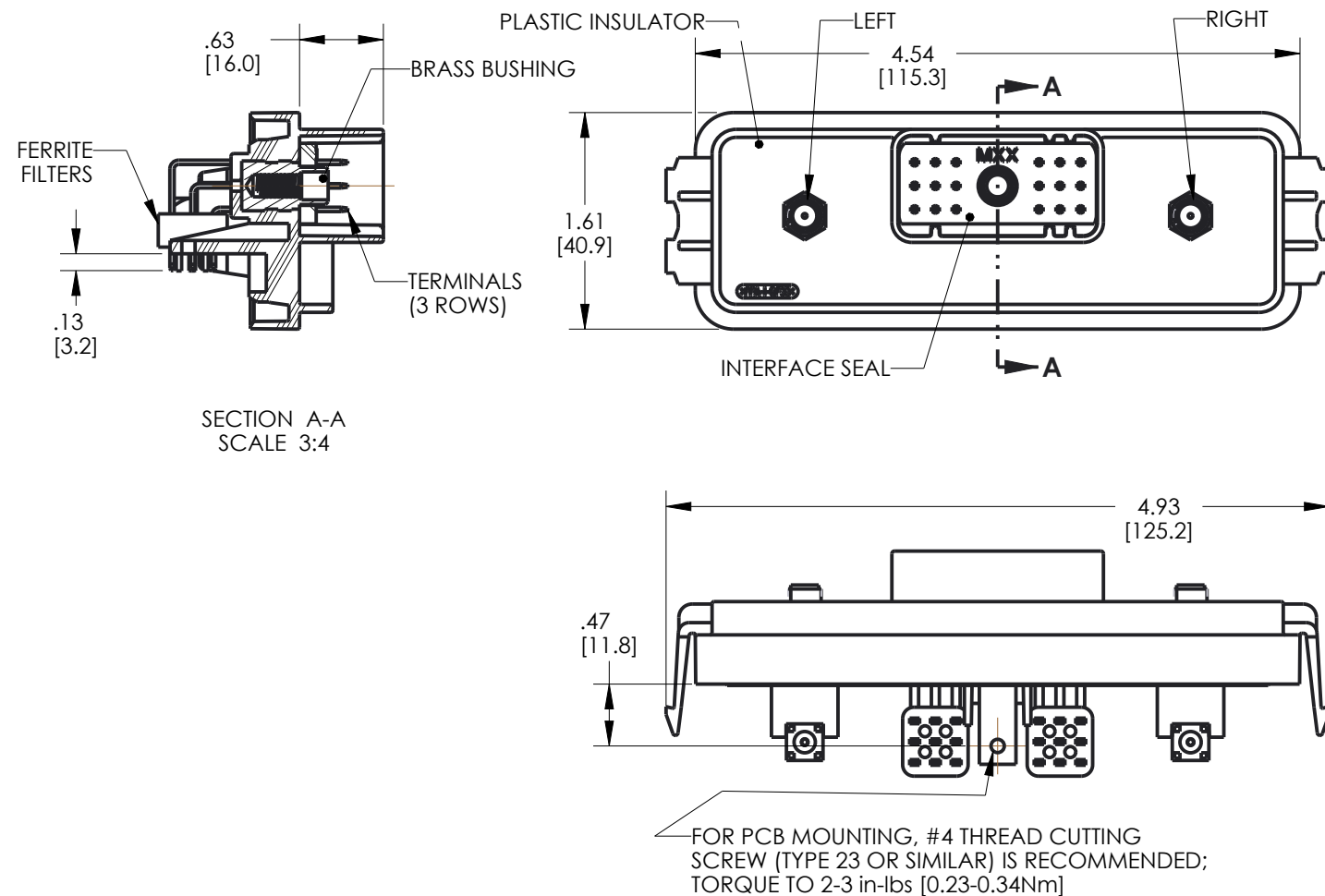

**CINCH P/N: 5810618002 SHOWN
(18 POS HEADER WITH FILTERS)**

| RP SMA = REVERSE POLARITY SMA SMA = STANDARD POLARITY SMA LEFT RIGHT | HEADER | I/O | FERRITE | LEFT RF | RIGHT RF |
|--|------------|-----|---------|---------|----------|
| | 5810618001 | 18 | NO | RP SMA | SMA |
| | 5810618002 | 18 | YES | RP SMA | SMA |
| | 5810618003 | 18 | NO | N/A | SMA |
| | 5810618004 | 18 | YES | N/A | SMA |
| | 5810618005 | 18 | NO | RP SMA | N/A |
| | 5810618006 | 18 | YES | RP SMA | N/A |
| | 5810618007 | 18 | NO | RP SMA | RP SMA |
| | 5810618008 | 18 | YES | RP SMA | RP SMA |
| | 5810618009 | 18 | NO | SMA | SMA |
| | 5810618010 | 18 | YES | SMA | SMA |

NOTES:

- ALL DIMENSIONS ARE REFERENCE ONLY. DIMENSIONS ARE IN INCHES; [BRACKETED DIMENSIONS ARE IN mm]
- MATERIALS:
 INSULATOR: 30% GLASS FILLED POLYMER, COLOR BLACK
 SMA: BODY: BRASS, NICKEL PLATED
 CONTACT: PHOSPHOR BRONZE, GOLD PLATING OVER NICKEL
 INSULATOR: PTFE
 INTERFACE SEAL: SILICONE RUBBER, COLOR BLUE
 INSULATOR: 30% GLASS FILLED POLYMER, COLOR BLACK
 BUSHING: BRASS ALLOY, UNPLATED, 10-24 UNC THREAD
 TERMINAL BLADES: 1.5 mm BRASS WITH TIN OVER NICKEL PLATING
 FILTERS: FERRITE BLOCKS
- ALL HEADERS ARE REFLOW OR WAVE SOLDERING PROCESS COMPATIBLE, AND ROHS COMPLIANT
- SUGGESTED PCB THICKNESS: .062 [1.57]
- IF USING FERRITE FILTER VERSION, TRACES SHOULD BE AVOIDED UNDER THE FERRITE SPACER FEET. SEE "PCB TOP SIDE PIN AREA WITH FERRITES DETAIL" - PAGE 2.
- MATES WITH CINCH SHS PUSH-TO-SEAT HARNESS CONNECTOR P/N: 5810118023
- TORQUE SCREW OF MATING CONNECTOR TO 15 - 20 in-lbs [1.69 - 2.26 Nm]

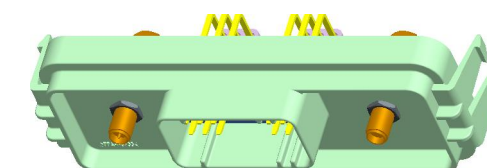

SCALE 1:2

MODELED BY:
V. RICE

| UNITS | DESIGN ENGINEER | DATE | TITLE |
|---|-----------------------------------|--------------|---|
| ENGLISH INCHES | V. RICE | 5/16/12 | MODICE ME-RF 18-WAY / SMA HEADER ASSEMBLY |
| DO NOT SCALE DRAWING | APPROVALS ON FILE | | MATERIAL: SEE NOTES |
| CONFIDENTIAL THIS DOCUMENT IS THE PROPERTY OF CINCH. NEITHER THIS DOCUMENT NOR ANY OF THE INFORMATION CONTAINED IN IT MAY BE DUPLICATED OR DISCLOSED WITHOUT PRIOR WRITTEN CONSENT OF CINCH. ©COPYRIGHT 2009 CINCH | MATERIAL SPEC NUMBER: 5810618001S | | CONTROL SPEC NUMBER: A15085 |
| CAGE IDENT NO. 71785 | | SIZE B | DRAWING NUMBER: 5810618001S |
| SCALE 1:1 | | SHEET 1 OF 2 | |

**RECOMMENDED
TOP SIDE
PCB GENERAL
ZONING AND KEEP-OUT AREAS**

**RECOMMENDED
BOTTOM SIDE
PCB GENERAL
ZONING AND KEEP-OUT AREAS**

**RECOMMENDED
PCB OVERALL DIMENSIONS
AND HOLE LOCATIONS**

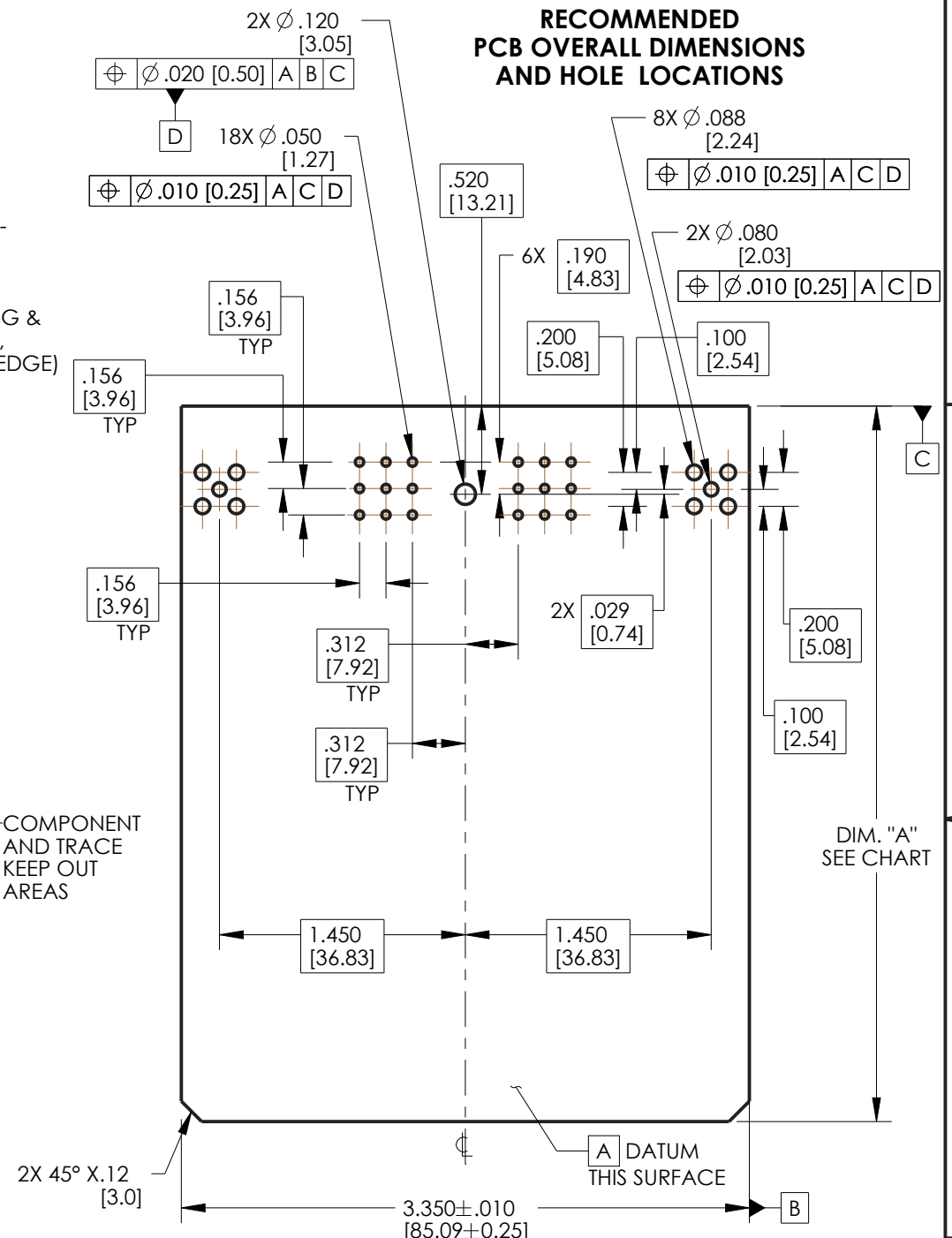
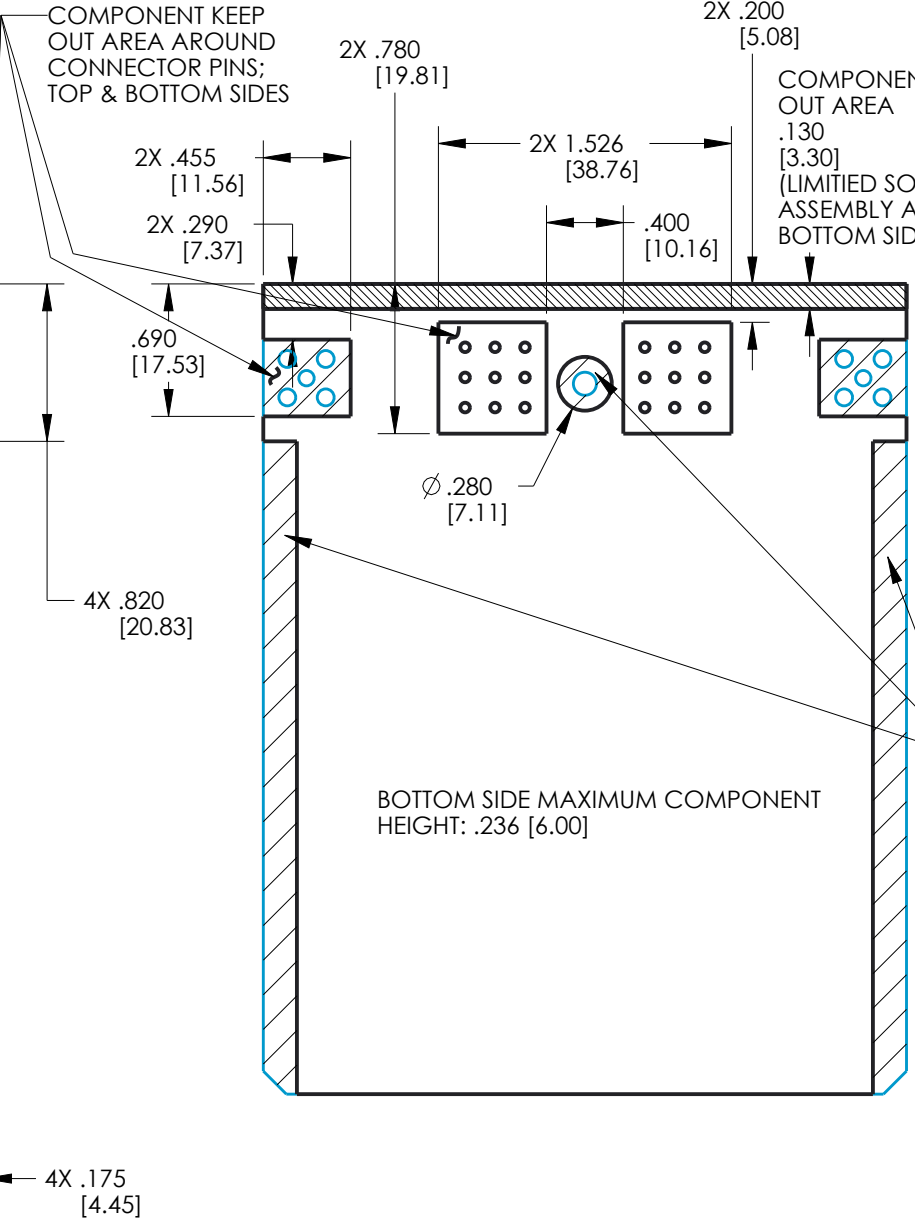
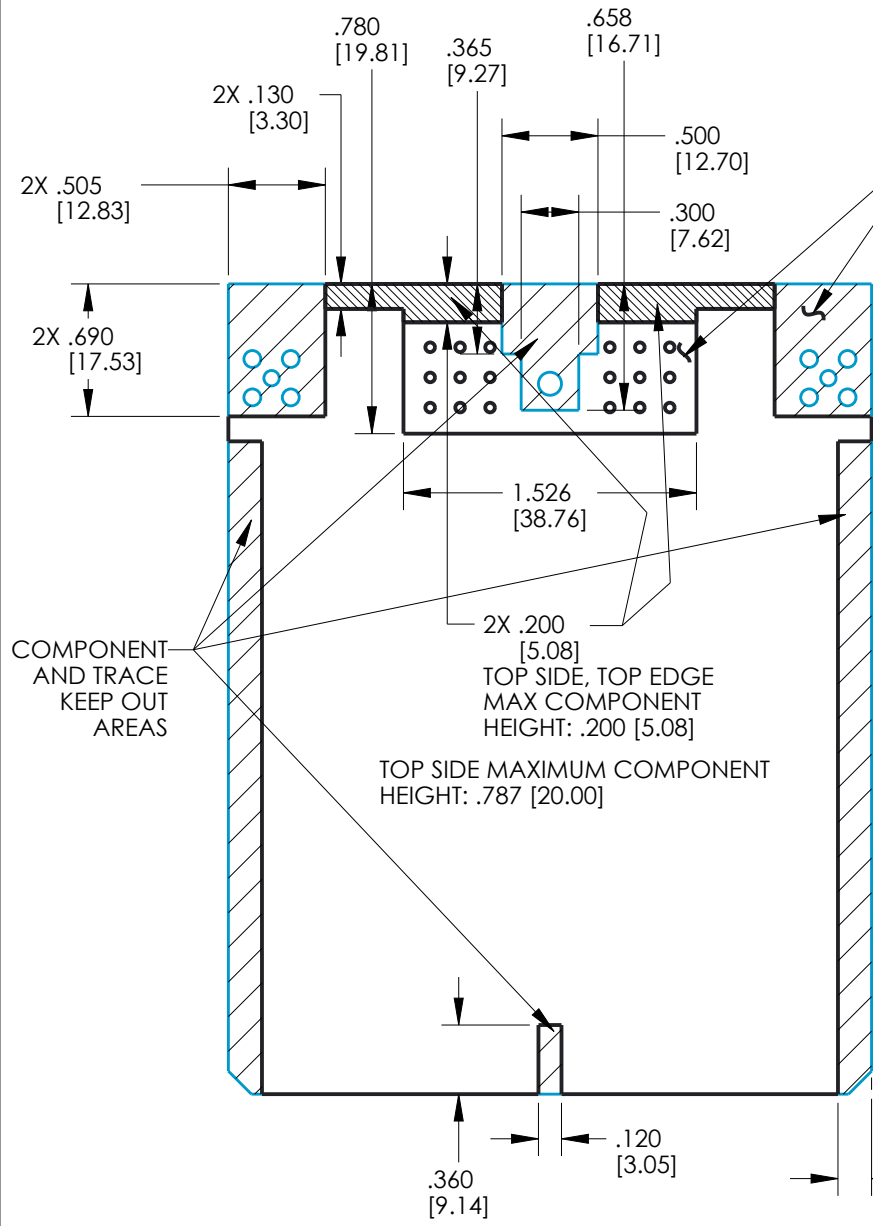

COMPONENT AND TRACE KEEP OUT AREAS

TOP SIDE MAXIMUM COMPONENT HEIGHT: .787 [20.00]

BOTTOM SIDE MAXIMUM COMPONENT HEIGHT: .236 [6.00]

COMPONENT AND TRACE KEEP OUT AREAS

DIM. "A" SEE CHART

FERRITE SPACER FEET TRACE KEEP OUT AREAS (8 PLACES) SEE NOTE 5

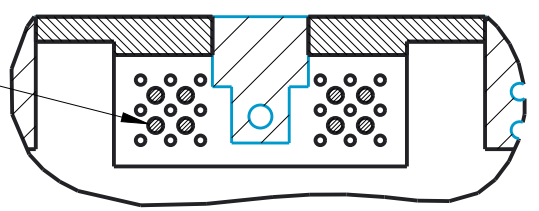

PCB TOP SIDE PIN AREA WITH FERRITES DETAIL

RECOMMENDED PCB LENGTH

| DIM. "A" (SEE DRAWING) | USE WITH ENCLOSURE | |
|------------------------------|--------------------|-----------------------|
| | PART NUMBER | DESCRIPTION |
| 4.220±0.015 [107.19±0.38] | 581 01 30 065 | ME |
| | 581 01 30 075 | ME WITH BREATHER |
| 2.520±0.015 [64.01±0.38] | 581 01 30 090 | MINI ME |
| | 581 01 30 095 | MINI ME WITH BREATHER |

| | | | |
|---|---|--------------------------------------|--------------------------------------|
| UNITS ENGLISH INCHES | CINCH | | 1700 FINLEY RD LOMBARD, IL. 60148 |
| DO NOT SCALE DRAWING | TITLE MODICE ME-RF 18-WAY / SMA HEADER ASSEMBLY | | |
| PRO/E DRAWING | | | |
| CONFIDENTIAL THIS DOCUMENT IS THE PROPERTY OF CINCH. NEITHER THIS DOCUMENT NOR ANY OF THE INFORMATION CONTAINED IN IT MAY BE DUPLICATED OR DISCLOSED WITHOUT PRIOR WRITTEN CONSENT OF CINCH. ©COPYRIGHT 2009 CINCH | CAD FILE NUMBER 5810618001S | DRAWING NUMBER 5810618001S | REV E |
| | CAGE IDENT NO. 71785 | SIZE B | SCALE 1:1 |
| | | SHEET 2 OF 2 | |