

THIS IS ISSUED IN STRICT CONFIDENCE THAT IT IS NOT USED AS A BASIS FOR MANUFACTURE OR SALE AND THAT IT IS NOT COPIED, REPRINTED OR DISCLOSED TO A THIRD PARTY EITHER WHOLLY OR IN PART WITHOUT THE PRIOR WRITTEN CONSENT OF CAL TEST ELECTRONICS, INC.

REVISIONS			
REV.	DESCRIPTIONS	DATE	APPROVED
-	CLASS A RELEASED	7/11/99	
A	UPDATED FORMAT w/ CAGE CODE	4/18/04	

- DO-IT-YOURSELF (DIY) 4mm STACKING BANANA PLUG, SCREW ATTACHMENT
- SPECIFICATIONS:
 INSULATOR BODY: POLYAMIDE (NYLON)
 PLUG BODY: BRASS, NICKEL PLATED
 CONTACT SPRING: BERYLLIUM COPPER ALLOY, NICKEL PLATED
- RATING:
 IEC: <33 V AC / <70 V DC
 VOLTAGE: 1,200 V NON-HANDHELD
 CURRENT: 36 A MAX.
 TEMPERATURE: -20° C TO +80° C.
- MAXIMUM WIRE SIZES:
 CONDUCTOR: \varnothing .090 (12AWG)
 INSULATION: \varnothing .156 (5/32")
 STRIP LENGTH: .25 (6.4)

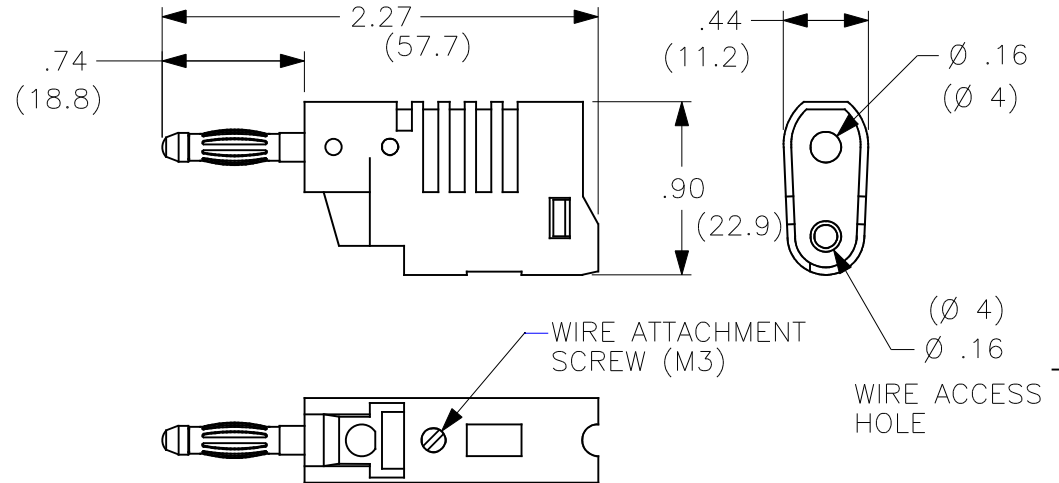

MODEL NUMBER

CT2013-#

- COLOR:
- 0 - BLACK
 - 2 - RED
 - 4 - YELLOW
 - 5 - GREEN
 - 6 - BLUE
 - 9 - WHITE

THIRD ANGLE PROJECTION		UNLESS OTHERWISE SPECIFIED DIMENSIONS ARE IN INCHES TOLERANCES ARE: FRACTIONS DECIMALS ± 1/32 .XX ± .02 .XXX ± .005 DO NOT SCALE DRAWING	CONTRACT NO.		Cal Test Electronics 22820 Savi Ranch Parkway Yorba Linda, CA 92887-4610	
			APPROVALS	DATE		
		DRAWN WDH	7/11/99	SIZE A CAGE CODE 43F45 DWG. NO. P201300 REV. A		
		CHECKED				SCALE 1:1 SHEET 1 OF 1
		ENGR.				
		DESIGN ACTIVITY				
NEXT ASSY		USED ON				
APPLICATION						