

13	12	11	10	9	8	7	6	5	4	3	2	1
POLES	MATERIAL NO.	ENGINEERING NO.	FINISHED LENGTH	FRONT VIEW - MALE INSERT CONFIGURATION CHART				FRONT VIEW - FEMALE INSERT CONFIGURATION CHART				
3	1200660029	NN3030A41M010G	3'3" +2.19"-0 (1M +55.6mm-0)									
3	1200661997	NN3030A41M020G	6'7" +3.50"-0 (2M +88.9mm-0)									
3	1200660030	NN3030A41M050G	16'5" +6.50"-0 (5M +165.1mm-0)									
4	1200660035	NN4030A41M010G	3'3" +2.19"-0 (1M +55.6mm-0)									
4	1200660036	NN4030A41M020G	6'7" +3.50"-0 (2M +88.9mm-0)									
4	1200660037	NN4030A41M030G	9'10" +3.50"-0 (3M +88.9mm-0)									
4	1200660038	NN4030A41M040G	13'1" +6.50"-0 (4M +165.1mm-0)									
4	1200660039	NN4030A41M050G	16'5" +6.50"-0 (5M +165.1mm-0)									
4	1200661696	NN4030A41M100G	32'10" +12.50"-0 (10M +317.5mm-0)									

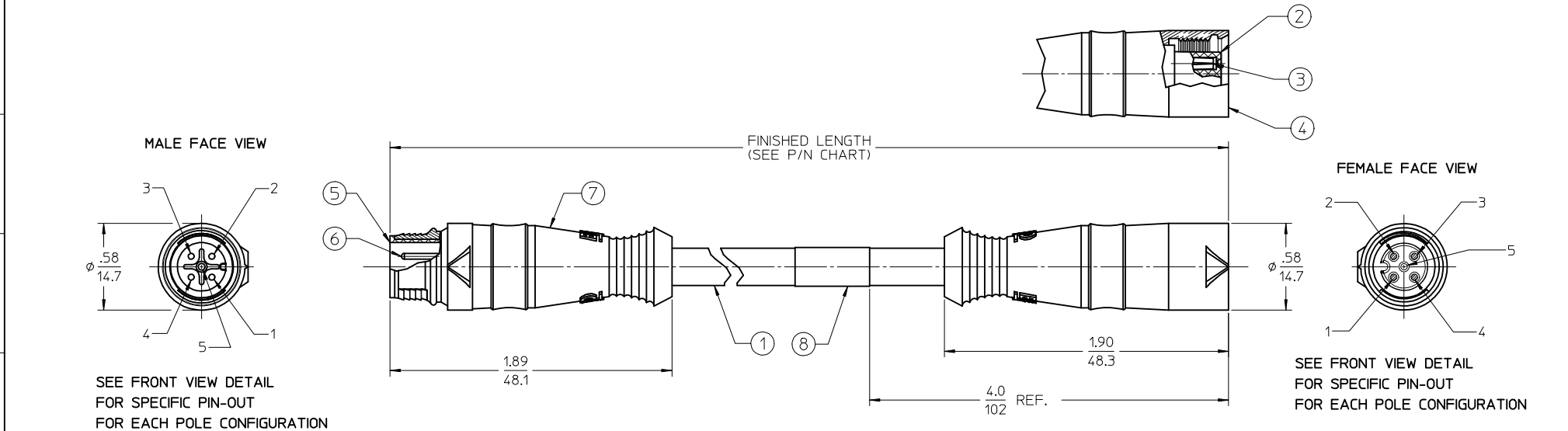

NOTES:					CABLE P/N MATRIX				
1. MATERIAL: SEE TABLE					NNX030A41MXXXG				
2. FINISHES: SEE TABLE					DOUBLE ENDED CORDSET				
3. ELECTRICAL SPECIFICATIONS					NUMBER OF POLES				
VOLTAGE RATING: 250V AC/DC					CONNECTOR STYLE (MALE/FEM STRAIGHT)				
CURRENT RATING: 4 AMPS					CABLE TYPE (22 AWG BLACK PVC)				
4. XX REFERS TO NUMBER OF CIRCUITS					FINISHED LENGTH				
					M00X= .1X METER				
					M010= 1X METER				
					M100= 10X METERS				

8	1	WRAP LABEL	VINYL	BLACK/YELLOW	RELEASED EC NO: JFG2015-1589 2015/03/10 DRWN:RSTONE 2015/03/12 CHKDK JOZWIK 2015/03/17 APPR:JFMURPHY	DESCRIPTION	QUALITY SYMBOLS <div>▽=0</div> <div>▽=0</div>	GENERAL TOLERANCES (UNLESS SPECIFIED) <table><tr><td></td><td>mm</td><td>INCH</td></tr><tr><td>4 PLACES</td><td>± ---</td><td>± ---</td></tr><tr><td>3 PLACES</td><td>± ---</td><td>± ---</td></tr><tr><td>2 PLACES</td><td>± ---</td><td>± .01</td></tr><tr><td>1 PLACE</td><td>± 0.3</td><td>± ---</td></tr><tr><td>0 PLACE</td><td>± ---</td><td>± ---</td></tr><tr><td colspan="3">ANGULAR ± 2 °</td></tr></table>		mm	INCH	4 PLACES	± ---	± ---	3 PLACES	± ---	± ---	2 PLACES	± ---	± .01	1 PLACE	± 0.3	± ---	0 PLACE	± ---	± ---	ANGULAR ± 2 °			DIMENSION STYLE IN/MM	SCALE 2:1	DESIGN UNITS INCH	THIRD ANGLE PROJECTION
	mm	INCH																															
4 PLACES	± ---	± ---																															
3 PLACES	± ---	± ---																															
2 PLACES	± ---	± .01																															
1 PLACE	± 0.3	± ---																															
0 PLACE	± ---	± ---																															
ANGULAR ± 2 °																																	
7	1	MICRO-PUSH OVERMOLD (MALE)	TPE	BLACK	DRAWN BY RSTONE	DATE 2015/03/10	TITLE MIC PUSH-ON CABLE ASSY MALE STR TO FEMALE STR 22 AWG CABLE																										
6	XX	CONTACT PIN	Cu ALLOY	GOLD PLATED	CHECKED BY K JOZWIK	DATE 2015/03/12	molex																										
5	1	INSERT (MALE)	NYLON	BLACK	APPROVED BY JFMURPHY	DATE 2015/03/17		DOCUMENT NO. SD-120066-058																									
4	1	MICRO-PUSH OVERMOLD (FEMALE)	PVC	BLACK	SEE P/N CHART				SHEET NO. 1 OF 1																								
3	XX	CONTACT SOCKET	Cu ALLOY	GOLD PLATED	DRAFT WHERE APPLICABLE MUST REMAIN WITHIN DIMENSIONS			THIS DRAWING CONTAINS INFORMATION THAT IS PROPRIETARY TO MOLEX INCORPORATED AND SHOULD NOT BE USED WITHOUT WRITTEN PERMISSION																									
2	1	INSERT (FEMALE)	NYLON	BLACK																													
1	A/R	CABLE, 22 AWG, UN SHLD	PVC JACKET	BLACK																													
ITEM	QTY.	DESCRIPTION	MATERIAL	FINISH	REV																												