

| CIRCUIT SIZE | DIM A (±.010/±0.25) | DIM B |
|--------------|------------------------|------------------------------|
| 2 | .623 (15.82) | .295 ±.006 (7.49 ±0.15) |
| 3 | .918 (23.32) | .590 ±.008 (14.99 ±0.20) |
| 4 | 1.213 (30.82) | .885 ±.008 (22.48 ±0.20) |
| 5 | 1.508 (38.30) | 1.180 ±.008 (29.97 ±0.20) |
| 6 | 1.803 (45.80) | 1.475 ±.010 (37.47 ±0.25) |
| 8 | 2.393 (60.78) | 2.065 ±.008 (52.45 ±0.20) |

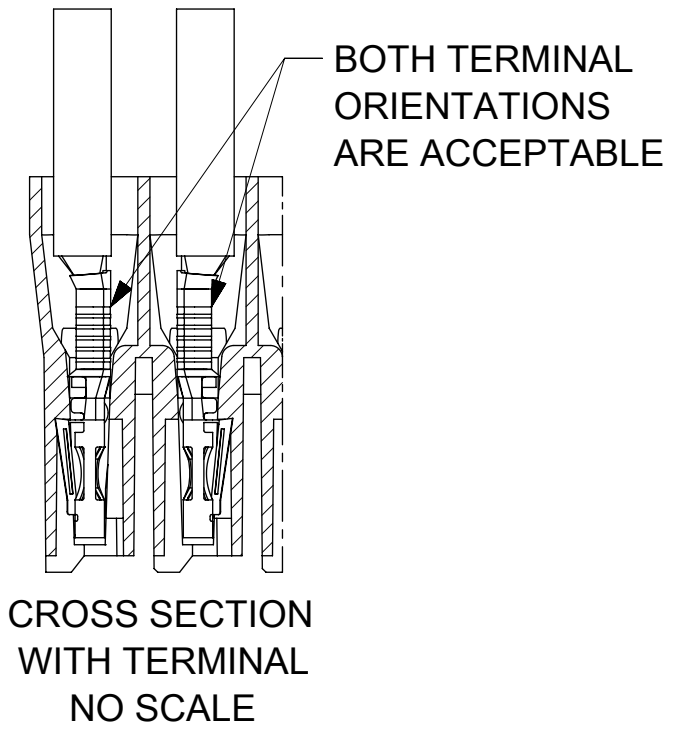
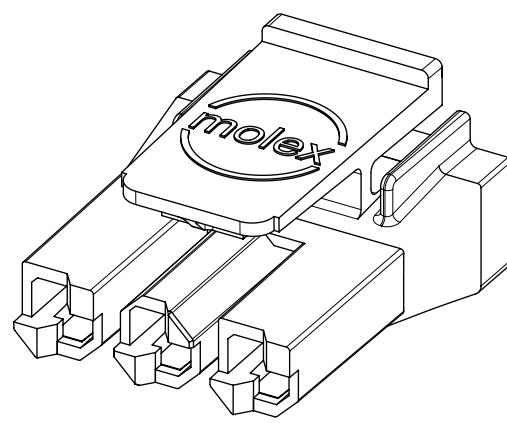
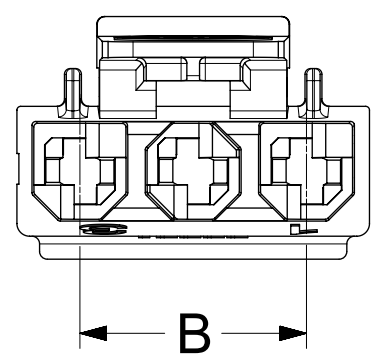

- NOTES:**
1. MATERIAL: SEE CHART.
 2. THIS CONNECTOR HOUSING FOR USE WITH 171825 TERMINALS.
 3. THIS CONNECTOR HOUSING WILL MATE TO 172042, 172043, 172673, AND 43680.
 4. PRODUCT SPECIFICATION: PS-171825-001.
 5. PACKAGING: PK-44441-001.
 6. PARTS CONFORM TO CLASS 'B' REQUIREMENTS OF COSMETIC SPECIFICATION PS-45499-002 BUT, MEETS CLASS 'C' REQUIREMENTS FOR BUBBLES, SINK AND DISCOLORATION.
 7. MOLDED IN SERIES NO. MAY BE 172672 OR 44441.
 8. TEXT ON PART IS FOR REFERENCE ONLY. TEXT AND TEXT LOCATION MAY VARY DEPENDING ON PART NUMBER AND/OR TOOL.
 9. LAST CIRCUIT I.D. NOT PRESENT ON 2 CIRCUIT PARTS.
 10. DIMENSION C IS .600/(15.24) FOR 2 AND 8 CIRCUIT PARTS
DIMENSION C IS .632/(16.05) FOR ALL OTHER CIRCUIT SIZES.
 11. THIS DRAWING REPLACES SD-172672-001.

| | | | | |
|-------------------|---|----------------|-------------------------------------|---------------------|
| SYMBOLS | THIS DRAWING CONTAINS INFORMATION THAT IS PROPRIETARY TO MOLEX ELECTRONIC TECHNOLOGIES, LLC AND SHOULD NOT BE USED WITHOUT WRITTEN PERMISSION | | CURRENT REV DESC: UPDATE TOLERANCES | |
| | DIMENSION UNITS | SCALE | | |
| ▽ = 0 | IN/MM | 2:1 | | |
| ▽ = 0 | GENERAL TOLERANCES (UNLESS SPECIFIED) | | | |
| ▽ = 0 | | MM | INCH | |
| ▽ = 0 | 4 PLACES ± | | | |
| ▽ = 0 | 3 PLACES ± | | ± 0.01 | |
| ▽ = 0 | 2 PLACES ± | 0.25 | ± 0.014 | |
| ▽ = 0 | 1 PLACE ± | 0.35 | | |
| ▽ = 0 | 0 PLACES ± | | | |
| ⊠ = 0 | ANGULAR TOL ± 0.5° | | | |
| ■ = 0 | DRAFT WHERE APPLICABLE MUST REMAIN WITHIN DIMENSIONS | | THIRD ANGLE PROJECTION | DRAWING |
| ▽ = 0 | | | SERIES | 172672 |
| DOCUMENT STATUS | | P1 | RELEASE DATE | 2018/09/13 17:17:26 |
| EC NO: 604166 | | DRWN: JBAUMERT | 2018/09/07 | |
| DRWN: CSLAFTER | | CHK'D: MKIPPER | 2018/09/12 | |
| APPR: FSMITH | | 2018/09/13 | | |
| INITIAL REVISION: | | 2016/12/28 | | |
| APPR: FSMITH | | | | |
| MATERIAL NUMBER | | CUSTOMER | SHEET NUMBER | |
| SEE CHART | | GENERAL MARKET | 1 OF 2 | |

| CIRCUIT SIZE | PART NO. | MATERIAL | COLOR |
|--------------|------------|--|-------|
| 2 | 1726722002 | UL94V-0 NYLON MEETS REQUIREMENTS FOR DIRECT SUPPORT OF UNINSULATED LIVE PARTS AS DESCRIBED IN UL508C | BLACK |
| 3 | 1726722003 | | |
| 4 | 1726722004 | | |
| 5 | 1726722005 | | |
| 6 | 1726722006 | | |
| 8 | 1726722008 | | |
| 2 | 1726723002 | UL94V-2 NYLON IEC 60335-1 GLOW WIRE CAPABLE | BLACK |
| 3 | 1726723003 | | |
| 4 | 1726723004 | | |
| 5 | 1726723005 | | |
| 6 | 1726723006 | | |
| 8 | 1726723008 | | |

POLARIZATION LAYOUT

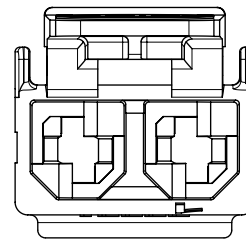

2-CKT.

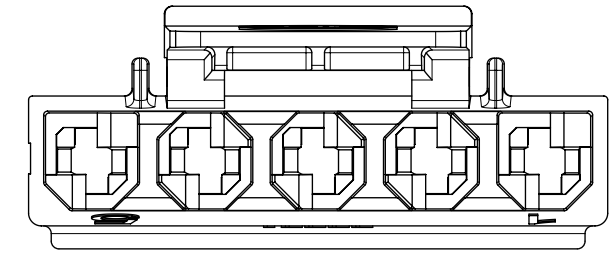

5-CKT.

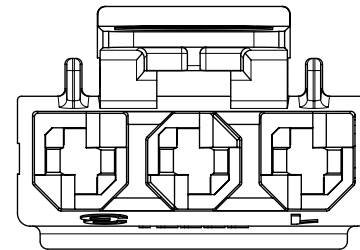

3-CKT.

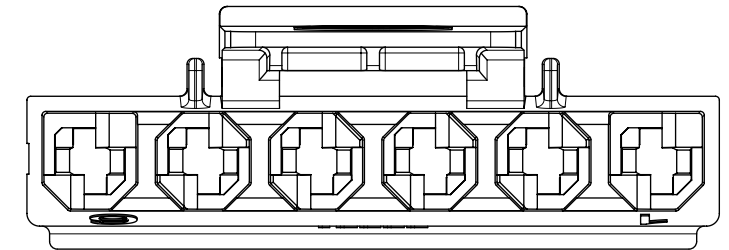

6-CKT.

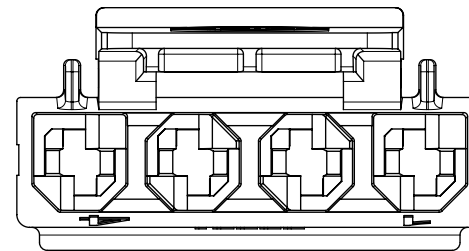

4-CKT.

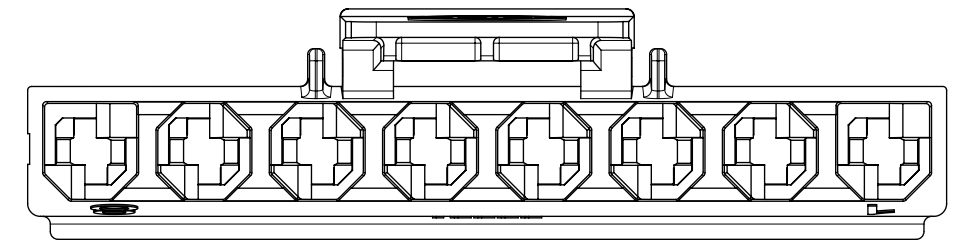

8-CKT.

| | | | | |
|--|---|-------------------------------------|--|--|
| SYMBOLS = 0 = 0 = 0 = 0 = 0 = 0 = 0 = 0 = 0 = 0 = 0 = 0 | THIS DRAWING CONTAINS INFORMATION THAT IS PROPRIETARY TO MOLEX ELECTRONIC TECHNOLOGIES, LLC AND SHOULD NOT BE USED WITHOUT WRITTEN PERMISSION | | CURRENT REV DESC: UPDATE TOLERANCES | |
| | DIMENSION UNITS IN/MM | SCALE 2:1 | molex | |
| | GENERAL TOLERANCES (UNLESS SPECIFIED) | | EC NO: 604166 DRWN: JBAUMERT 2018/09/07 CHK'D: MKIPPER 2018/09/12 APPR: FSMITH 2018/09/13 | |
| | 4 PLACES ± 3 PLACES ± 2 PLACES ± 0.25 ± 0.014 1 PLACE ± 0.35 ± 0 PLACES ± | MM INCH ± ± ± ± ± ± ± ± | INITIAL REVISION: DRWN: CSLAFTER 2016/12/28 APPR: FSMITH | |
| ANGULAR TOL ± 0.5° | DRAFT WHERE APPLICABLE MUST REMAIN WITHIN DIMENSIONS | THIRD ANGLE PROJECTION | DRAWING B-SIZE | SERIES 172672 |
| DOCUMENT STATUS P1 RELEASE DATE 2018/09/13 17:17:26 | DOCUMENT NUMBER 1726720000-SD | | DOC TYPE DOC PART REVISION PSD 000 A1 | MATERIAL NUMBER CUSTOMER SHEET NUMBER SEE CHART GENERAL MARKET 2 OF 2 |