

Technical drawing of a rectangular plate with dimensions and hole specifications.

Top View:

- Overall width: A
- Overall height: B
- Four holes are located at the corners, with a diameter of $\varnothing 5.94$ (4 PLACES [.234]).
- Distance from the right edge to the center of the right holes: 4.8 [.19]
- Distance from the top edge to the center of the top holes: 10.7 [.42]
- Distance from the bottom edge to the center of the bottom holes: 8.9 [.35]
- Distance from the center of the top holes to the center of the bottom holes: 28.4 [1.12]

Side View:

- Thickness of the plate: 14.0 [.55]
- Distance from the top edge to the center of the top holes: 10.7 [.42]
- Distance from the bottom edge to the center of the bottom holes: 8.9 [.35]

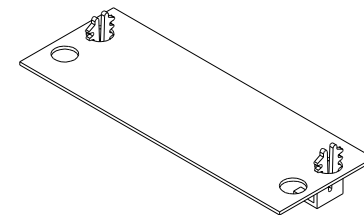

AUX. VIEW
SCALE 1:1

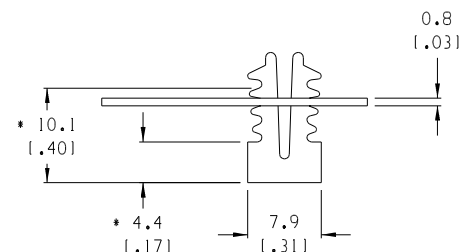

NOTES:

1. MATERIAL: SEE TABLE
2. FINISHES: SEE TABLE
3. PRODUCT SPECIFICATION: NOT REQUIRED
4. PACKAGING: NOT REQUIRED
5. MATES WITH: 18 AND 78 SERIES BTS
6. (*) DIMENSIONS INDICATE MAX. AND MIN. COVER HEIGHT.

EC NO. A	DRWN: CH-K APPR:	DESCRIPTION	QUALITY SYMBOLS <div>MAJOR CRITICAL SPC</div>	GENERAL TOLERANCES: (UNLESS SPECIFIED)		SCALE 2:1	DESIGN UNITS <input type="checkbox"/> mm <input checked="" type="checkbox"/> INCH	THIRD ANGLE PROJECTION	<input checked="" type="checkbox"/> mm INCH <input type="checkbox"/> INCH mm <input type="checkbox"/> mm ONLY	SHIP REVISE ON CAD ONLY	REV REVISE ON CAD ONLY	
				4 PLACES	<div>mm</div> <div>INCH</div>	<div>mm</div> <div>INCH</div>	DRAWN BY & DATE C. YORK 10-04-04	TITLE: BTS COVER KIT, FLAT				
				3 PLACES	<div>mm</div> <div>INCH</div>	<div>mm</div> <div>INCH</div>	CHECKED BY & DATE	MOLEX INCORPORATED				
				2 PLACES	<div>mm</div> <div>INCH</div>	<div>mm</div> <div>INCH</div>	APPROVED BY & DATE	CAD FILENAME CA04XX				
				1 PLACE	<div>mm</div> <div>INCH</div>	<div>mm</div> <div>INCH</div>		MATERIAL NO. SEE CHART	DRAWING NO. SD-38783-001	SHEET NO. 1 OF 1	SIZE B	
				ANGULAR: $\pm 2^\circ$								
				DRAFT WHERE APPLICABLE MUST REMAIN WITHIN DIMENSIONS		THIS DRAWING CONTAINS INFORMATION THAT IS PROPRIETARY TO MOLEX INCORPORATED AND SHOULD NOT BE USED WITHOUT WRITTEN PERMISSION.						

	10	9	8	7	6	5	4	3	2	1	0
--	----	---	---	---	---	---	---	---	---	---	---