

THIS COPY IS PROVIDED ON A RESTRICTED BASIS AND IS NOT TO BE USED IN ANY WAY DETRIMENTAL TO THE INTERESTS OF PANDUIT CORP.

PANDUIT PART NUMBER	WEIGHT
FR12TB2412 FR12TB2412M	4.49 LB/EACH (2037g/EACH)

NOTES:

1. SEE CURRENT CATALOG FOR ADDITIONAL PART SUFFIXES TO INDICATE PACKAGE QUANTITY.
2. THE FIBERRUNNER 12x4 QUIKLOCK TRAPEZE BRACKET FOR 24" WIDE CABLE PATHWAYS IS USED TO SUPPORT THE FIBERRUNNER 12x4 CABLE ROUTING SYSTEM BETWEEN TWO (2) SECTIONS OF NEW 1/2" (M12) THREADED ROD THAT ARE 24" (609.6) - 31.5" (800.1) APART.
3. THE FIBERRUNNER 12x4 QUIKLOCK TRAPEZE BRACKET FOR 24" WIDE CABLE PATHWAYS - 1/2" (M12) THREADED ROD INCLUDES:
ONE (1) BRACKET ASSEMBLY,
TWO (2) 1/2 CLAMP PLATES,
FOUR (4) 1/2 HELICAL SPRING LOCKWASHERS,
FOUR (4) 1/2-13 HEAVY HEX NUTS (FR12TB2412 ONLY),
FOUR (4) M12x1.75 HEX NUTS (FR12TB2412M ONLY),
ONE (1) 1/4-20 T-BOLT,
ONE (1) 1/4-20 HEX KEPS NUT.
4. FINISH COLOR: BLACK (EXCEPT FOR HARDWARE)
5. DIMENSIONS IN PARENTHESES ARE IN METRIC.

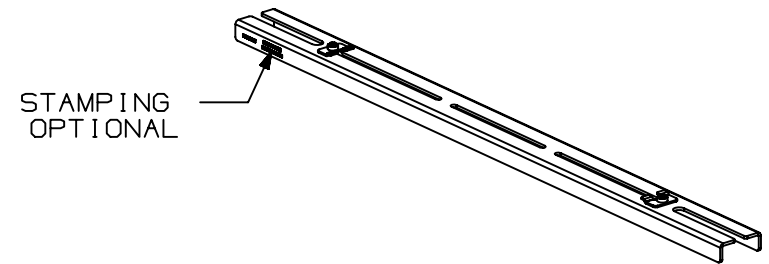
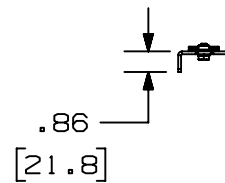
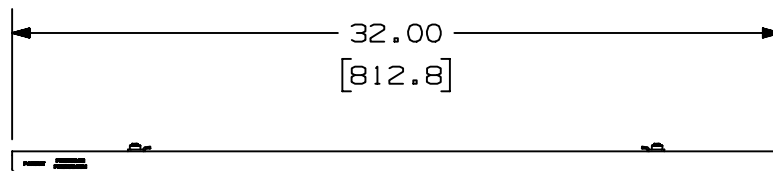
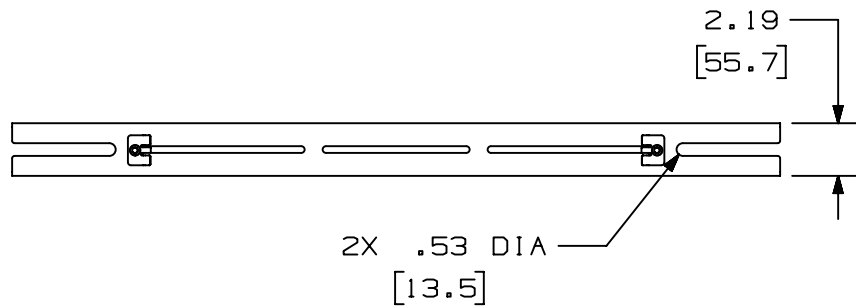

00B	9/9/19	MEX-JAGC	FWI	FWI	A. "STAMPING OPTIONAL" LABEL ADDED SEE PREVIOUS REVISION FOR HISTORY	V09002CN/07
R	10/21/08	MSO	SL		RELEASED TO PRODUCTION	39701-48
REV	DATE	BY	CHK	APR	DESCRIPTION	ECN

TITLE FIBERRUNNER 12x4 QUIKLOCK TRAPEZE BRACKET FOR 24" WIDE CABLE PATHWAYS - 1/2" (M12) THREADED ROD						
CUSTOMER DRAWING						
ITEM REVISION NAME D39701CS/00			PANDUIT			
DATASET FILE NAME D39701CS_DC/00B						
			MATERIAL: N/A			
			DRAWING NUMBER: 39701-48			
DRAWN BY MSO		DATE 10/21/08	CHK SL	SCALE NONE	SHT 1 OF 1	SIZE A

D10100DA/20