

SW2015

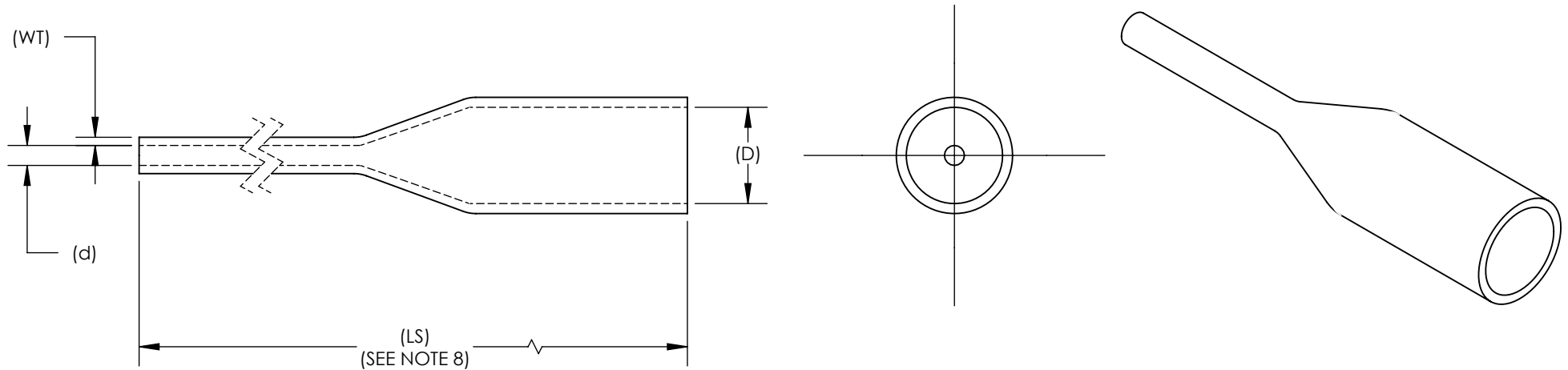

Revision level			Revision Record	Changed	Date	Approved	Date
Drawing	State	Part					
02.1	Design Release		SEE ECN# 013647	GRW	11/7/2016	KAC	11/7/2016



Type	Length Style (LS) A = Reel; B = Stick (See Note 8)	Trade Size	Supplied Diameter (D)		Recovered Diameter (d)		Wall Thickness Recovered (WT)		Color
			in	mm	in	mm	in	mm	
TFN31-ST-1.5/0.5 BK	B	1/16	0.063	1.6	0.02	0.5	0.018	0.45	Black
TFN31-ST-3/1 BK	B	1/8	0.125	3.2	0.039	1.0	0.022	0.55	Black
TFN31-3/1 BK	A								
TFN31-ST-4.5/1.5 BK	B	3/16	0.188	4.8	0.059	1.5	0.024	0.64	Black
TFN31-ST-6/2 BK	B								
TFN31-6/2 BK	A	1/4	0.25	6.4	0.079	2.0	0.026	0.65	Black
TFN31-ST-9/3 BK	B								
TFN31-9/3 BK	A	3/8	0.375	9.5	0.118	3.0	0.029	0.75	Black
TFN31-ST-12/4 BK	B								
TFN31-12/4 BK	A	1/2	0.50	12.7	0.157	4.0	0.031	0.80	Black
TFN31-ST-18/6 BK	B								
TFN31-18/6 BK	A	3/4	0.75	19.1	0.236	6.0	0.035	0.90	Black
TFN31-ST-24/8 BK	B								
TFN31-24/8 BK	A	1	1.0	25.4	0.315	8.0	0.047	1.20	Black
TFN31-39/13 BK	A								
		1 1/2	1.5	39.0	0.512	13.0	0.049	1.25	Black

NOTES:

- SHRINK RATIO 3:1
- LONGITUDINAL CHANGE AFTER SHRINKAGE +5%
- MINIMUM SHRINK TEMPERATURE 212° F (100° C)
- OPERATING TEMPERATURES -67° F TO 275° F (-55° C TO 135° C)
- DIELECTRIC STRENGTH >20kV/MM ACCORDING TO ASTM D 150
- FLAMMABILITY UL 224 VW-1 600V (except clear)
- STANDARDS - MEETS SAE-AMS-DTL-23053/5 CLASS 1 & 3
- CONSULT FACTORY OR WEBSITE FOR AVAILABLE LENGTHS

Material
POLYOLEFIN, CROSS LINKED

Units: inches
Dimension without tolerances details to:
.xxxx = ±.0005
.xxx = ±.005
.xx = ±.01
.x = ±.03
None = ±.06
∠ = ±0.5°
Dimension Formatted in[mm]

The copyright of this drawing is reserved by HellermannTyton. It is issued on condition that it is not reproduced, copied, or disclosed to a third party, either wholly or in part, without the consent of HellermannTyton.

Drawn GRW 11/7/2016
Approved KAC 11/7/2016

HellermannTyton
North America
Email: corp@htamericas.com
Web: www.hellermann.tyton.com

Article/Type-No TFN31 SERIES
Title **HEAT SHRINK TUBING, 3:1 SHRINK RATIO, NON-ADHESIVE THIN WALL TUBING**
Drawing-No PRODUCTION : Phase
16-1635-001-CSU

Scale
Project Number PRP 16-1635
Format AH
Sheet 1/1