

SPECIFICATIONS

Ratings: 10mA @ 35 VDC
 Electrical Life: 500,000 cycles typical
 Contact Resistance: 10mΩ max., typical @ 2-4 VDC, 100mA
 Insulation Resistance: 1,00MΩ min.
 Dielectric Strength: >1,000 V rms at sea level
 Operating Force: 130 ± 50 gf

MATERIALS

Housing: Polycarbonate (PC)
 Base: Valox
 Contacts: Silver-plated copper alloy
 Terminals: Silver-plated copper alloy

HOW TO ORDER

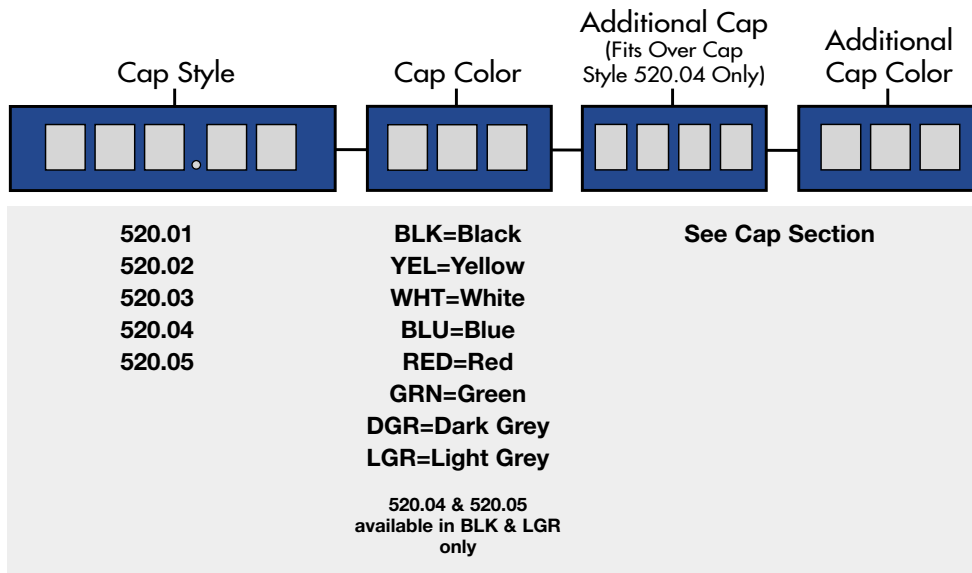

EXAMPLE

520.04 → BLK → TAA → RED

SPECIFICATIONS SUBJECT TO CHANGE WITHOUT NOTICE.

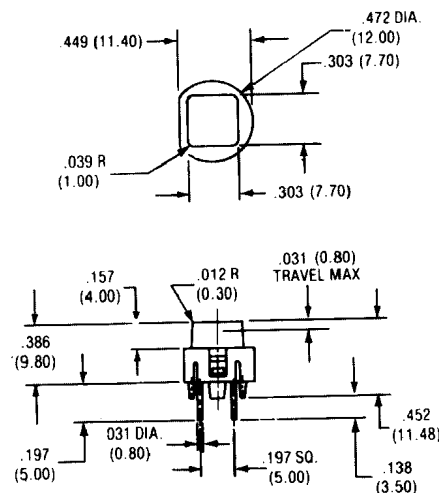

P.C. MOUNTING

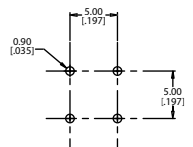

Schematic

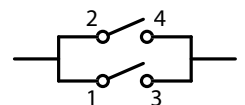

PUSHBUTTON SWITCHES



520.02

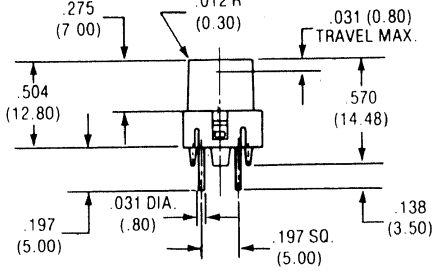
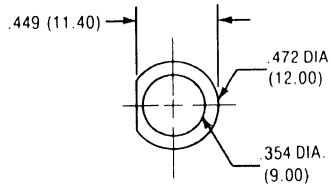

P.C. MOUNTING

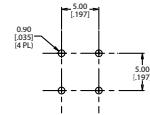

Schematic

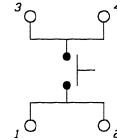

520.03

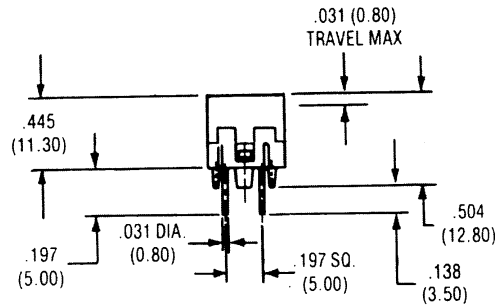
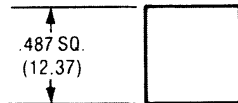

P.C. MOUNTING

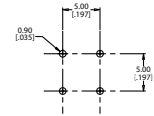

Schematic

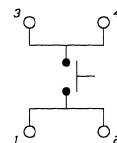

520.04

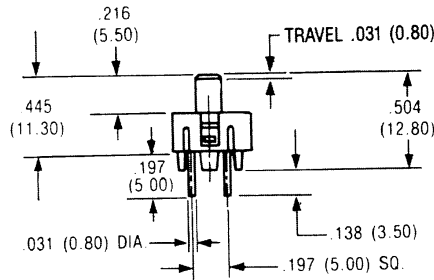
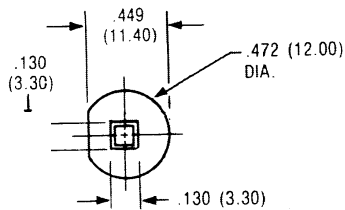

P.C. MOUNTING

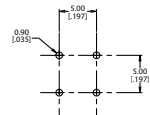

Schematic

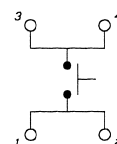

520.05

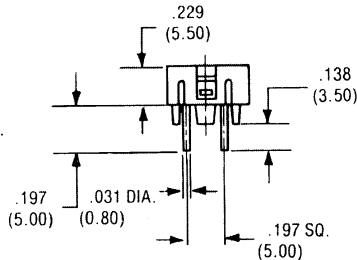
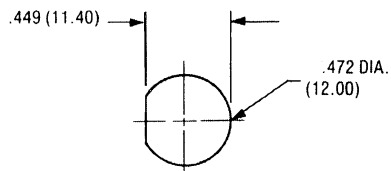

P.C. MOUNTING

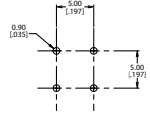

Schematic

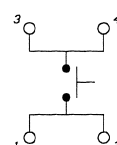

520.04 and 520.05 are available in black and light grey only.

SPECIFICATIONS SUBJECT TO CHANGE WITHOUT NOTICE.