

THIS COPY IS PROVIDED ON A RESTRICTED BASIS AND IS NOT TO BE USED IN ANY WAY DETRIMENTAL TO THE INTERESTS OF PANDUIT CORP.

PANDUIT PART NO.	WEIGHT
ECFX3	.66 LB/100 PCS 302 g/100 PCS

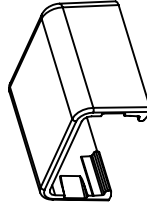

- NOTES:
- SEE CURRENT CATALOG FOR ADDITIONAL PART NUMBER SUFFIXES TO INDICATE COLOR AND OR PACKAGE QUANTITY.
 - THIS PRODUCT IS INTENDED TO BE USED WITH PANDUIT TYPE LDP3, LD3 AND LDS3 RACEWAY.
 - NOMINAL WALL THICKNESSES: .055(1.4).
 - DIMENSIONS IN PARENTHESIS ARE IN METRIC.

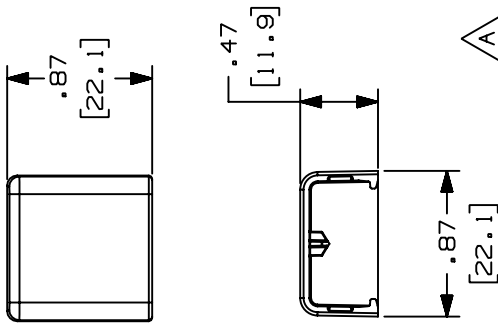

CAD FILENAME/LAYERS D35541CH_LLD_ECFX3_02.PRT

PANDUIT		CORP. TINLEY PARK, ILLINOIS								
END CAP FITTING COVER (ECFX3)		CUSTOMER DRAWING								
UNLESS OTHERWISE SPECIFIED, DIMENSIONAL TOLERANCES ARE: (.X) ± (.XXX) ±.015 (.4) (.XX) ±.03 (.8) ANGLES ±		UNLESS OTHERWISE SPECIFIED, ALL DIMENSIONS ARE GIVEN IN INCHES, THIRD ANGLE PROJECTION.								
DRAWN BY	JBA	MAT'L:	NONE							
DATE	09-23-96	SCALE	NONE							
CHECKED BY	CEF	DRAWING NO.	35541-34							
REV	DATE	BY	CHK	DESCRIPTION	ECN	CHK	CUST	SUP	DWG	SIZE
2	03-10-04	JHEP	RGRO	B. REVISED CD3 FROM NOTE 2	35541-34	RGRO	RGRO			A
1	05-18-99	DW	H1W	A. REVISED DWG TO SHOW 2D VIEWS	35541-34	H1W	H1W			
R	09-23-96	JBA	CEF	RELEASED TO PRODUCTION	35541-34	CEF	CEF			

+

+