

THIS DOCUMENT IS THE PROPERTY OF
KEYSTONE ELECTRONICS CORP. AND
SHALL NOT BE REPRODUCED, DISTRIBUTED
OR USED AS A BASIS FOR MANUFACTURE
WITHOUT PRIOR WRITTEN PERMISSION
FROM KEYSTONE ELECTRONICS CORP.

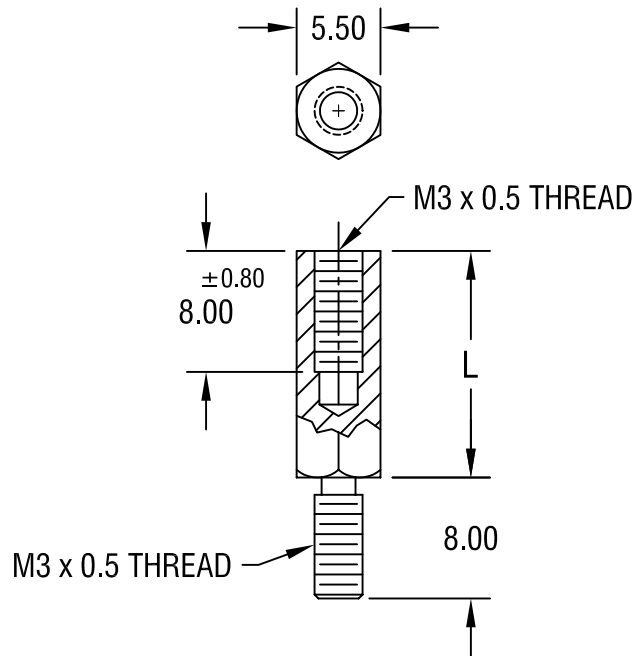

| PART NO. | 'L' DIM. |
|----------|----------|
| 24295 | 10.00 |
| 24296 | 12.00 |
| 24297 | 15.00 |
| 24298 | 18.00 |
| 24299 | 20.00 |
| 24300 | 25.00 |

NOTE:

1. ALL DIMENSIONS ARE IN MILLIMETERS

| KEYSTONE ELECTRONICS CORP. | | | |
|-----------------------------------|------------|------------------------|--------------------|
| ASTORIA, N.Y. 11105-2017 | | | |
| PART NAME | | 5.5mm M/F HEX STANDOFF | |
| MATERIAL | | STAINLESS STEEL | |
| FINISH | - | DRN BY | BOONE |
| | | DATE | 5.8.06 |
| | | APP'D | LN |
| | | SCALE | 2X |
| TOLERANCES | INCH [MM] | CODE | DWG NO. |
| DECIMAL | ± [± 0.15] | C/M | 24295-24300 |
| ANGULAR | ± 1° | | |
| UNLESS OTHERWISE SPECIFIED | | | |

| DATE | DESCRIPTION | REV. |
|------|-------------|------|
| | | |