

THIS COPY IS PROVIDED ON A RESTRICTED BASIS AND IS NOT TO BE USED IN ANY WAY DETRIMENTAL TO THE INTERESTS OF PANDUIT CORP.

PANDUIT PART NUMBER	WEIGHT
FR24TBE12 FR24TBE12M	4.12 LB/EACH (1869g/EACH)

NOTES:

1. SEE CURRENT CATALOG FOR ADDITIONAL PART SUFFIXES TO INDICATE PACKAGE QUANTITY.
2. THE FIBERRUNNER 24x4 QUIKLOCK TRAPEZE BRACKET IS USED TO SUPPORT THE FIBERRUNNER 24x4 CABLE ROUTING SYSTEM BETWEEN TWO (2) SECTIONS OF EXISTING 1/2" (M12) THREADED ROD THAT ARE 27" (685.8) - 31.5" (800.1) APART.
3. THE FIBERRUNNER 24x4 QUIKLOCK TRAPEZE BRACKET - EXISTING 1/2" (M12) THREADED ROD INCLUDES: ONE (1) BRACKET ASSEMBLY, FOUR (4) 1/2-13 SPLIT LOCK NUTS (FR24TBE12 ONLY), FOUR (4) M12x1.75 SPLIT LOCK NUTS (FR24TBE12M ONLY).
4. FINISH COLOR: BLACK (EXCEPT FOR HARDWARE)
5. DIMENSIONS IN PARENTHESES ARE IN METRIC.

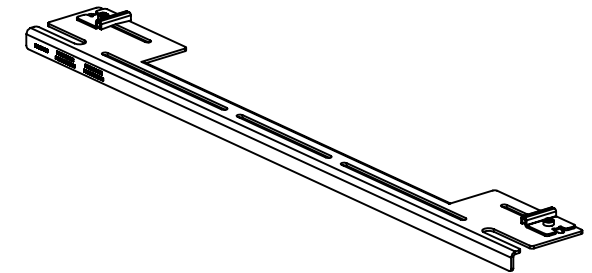
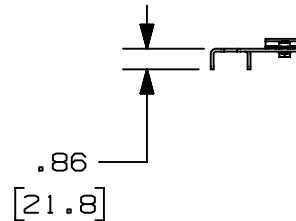
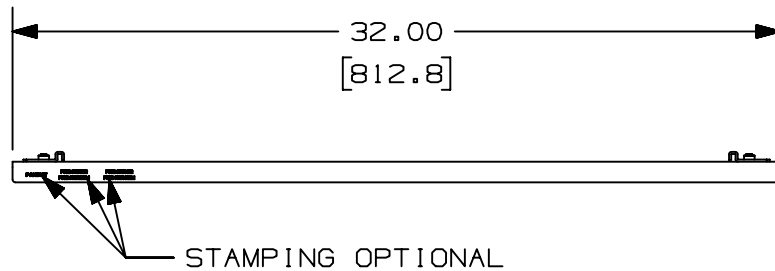
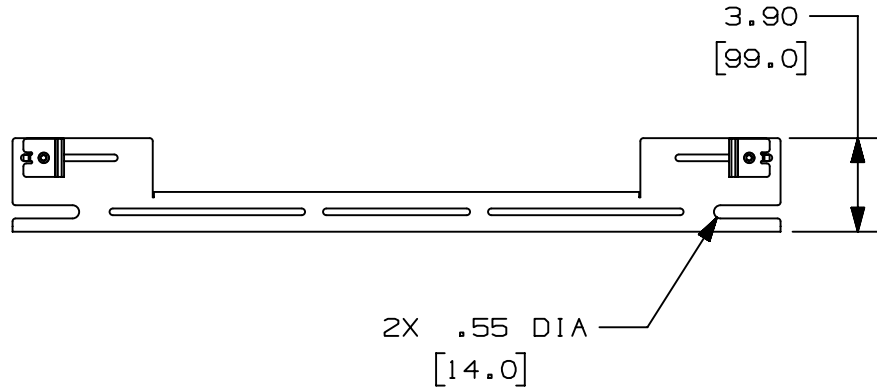

TITLE		FIBERRUNNER 24x4 QUIKLOCK TRAPEZE BRACKET - EXISTING 1/2" (M12) THREADED ROD (FR24TBE12, FR24TBE12M)				
		CUSTOMER DRAWING				
ITEM REVISION NAME		D39701CR/00				
DATASET FILE NAME		D39701CR_DC/00B				
UNLESS OTHERWISE SPECIFIED, DIMENSIONAL TOLERANCES ARE:						
(.X) ± (.XX) ± .03 (.8)      (.XXX) ± ANGLES ±						
DRAWING NUMBER:		39701-47				
REV	DATE	BY	CHK	SCALE	SHT 1 OF 1	SIZE
MS0	10-21-08	SL	NONE	A		

00B	11-18-19	MES	FWI	FWI	B. ADDED STAMPING OPTIONAL NOTE A. UPDATED TITLE BLOCK TO LATEST REVISION REMOVED PRIOR REVISIONS	V09002CN/07
REV	DATE	BY	CHK	APR	DESCRIPTION	ECN

D10.100DA/20