

# CnC Tech, LLC

## Industrial Cable and Connector Technology

## Engineer drawing

|             |                          |      |       |       |
|-------------|--------------------------|------|-------|-------|
| PART NO.    | JLL-301                  | WIRE | SCALE | 1 : 1 |
| DESCRIPTION | SJT#16*3C 105C SHIELDED  |      | UNIT: | mm    |
| DWG No.     | 800-1601-2-SJT0-BL-00150 |      |       |       |

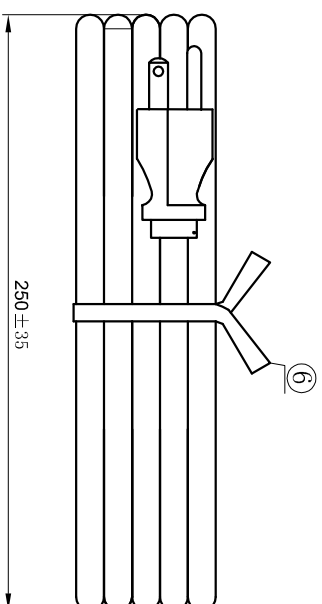
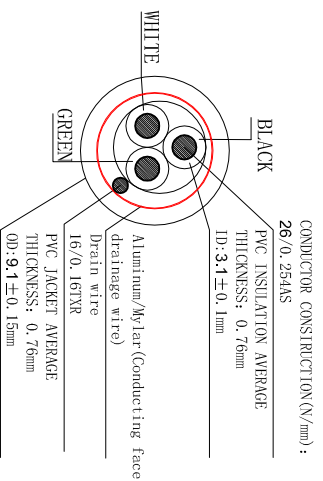
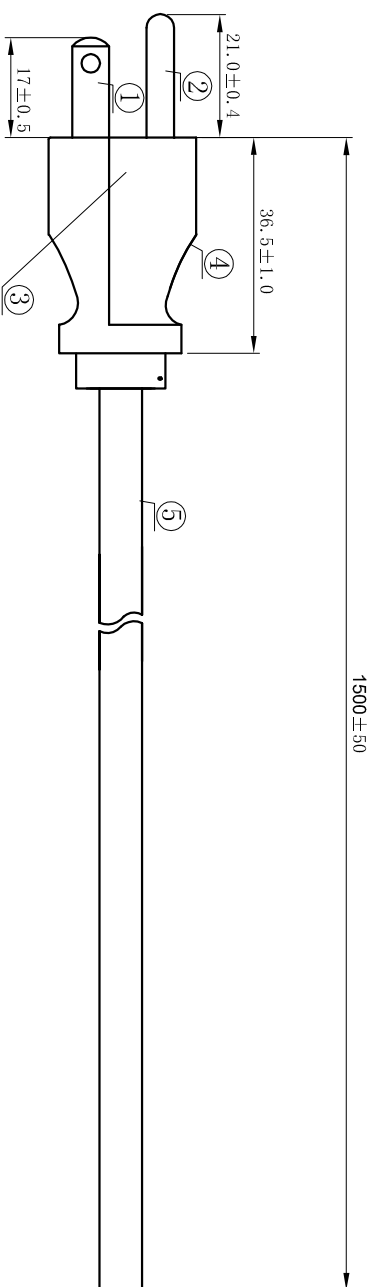
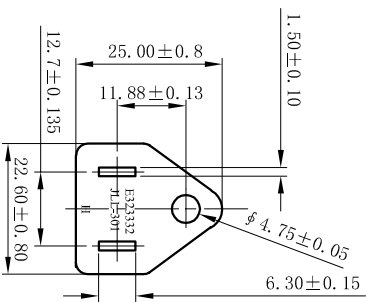

### NOTES:

- 1) JACKET COLOR: BLACK
  - 2). E-GREEN ; L-BLACK ; N-WHITE
- TESTING:
- 1) 100% OPEN & SHORT TESTING
  - 2) INSULATION RESISTANCE: 100M ohm (min)
  - 3) VOLTAGE: DC500V/1min
  - 4) ROHS COMPLIANT

Printing the contents of wire The use of printing ink replenish Wire

E243929 (UL) SJT 3X16MM(4.31mm²) VW-1 SHIELDED 105°C 300V CSA 228191 S  
 JT 3X16MM(4.31mm²) F72 SHIELDED 105°C 300V -LP-

| NO. | SPECIFICATION            | COLOUR | MATERIAL | AMOUNT |
|-----|--------------------------|--------|----------|--------|
| ①   | Load terminals 98861     | Silver | Cu       | 2P     |
| ②   | Grounding terminal 97475 | Silver | Cu       | 1P     |
| ③   | Model aircraft 8661AW-3P | WHITE  | PBT      | 1PCS   |
| ④   | Plug JLL-301             | BLACK  | PVC Cu   | 1PCS   |
| ⑤   | Wire SJT 16MM/3C 105°    | BLACK  | PVC Cu   | 1PCS   |
| ⑥   | Ties                     | BLACK  |          | 1PCS   |

| REV           | DATE            | DESCRIPTION | SYMBOL |
|---------------|-----------------|-------------|--------|
| DRAWN/DATE    | CHECKED/DATE    |             |        |
| GONG/10.11.04 | ZHUYING/10.11.4 |             |        |