

THIS DOCUMENT IS SUBJECT TO CHANGE WITHOUT NOTICE. IT IS CONFIDENTIAL AND A PROPERTY OF Amphenol LTW. DISCLOSURE TO THIRD PARTY HAS TO BE AUTHORIZED BY Amphenol LTW.

REV.	ECN NO.	DATE	SIGN	DESCRIPTION
B	LEN1770147	2017/07/11	Vicky	Update Note

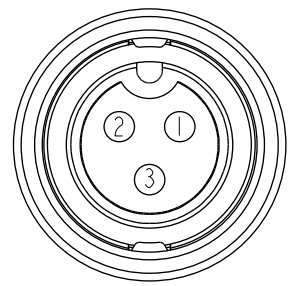
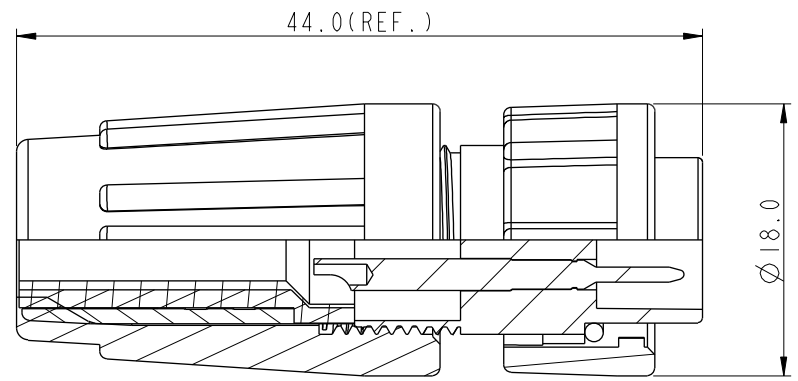
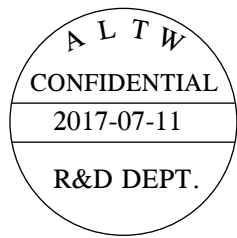
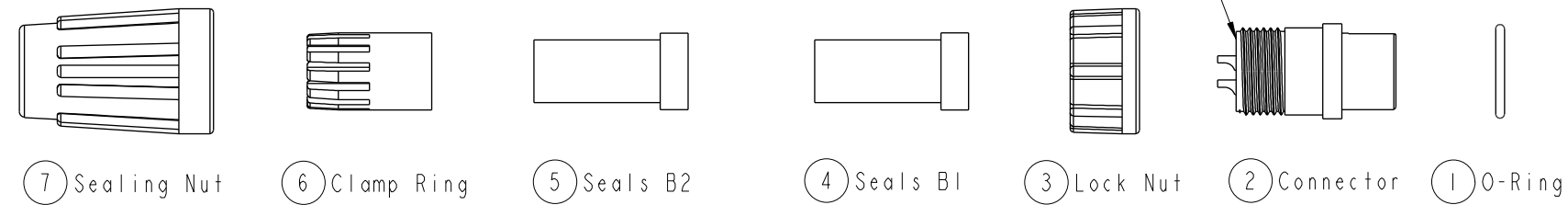

Pin Assignments
Front View 前視圖

Note:

- * Ⓞ Important Dimension
- * Waterproof Rate: IP66
- * Ring: EPDM, Black
- * Housing: Nylon+GF, Black
- * Male Pin: Copper Alloy, Gold Plated
- * Lock Nut: Nylon+GF, Black
- * Seals: EPDM, Black
- $\triangle B$ * Clamping Ring: Nylon+GF, Black
- $\triangle B$ * Sealing Nut: Nylon+GF, Black
- * PE Bag: 90mm*85mm
- * Liquid Glue: Clear
- * Seals B1 for Cable OD: $\varnothing 4.5\text{mm} \sim \varnothing 6.5\text{mm}$
(防水墊圈B1線徑: $\varnothing 4.5\text{mm} \sim \varnothing 6.5\text{mm}$)
- * Seals B2 for Cable OD: $\varnothing 3.5\text{mm} \sim \varnothing 5.3\text{mm}$
(防水墊圈B2線徑: $\varnothing 3.5\text{mm} \sim \varnothing 5.3\text{mm}$)
- * One Set Unassembled in One PE Bag
(每一組未組裝, 放置於一個PE袋, 並封口)

UNIT: mm			TITLE Standard, Assy Lock 3Pin F Conn M Pin		
	TOLERANCE	±0.25	SCALE	1:1	SIZE
	.X	±0.1	REV.	B	WC-REV.
	.XX	±0.05	WC-REV.	A.2	Ⓞ : Inspection item
.XXX	±0.05	REV.	B	WC-REV.	A.2
ANGLES	±1°	REV.	B	WC-REV.	A.2

Amphenol LTW
安費諾亮泰企業股份有限公司

ITEM NO. BD-03BFMA-LL6001	DRAWN BY Vicky	DATE 2017-07-11
DWG NO. BD-03BFMA-LL6001	CHECKED BY Rita	DATE 2017-07-11
CUSTOMER ALTW	APPROVED BY Max	DATE 2017-07-11