

PLEASE CHECK WWW.MOLEX.COM FOR LATEST PART INFORMATION

Part Number: **0191640040**
Status: **Active**
Overview: Snap Plugs and Receptacles
Description: Perma-Seal Male Snap Plug for 14-16 AWG Wire, Diameter 3.96mm

Documents:

Drawing (PDF)	Product Specification PS-19902-011-001 (PDF)
3D Model	Product Specification PS-19902-013-001 (PDF)
3D Model (PDF)	RoHS Certificate of Compliance (PDF)

Agency Certification

CSA	LR18689
UL	E152602

General

Product Family	Quick Disconnects
Series	<u>19164</u>
Crimp Quality Equipment	Yes
Insulated	Partial
Overview	<u>Snap Plugs and Receptacles</u>
Product Name	Perma-Seal
Type	Snap Plug
UPC	800753113251

Physical

Barrel Type	Closed
Color - Resin	Blue
Gender	Male
Glow-Wire Capable	No
Insulation	NiAc
Lock to Mating Part	None
Material - Metal	Copper Alloy
Material - Plating Mating	Tin
Material - Plating Termination	Tin
Net Weight	1.343/g
Orientation	Straight
Packaging Type	Bag
Tab Thickness	N/A
Tab Width	N/A
Temperature Range - Operating	-55° to +125°C
Wire Insulation Diameter	6.71mm max.
Wire Size AWG	14, 16

Electrical

Voltage - Maximum	600V
-------------------	------

Material Info

Engineering Number	SB-289
--------------------	--------

Reference - Drawing Numbers

Product Specification	PS-19902-011-001, PS-19902-013-001
Sales Drawing	SD-19164-031-001

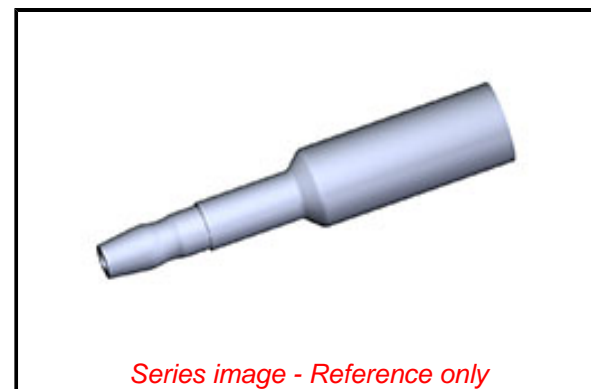

EU ELV

Not Relevant

EU RoHS

Compliant

REACH SVHC

Not Contained Per -
D(2021)4569-DC (8
July 2021)

Halogen-Free

Status

Low-Halogen

For more information, please visit [Contact US](#)

China ROHS

ELV

RoHS Phthalates

China RoHS

Green Image

Not Relevant

Not Contained

Search Parts in this Series

19164 Series

Application Tooling | FAQ

Tooling specifications and manuals are found by selecting the products below. Crimp Height Specifications are then contained in the Application Tooling Specification document.

Global

Description	Product #
PremiumGrade Hand Crimp Tool for Insulkrimp Terminals and Splices, 10-22 AWG (Rings, Spades, Hooks, Block Spades and Flanged Spades)	<u>640010300</u>
Crimp Head for the AT-200 Pneumatic Hand Tool	<u>640050300</u>

PLEASE CHECK WWW.MOLEX.COM FOR LATEST PART INFORMATION