

RoHS COMPLIANT

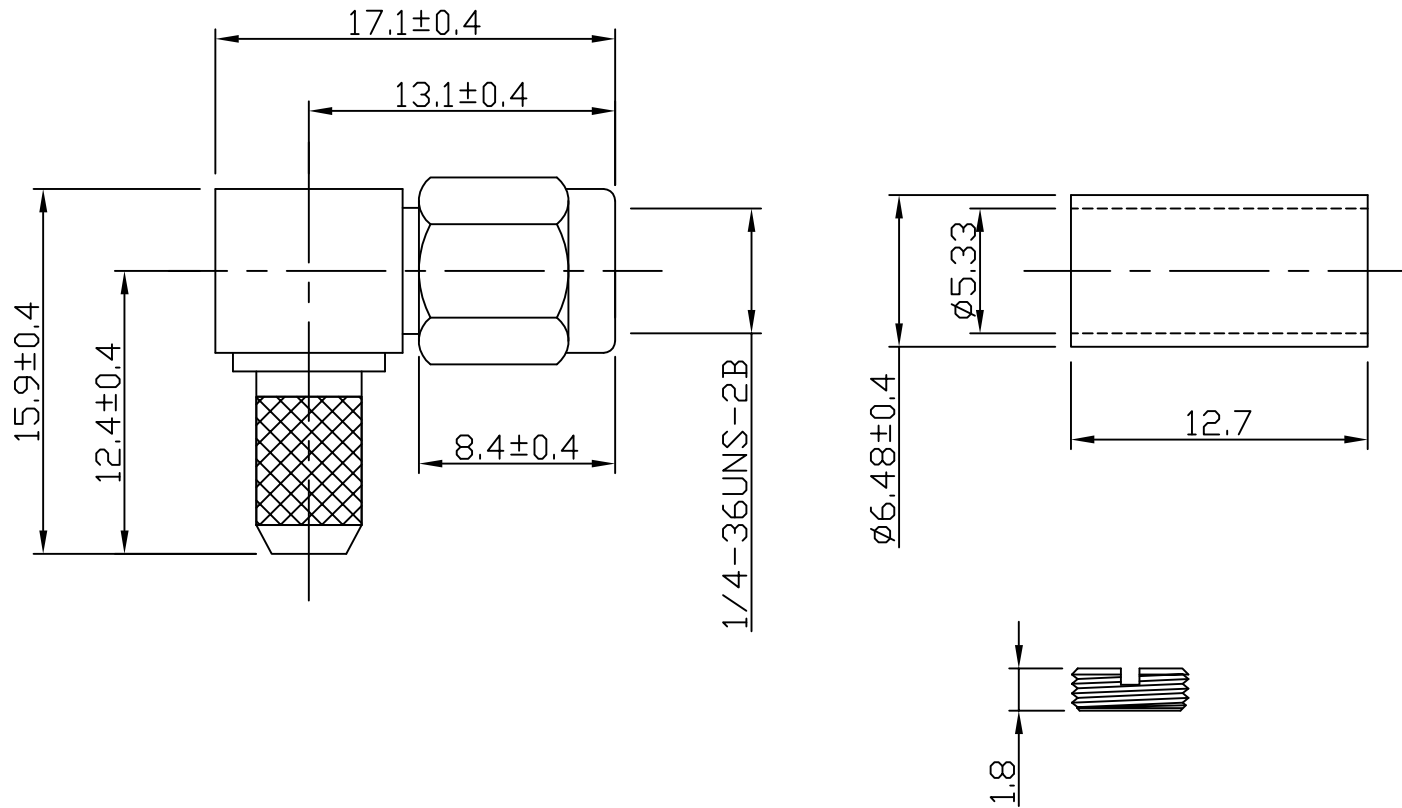

Electrical Characteristics

Nominal Impedance:	50 ohms
Frequency Range:	DC to 12.4 GHz
VSWR:	1.3:1 maximum
Insertion Loss:	0.2 dB at 6 GHz
Operating Voltage (rms):	500 V maximum at sea level
Dielectric Withstand Voltage (rms):	1000 V maximum at sea level
Contact Resistance:	2.0 milliohms maximum
Insulation Resistance:	5000 megohms minimum

Mechanical Characteristics

Mating Cycles:	500 cycles minimum
Interface Dimensions:	Conform to MIL-C-39012

Environmental Characteristics

Temperature Range:	-65 °C to +165 °C
--------------------	-------------------

	PART	DESCRIPTION
1	Body	Brass, nickel plated
2	Insulator	PTFE
3	Contact	Brass, gold plated
4	Cap	Brass, nickel plated
5	Gasket	Silicone, red

First Issue	SN	1	10 Jul 02
DESCRIPTION OF REVISION	APPVD	ISS	DATE

For stripping and assembly instructions see Drawing Number: VAIS2101



Cinch Connectivity Solutions
7-13 Russell Way,
Widford Industrial Estate,
Chelmsford, Essex,
CM1 3AA, UK.
Tel: +44 (0) 1245 359515
Fax: +44 (0) 1245 358938

SCALE: Not To Scale
DIMENSIONS: mm
TOLERANCES:
± 0.2mm unless
otherwise stated

DRAWN BY:	S Nash
CHECKED BY:	
APPROVED BY:	
DATE:	10 Jul 02

TITLE:
SMA R/A Crimp Plug for RG58

PART NUMBER:
VS20-2051

PAGE: 1 of 1