

CFP2

- Terminal Pins: Straight
- Actuator Color: Gray

Ultra-Miniature Pushbutton Switches

Washable

RoHS Compliant

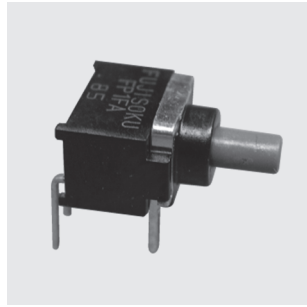

Features

1. Ultra-miniature pushbutton switch for high density mounting.
2. Washable.
3. Terminal pin pitch: 2.54 mm.
4. Independent detent mechanism ensures light operational feel.
5. Clip contact mechanism for long-term contact reliability.
6. Gold-plated contacts.

Specifications

| | | |
|-----------------------------|--|--------------------|
| Rating | Max. | 0.4VA (28VDC max.) |
| | Min. | 1μA 20mVDC |
| Initial contact resistance | 100m Ω max. (1.5mA 200μVAC) | |
| Dielectric strength | 250VAC 1 minute | |
| Insulation resistance | 500MΩ min. (250VDC) | |
| Electrical life | 10,000 operations at max.rating, 30,000 operations at min.rating, | |
| Mechanical life | 30,000 cycles | |
| Operating force | 1.47 ± 0.98N | |
| Operating temperature range | -40~+85°C | |
| Storage temperature range | -40~+85°C | |

Part Numbering

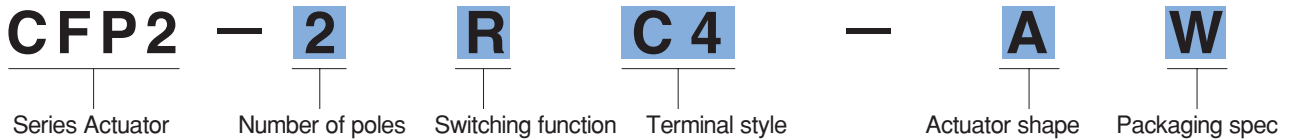

| Code | Type |
|----------|------------|
| P | Pushbutton |

| Fig. | Number of poles |
|----------|-----------------|
| 1 | 1 pole |
| 2 | 2 poles |

| 1 pole | 2 poles | Switching function |
|----------|----------|--------------------|
| F | R | ON — (ON) |

| Fig. | Terminal style |
|-----------|-------------------|
| C | P/C |
| C4 | Right angle |
| C6 | Vertical mounting |

| Code | Actuator shape |
|----------|----------------|
| A | Standard |

| Code | Packaging spec |
|----------|----------------|
| W | Tray |

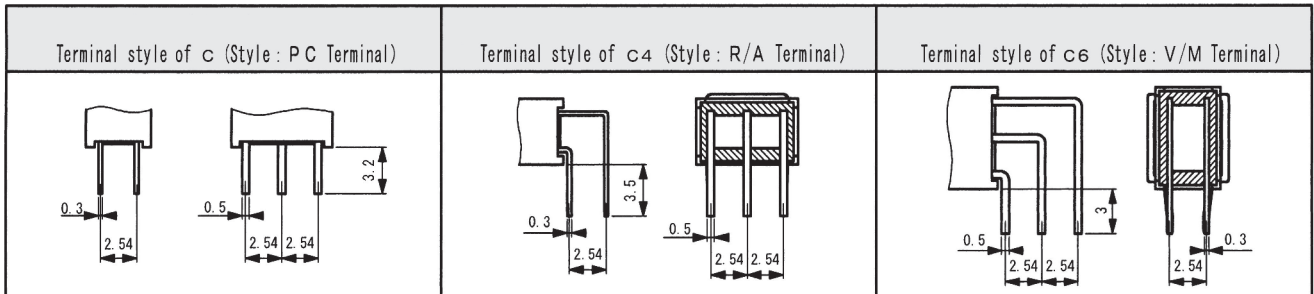

SPDT

V/M

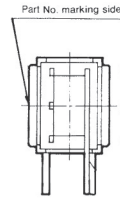
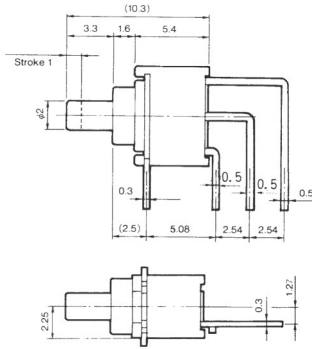
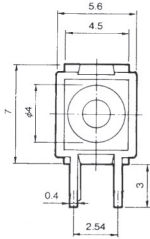
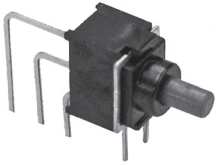

| Switching function | Switching function | |
|----------------------|---------------------|------|
| | | |
| Part No. | CFP2-1FC6-AW | |
| ON | ON | (ON) |
| Connecting terminals | 5-6 | 5-4 |

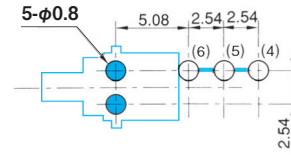

(Top view)
PC Hole Layouts

Terminal numbers are not shown on the switch.

DPDT

V/M

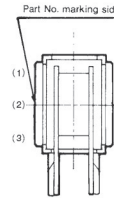
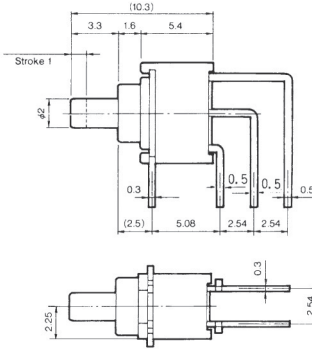
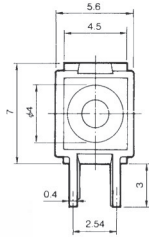
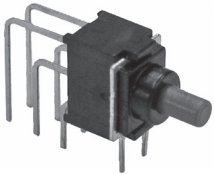

| Switching function | Switching function | |
|----------------------|-----------------------|------------|
| | | |
| Part No. | ☆ CFP2-2RC6-AW | |
| ON | ON | (ON) |
| Connecting terminals | 2-3 5-6 | 2-1 5-4 |

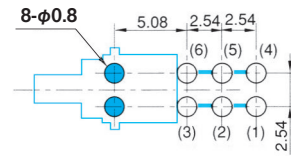

(Top view)
PC Hole Layouts

Terminal numbers are not shown on the switch.

※ The above pcb hole dimengion, it is a top view drawing when we fix the switch.

Handling Specifications (CFP2)

1. Soldering Specifications

- (1)Manual Soldering
 - Device : Soldering iron
 - 350°C, Max.; 3 seconds, Max.
- (2)Auto Soldering
 - Device : Jet wave type or dip type
 - 260°C, Max.; 3-5 seconds, Max. (One time)
 - Total dip time: Within 10 seconds
 - Pre-heating should be done at temperatures from 80°C to 120°C and within 120 seconds
- (3)When soldering two or more terminals to a common land, use solder resist to separate them

2. Flux Cleaning

- (1)Solvents : Fluorine or Alcohol type
- (2)Cleaning after soldering should be done after the PC board is exposed to room temperature (30°C or below) for 1 to 2 hours.
- (3)Do not use ultrasonic cleaning.

Packaging Specifications

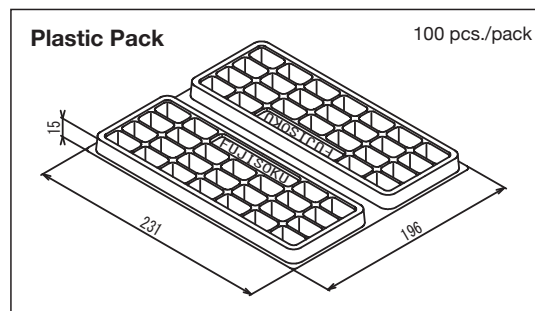

The blue line shows the outline of the switch.

(ON) : Momentary.

☆ : Semi-standard products.