

# 1M-Series

Miniature Rockers & Paddles

[PRODUCT WEBPAGE](#)

*request sample, configure part*

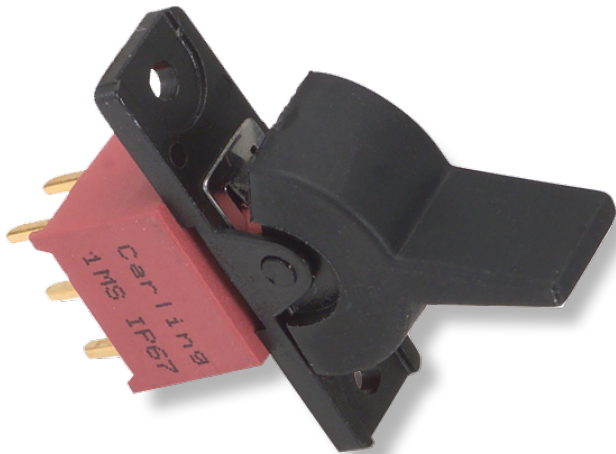

The 1M family of miniature rocker & paddle switches is composed of two switch series; the 1M1-Series miniature rocker and paddle switch, and the 1MS-Series sealed miniature rocker and paddle switch. Both products feature PC mounting and offer a variety of ratings, circuits, contact materials, terminal platings, rocker and paddle actuator styles and colors.

**1-3** Poles    **.4-5** Amps    **125, 250** VAC    **28** VDC

## Typical Applications

- Instrumentation
- Test Equipment
- Telecommunications
- Networking
- Handheld Appliances
- Medical Equipment

# Tech Specs

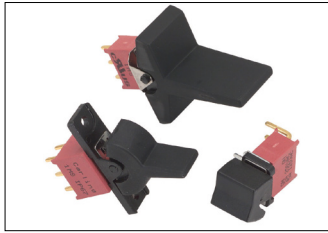

**IMS-Series  
Sealed**  
Miniature Rocker  
& Rocker Switch

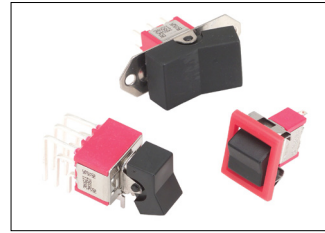

**IMI-Series**  
Miniature Rocker  
& Rocker Switch

## Electrical

Contact Rating	refer to ordering scheme
Electrical Life	<b>IMS-Series:</b> 30,000 make & break cycles @ full load <b>IMI-Series:</b> 50,000 make & breakcycles @ full load
Contact Resistance	10 mΩ max. initial @ 2-4 VDC 100mA for both silver & gold plated contacts
Insulation Resistance	1000 MΩ min.
Dielectric Strength	1500 Volts RMS @ sea level

## Physical

Operating Temperature	-30°C to +85°C
Index of Protection	IMS-Series: IP67
Solder Heat Resistance	MIL-STD-202, Method 210
Actuator Travel	25°

## Material

Case	<b>IMS-Series:</b> Glass filled nylon 6/6, flame retardant, heat stabilized (UL 94V-0) <b>IMI-Series:</b> Diallyl phthalate (DAP) (UL 94V-0)
Rocker/Paddle	<b>IMS-Series:</b> Nylon, black standard, internal o-ring sealed <b>IMI-Series:</b> Nylon (UL 94V-0)
Bushing	<b>IMS-Series:</b> Glass filled nylon 6/6, flame retardant, heat stabilized (UL 94V-0) <b>IMI-Series:</b> Brass, nickel plated
Housing	<b>IMS-Series:</b> Spring Steel <b>IMI-Series:</b> Stainless Steel
Actuator Pivot & Mounting Bracket	<b>IMS-Series:</b> Nylon (UL 94V-0) <b>IMI-Series:</b> Stainless Steel
Actuator Pivot Retainer	<b>IMS-Series:</b> Stainless Steel
Switch Support	Brass, tin plated
Terminal Seal	Epoxy

# Ordering Schemes

Sample Part Number

**IMS - SP 1 - R6 / 2 M6 G E**

Selection 1 2 3 4 5 6 7 8

## 1. SERIES

**IMS** Sealed Miniature Rocker Switch

## 2. POLES

**SP** Single pole - uses terminals 1, 2 & 3  
**DP** Double pole uses terminals 1, 2, 3, 4, 5 & 6  
**3P** Three pole uses terminals 1, 2, 3, 4, 5, 6, 7, 8 & 9

## 3. CIRCUIT

( ) - momentary  
**Position:** **1** **2** **3**  
 2-3, 5-6, 8-9 Connected Terminals 2-1, 5-4, 8-7

1	ON	NONE	ON
2	ON	NONE	(ON)
3	ON	OFF	ON
4	(ON)	OFF	(ON)
5	ON	OFF	(ON)
6*	ON	ON	ON
7*	(ON)	ON	(ON)
8*	ON	ON	(ON)
9*	OFF	ON	(ON)

\*Center Position Connects 2-3, 5-4, 8-9

## 4. ACTUATOR STYLE

**R1** Standard Rocker **R5** Large Rocker  
**R2** Standard Paddle **R6** Small Rocker  
**R3** Medium Rocker **R7** Medium Paddle  
**R4** Large Paddle

## 5. ACTUATOR COLOR

**1** White **2** Black **3** Red  
 Black is standard. Other colors available, consult factory.

## 6. TERMINATION

<b>M1</b> Solder Lug	<b>VS2</b> PC Mount, U bracket
<b>M2</b> PCB	<b>VS3</b> PC Mount, U bracket
<b>M3</b> Quick Connect	<b>VS4</b> PC Mount, U bracket
<b>M51</b> Wire Wrap	<b>VS5</b> PC Mount, U bracket
<b>M52</b> Wire Wrap	<b>VS21</b> Snap-In, U bracket
<b>M53</b> Wire Wrap	<b>VS31</b> Snap-In, U bracket
<b>M54</b> Wire Wrap	<b>VS41</b> Snap-In, U bracket
<b>M6</b> PC Mount, 90° horizontal	<b>VS51</b> Snap-In, U bracket
<b>M7</b> PC Mount, 90° vertical	<b>U2</b> Vertical Mount, 3-Pole
	<b>U4</b> Snap-In, U bracket, 3-Pole

See dimensional specifications.

## 7. CONTACTS / TERMINALS

Contact Material	Terminal Plating	Rating	Approvals
<b>G</b> silver <sup>1</sup>	gold over silver 2A	5A 125VAC or 28VDC, 250VAC	us, IP67
<b>K</b> gold <sup>2,5</sup>	tin <sup>4</sup>	0.4VA max 20V max (AC/DC)	IP67
<b>P</b> silver <sup>1,6</sup>	tin <sup>4</sup>	5A 125VAC or 28VDC, 250VAC	us, IP67
<b>R</b> gold <sup>2</sup>	gold <sup>3</sup>	0.4VA max 20V max (AC/DC)	IP67

## 8. EPOXY SEAL

**E** Epoxy Seal **0** without Epoxy Seal

Notes:

- Tin option not available with M1 and M3 terminals.
- 1 Movable contact and terminal platings: silver over copper alloy
- 2 Movable contact platings: gold over nickel over copper alloy
- 3 Terminal platings: gold over nickel over copper alloy
- 4 Terminal platings: tin over copper alloy
- 5 Terminal contact platings: gold over nickel alloy
- 6 Terminal contact platings: silver over nickel alloy

[Configure Complete Part Number >](#)

[Browse Standard Parts >](#)

Sample Part Number

**IMI - SP 1 - R8 / 2 - 2 M6 Q E**

Selection 1 2 3 4 5 6 7 8 9

## 1. SERIES

**IMI** Miniature Rocker Switch

## 2. POLES

**SP** Single pole - uses terminals 1, 2 & 3  
**DP** Double pole uses terminals 1, 2, 3, 4, 5 & 6  
**3P** Three pole uses terminals 1, 2, 3, 4, 5, 6, 7, 8 & 9  
**4P** Four pole uses terminals 1, 2, 3, 4, 5, 6, 7, 8, 9, 10, 11, 12

## 3. CIRCUIT

( ) - momentary  
**Position:** **1** **2** **3**  
 2-3, 5-6, 8-9, 11-12 Connected Terminals 2-1, 5-4, 8-7, 11-10

1	ON	NONE	ON
2	ON	NONE	(ON)
3	ON	OFF	ON
4	(ON)	OFF	(ON)
5	ON	OFF	(ON)
6 <sup>1</sup>	ON	ON	ON
7 <sup>1</sup>	(ON)	ON	(ON)
8 <sup>1</sup>	ON	ON	(ON)
9 <sup>2</sup>	NONE	ON	(ON)

## 4. ACTUATOR STYLE

**R1** Standard Rocker **R6** Rocker & frame  
**R2** Standard Paddle **R7** Paddle & frame  
**R3** Medium Rocker **R8** Rocker without frame  
**R4** Large Paddle **R9** Paddle without frame  
**R5** Large rocker

## 5. ACTUATOR COLOR / 6 FRAME COLOR

**0** No Frame\* **2** Black  
**1** White **3** Red  
 Black is standard. Other colors available, consult factory.  
 \*Actuator style R8 or R9 only.

## 7. TERMINATION

<b>M1</b> Solder Lug	<b>VS3</b> PC Mount, U bracket
<b>M2</b> PCB	<b>VS4</b> PC Mount, U bracket
<b>M3</b> Quick Connect	<b>VS5</b> PC Mount, U bracket
<b>M51</b> Wire Wrap	<b>M61</b> Snap-In, U bracket, 90° horizontal
<b>M52</b> Wire Wrap	<b>M71</b> Snap-In, U bracket, 90° vertical
<b>M53</b> Wire Wrap	<b>VS21</b> Snap-In, U bracket
<b>M54</b> Wire Wrap	<b>VS31</b> Snap-In, U bracket
<b>M6</b> PC Mount, 90° horizontal	<b>VS41</b> Snap-In, U bracket
<b>M7</b> PC Mount, 90° vertical	<b>VS51</b> Snap-In, U bracket
<b>VS2</b> PC Mount, U bracket	<b>U4</b> Snap-In, U bracket, 3-Pole

See dimensional specifications.

## 8. CONTACTS / TERMINALS

Contact Material	Terminal Plating	Rating	Approvals
<b>G</b> silver <sup>3</sup>	gold over silver 2A	5A 125VAC or 28VDC, 250VAC	
<b>K</b> gold <sup>4,7</sup>	tin <sup>6</sup>	0.4VA max 20V max (AC/DC)	N/A
<b>P</b> silver <sup>3,8</sup>	tin <sup>6</sup>	5A 125VAC or 28VDC,	
<b>Q</b> silver <sup>3</sup>	2A 250VAC silver <sup>3</sup>	5A 125VAC or 28VDC,	
<b>R</b> gold <sup>4</sup>	2A 250VAC gold <sup>5</sup>	0.4VA max 20V max (AC/DC)	N/A

## 9. EPOXY SEAL

**E** Epoxy Seal **0** without Epoxy Seal

Notes:

- Tin option not available with M1 and M3 terminals.
- 1 Double-Pole and Four-Pole only. Center position connects 2-3, 5-4, 8-9, 11-10
- 2 Double-Pole only
- 3 Movable contact and terminal platings: silver over copper alloy
- 4 Movable contact platings: gold over nickel over copper alloy
- 5 Terminal platings: gold over nickel over copper alloy
- 6 Terminal platings: tin over copper alloy
- 7 Terminal contact platings: gold over nickel alloy
- 8 Terminal contact platings: silver over nickel alloy

[Configure Complete Part Number >](#)

[Browse Standard Parts >](#)

# Dimensional Specs

inches [millimeters]

## Single Pole

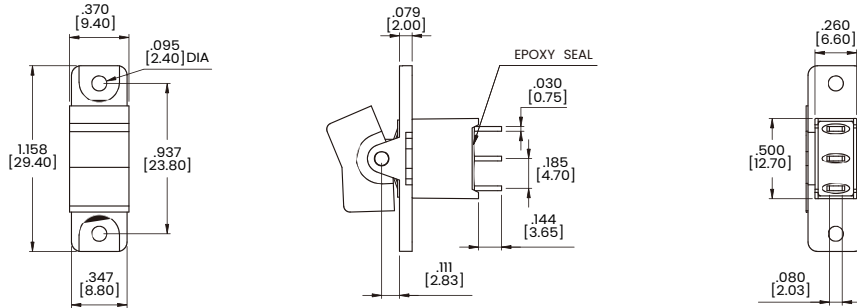

## Double Pole

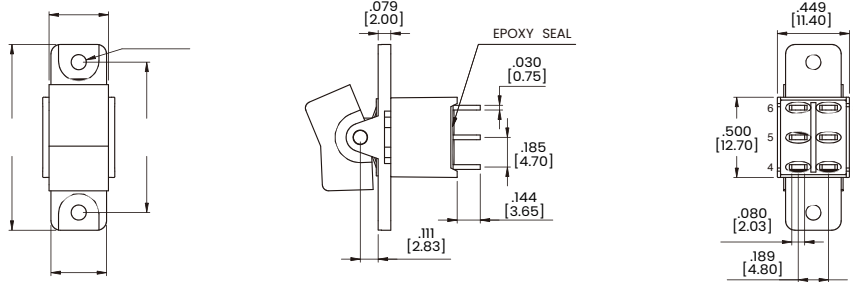

## Three Pole

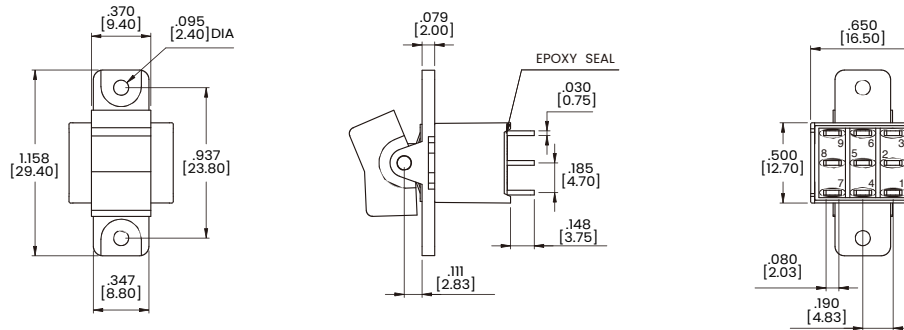

## Actuator Options for Panel Rear Mount

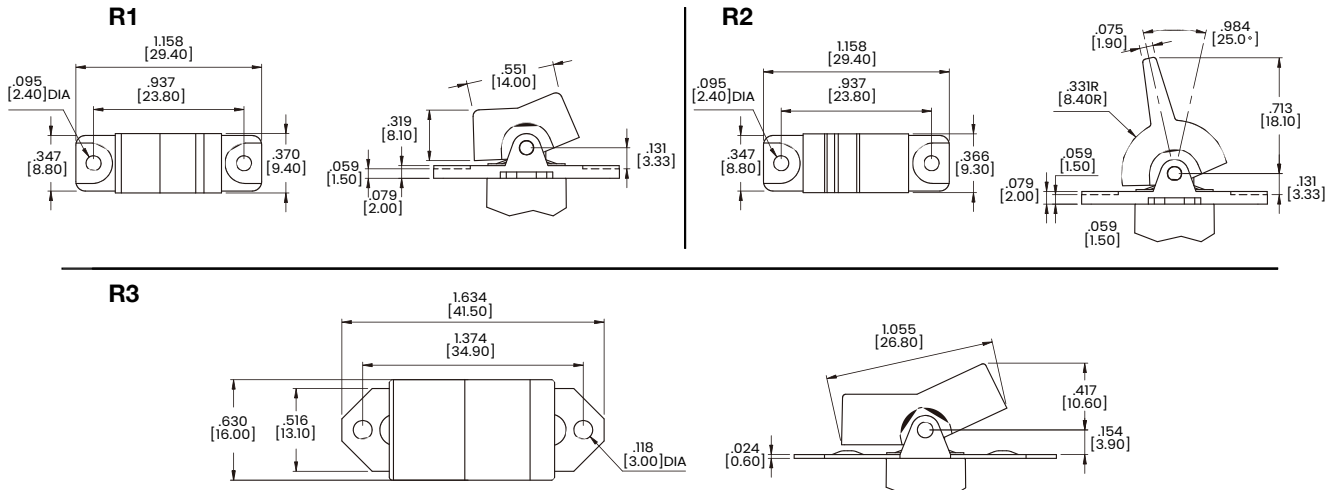

# Dimensional Specs

inches [millimeters]

## Actuator Options for Panel Rear Mount

**R4**

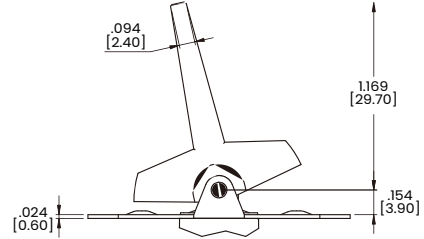
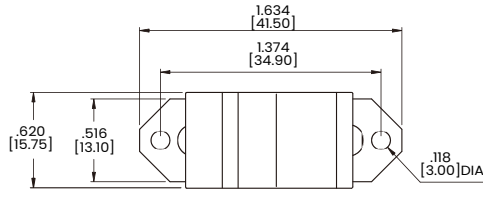

**R5**

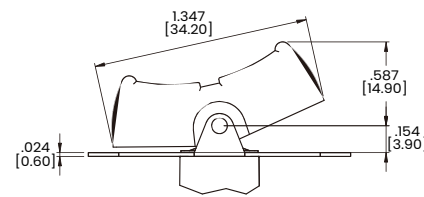
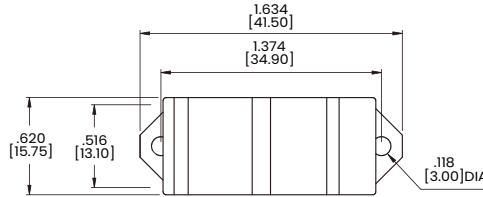

**R6**

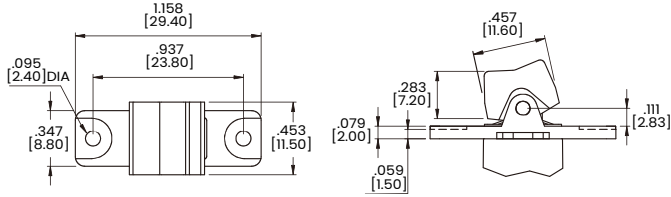

**R7**

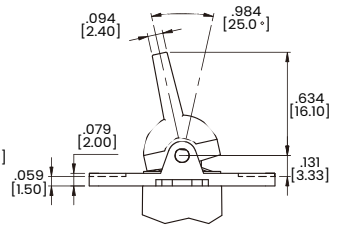
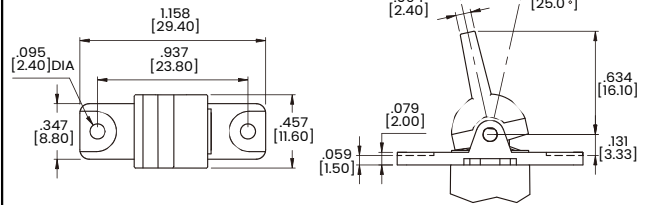

## Actuator Options for PC Mount

**R1**

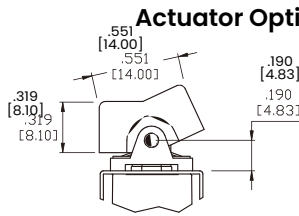

**R2**

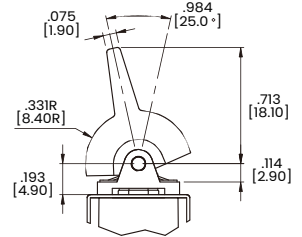

**R3**

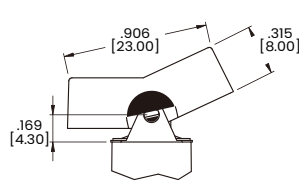
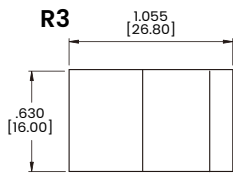

**R4**

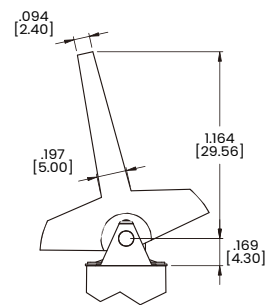
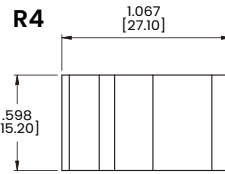

**R5**

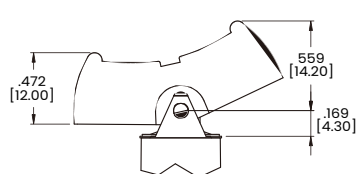
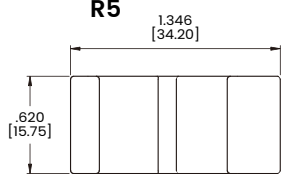

**R6**

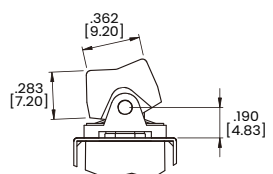
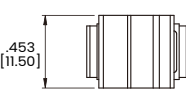

# Dimensional Specs

inches [millimeters]

## Actuator Options for PC Mount

R7

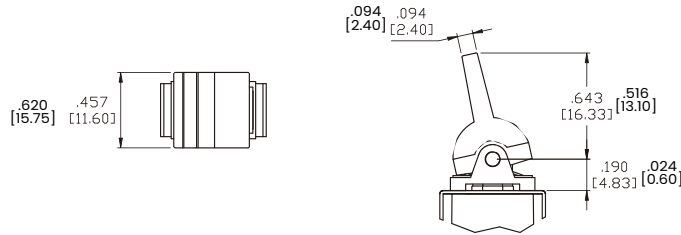

## Termination Options

M1 Standard Solder Lug

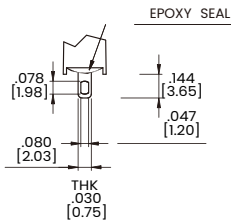

M2 PC Thru-Hole

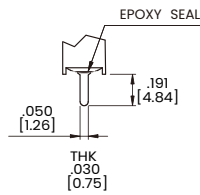

M3 Quick Connect

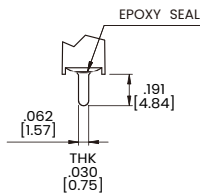

M5 Wire Wrap

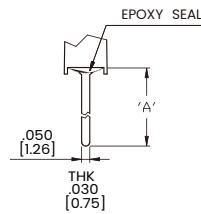

OPTION CODE	DIM.'A'
M5-1	.711 [18.05]
M5-2	.924 [23.48]
M5-3	.386 [9.80]
M5-4	1.022 [25.97]

M6 Single Pole

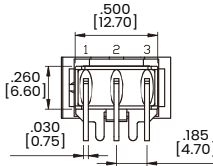
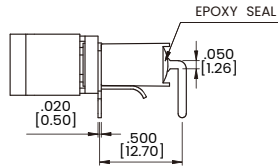
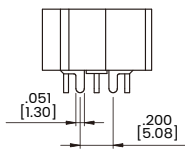

P.C.MOUNTING

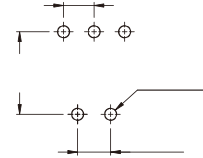

M6 Double Pole

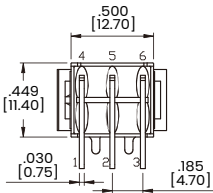
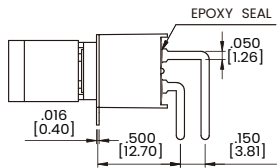
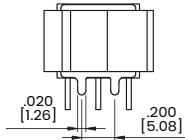

P.C.MOUNTING

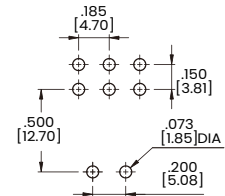

M6 Three Pole

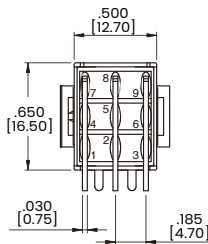
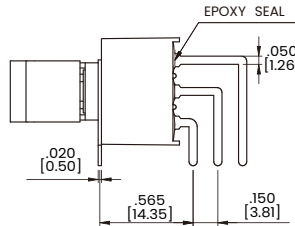
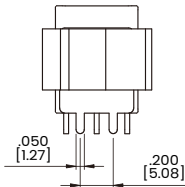

P.C.MOUNTING

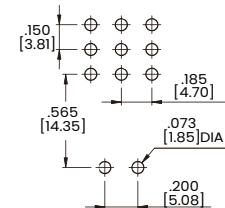

M7 Single Pole

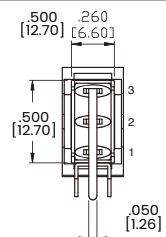
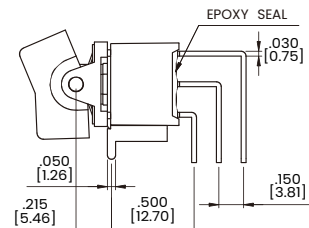
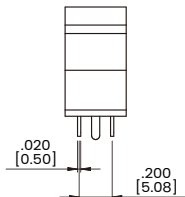

P.C.MOUNTING

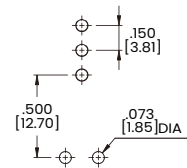

# Dimensional Specs

inches [millimeters]

## Termination Options

### M7 Double Pole

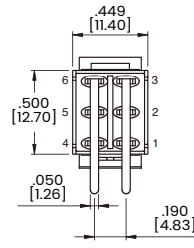
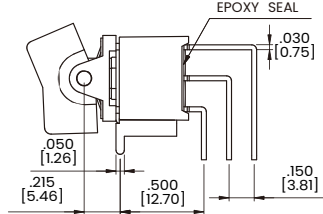
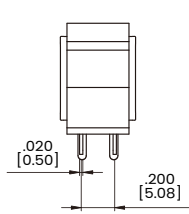

### P.C.MOUNTING

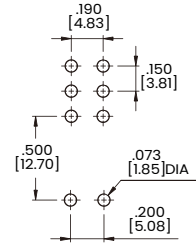

### M7 Three Pole

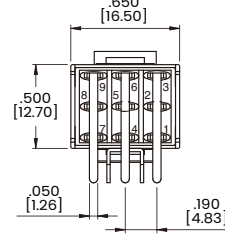
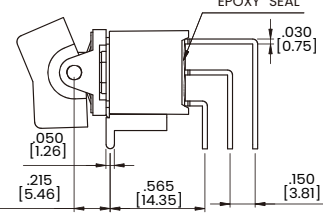
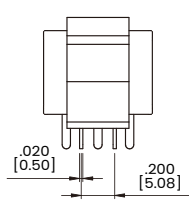

### P.C.MOUNTING

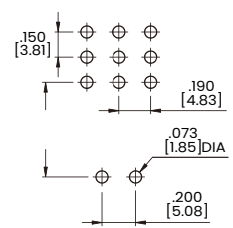

### VS2-VS3 Single Pole

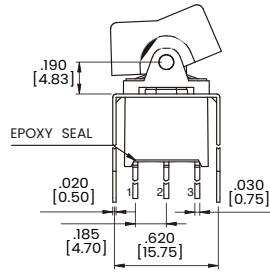
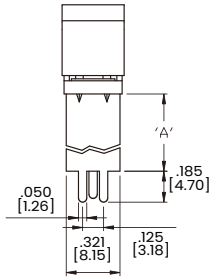

OPTION CODE	DIM.'A'
VS2	.461 [11.70]
VS3	.630 [16.00]

### P.C.MOUNTING

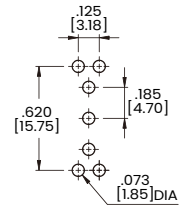

### VS2-VS3 Double Pole

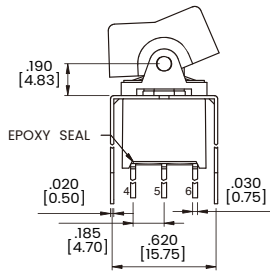
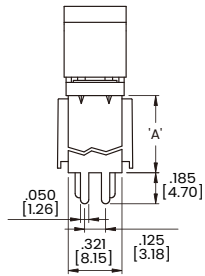

OPTION CODE	DIM.'A'
VS2	.461 [11.70]
VS3	.630 [16.00]

### P.C.MOUNTING

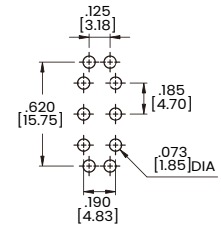

### U2-VS3 Three Pole

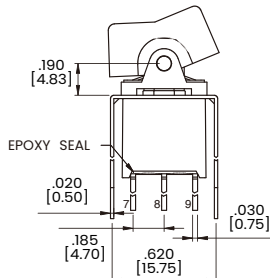
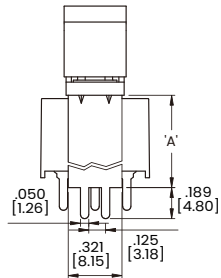

OPTION CODE	DIM.'A'
U2	.551 [14.00]
VS3	.630 [16.00]

### P.C.MOUNTING

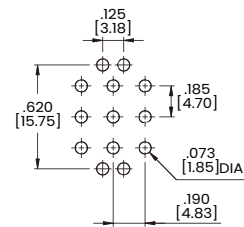

# Dimensional Specs

inches [millimeters]

## Termination Options

### VS4-VS5 Single Pole

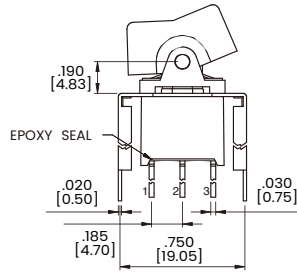
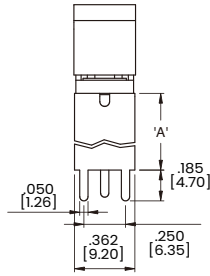

OPTION CODE	DIM.'A'
<b>VS4</b>	.461 [11.70]
<b>VS5</b>	.630 [16.00]

### P.C.MOUNTING

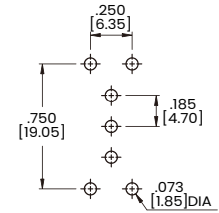

### VS4-VS5 Double Pole

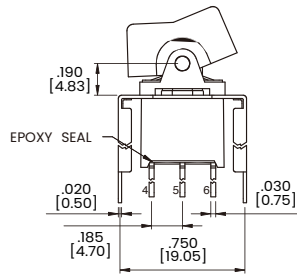
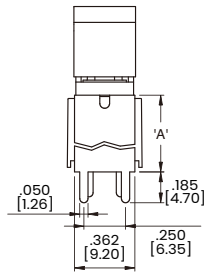

OPTION CODE	DIM.'A'
<b>VS4</b>	.461 [11.70]
<b>VS5</b>	.630 [16.00]

### P.C.MOUNTING

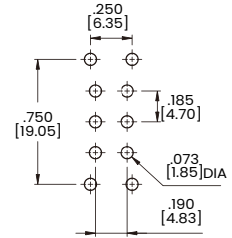

### U4-VS5 Three Pole

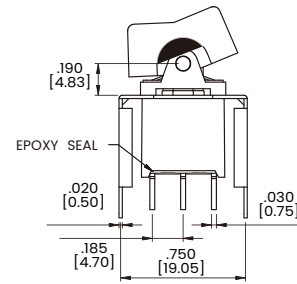
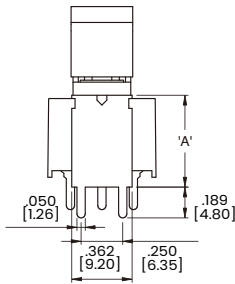

OPTION CODE	DIM.'A'
<b>U4</b>	.551 [14.00]
<b>VS5</b>	.630 [16.00]

### P.C.MOUNTING

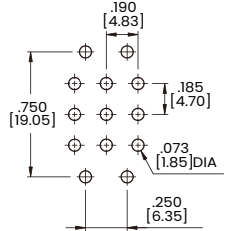

## Snap-In Termination Options

### M61

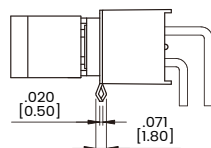
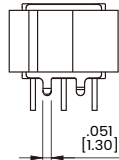
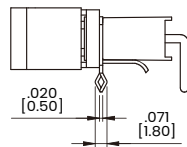
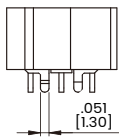

### VS21, VS31

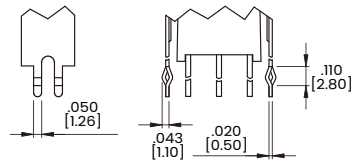

### VS41, VS51

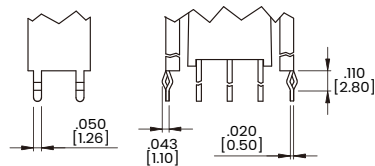

\* PC Mounting for M61, M71, VS21, VS31, VS41, VS51 refer to M6, M7, VS2, VS3, VS4, VS5 respectively.



# Dimensional Specs

inches [millimeters]

## Single Pole

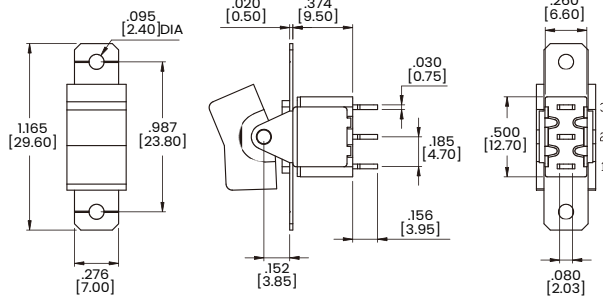

## Double Pole

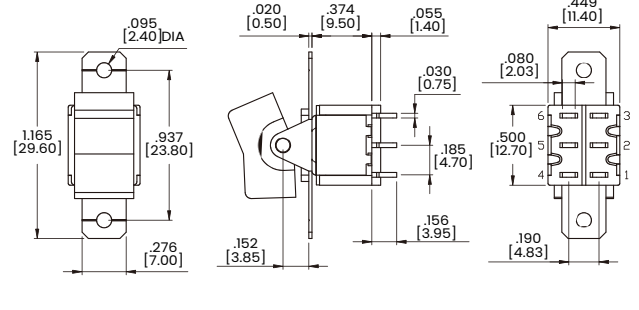

## Three Pole

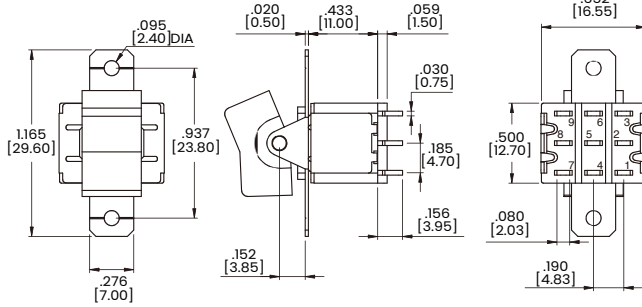

## Four Pole

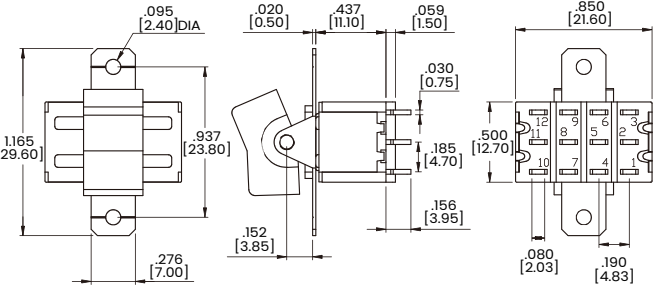

## Actuator Options for Panel Rear Mount

### R1

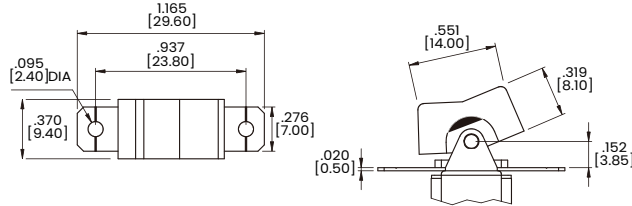

### R2

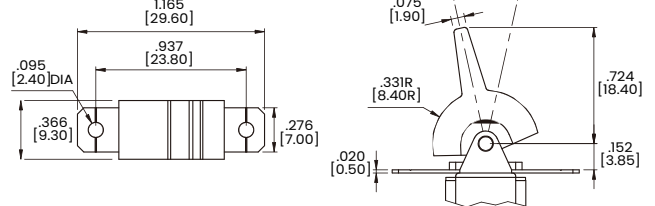

### R3

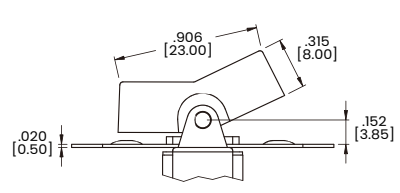
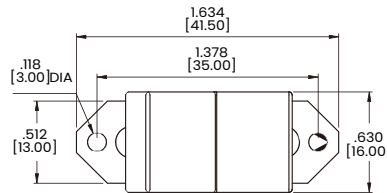

### R4

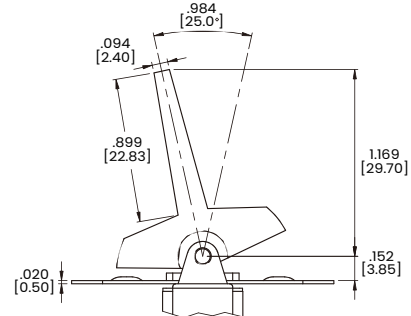
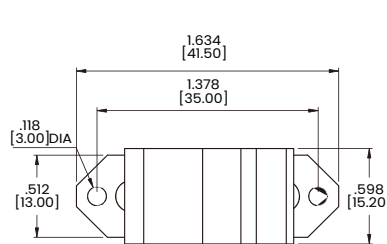

# Dimensional Specs

inches [millimeters]

## Actuator Options for Panel Rear Mount

R5

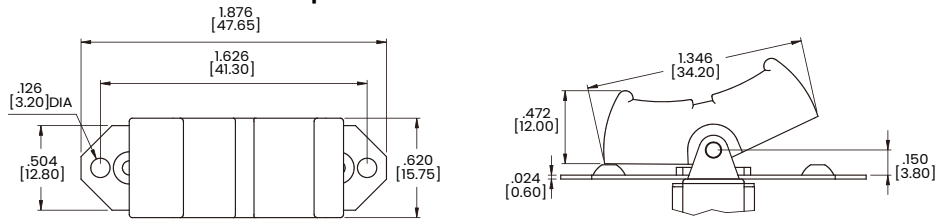

## Actuator Options for Snap-In Mount

R6

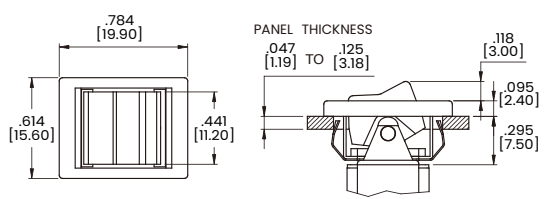

R6 WITHOUT FRAME

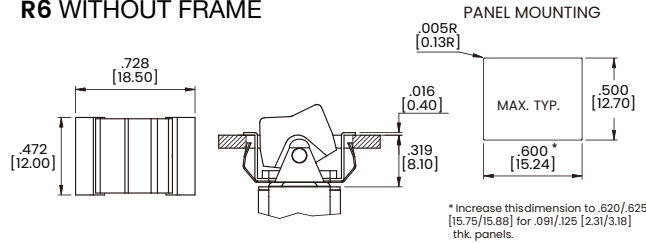

R7

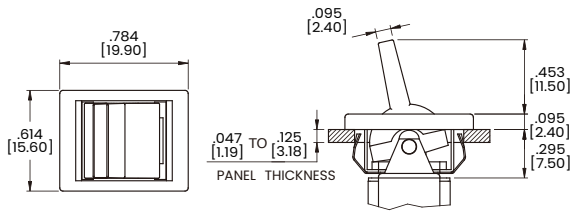

R7 WITHOUT FRAME

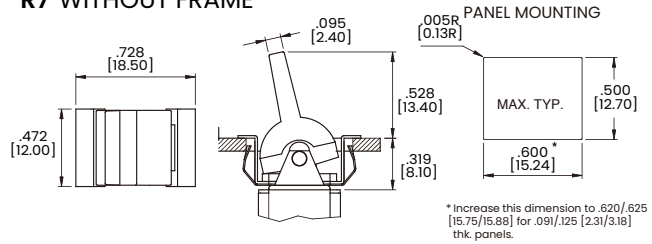

## Actuator Options for PC Mount

R1

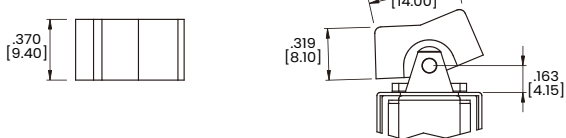

R2

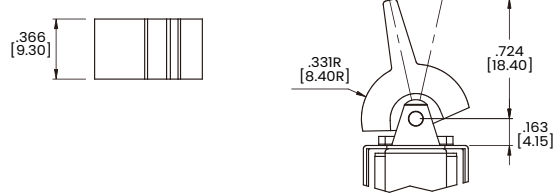

R3

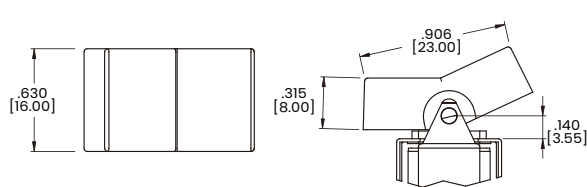

R4

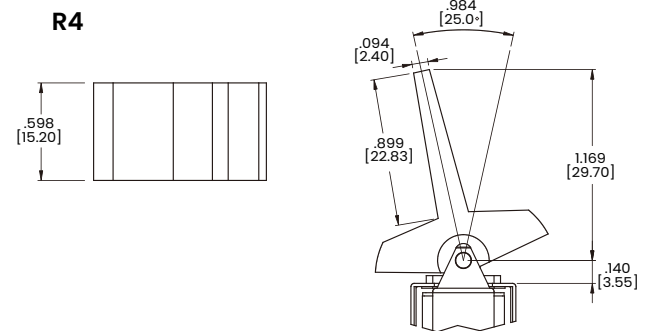

# Dimensional Specs

inches [millimeters]

## Actuator Options for PC Mount

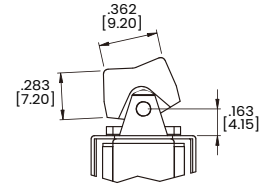
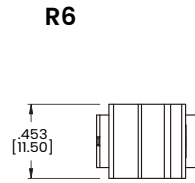
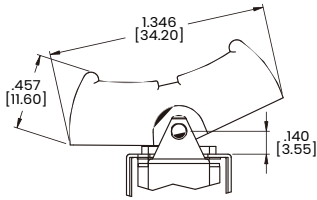
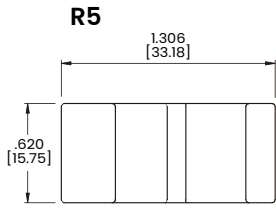

**R7**

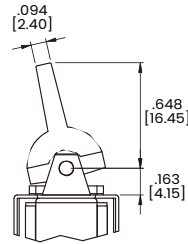
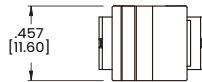

## Termination Options

**M1 Standard Solder Lug**

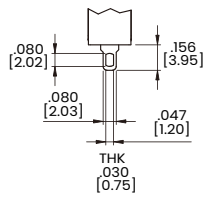

**M2 PC Thru-Hole**

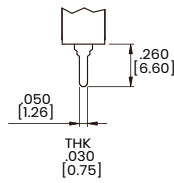

**M3 Quick Connect**

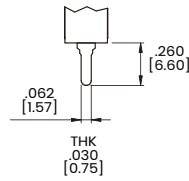

**M5 Wire Wrap**

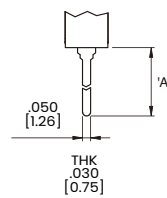

OPTION CODE	DIM. 'A'
M5-1	.750 [19.05]
M5-2	.964 [24.48]
M5-3	.425 [10.80]
M5-4	1.062 [26.97]

**M6 Single Pole**

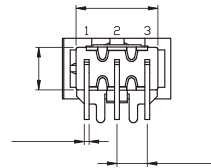
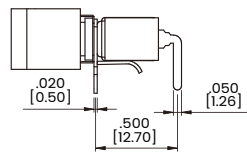
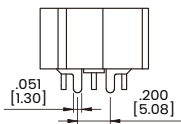

**P.C.MOUNTING**

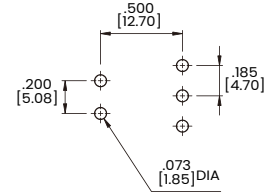

**M6 Double Pole**

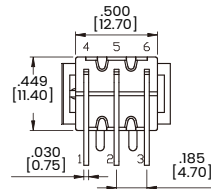
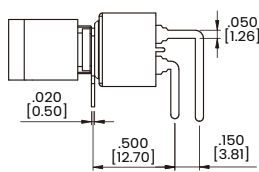
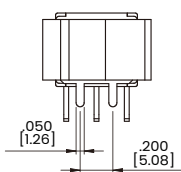

**P.C.MOUNTING**

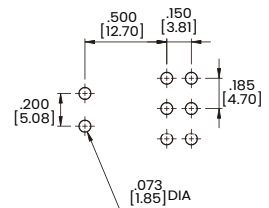

**M7 Single Pole**

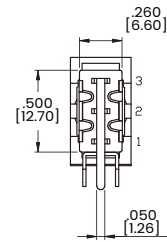
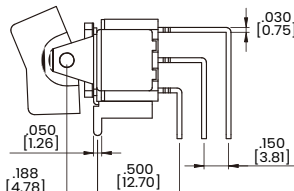
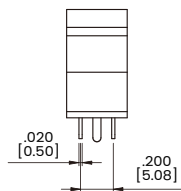

**P.C.MOUNTING**

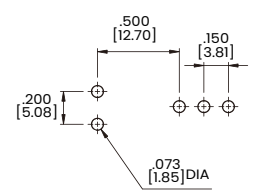

# Dimensional Specs

inches [millimeters]

## Termination Options

### M7 Double Pole

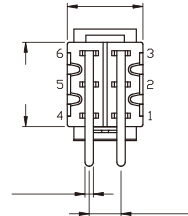
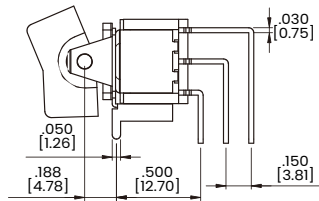
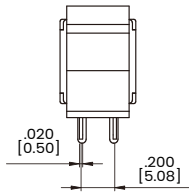

### P.C.MOUNTING

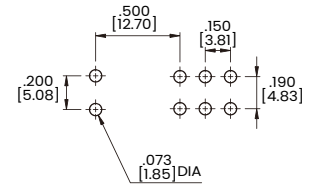

### M7 Three Pole

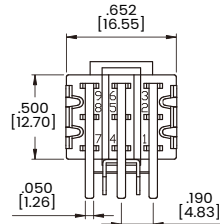
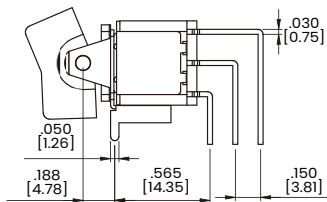
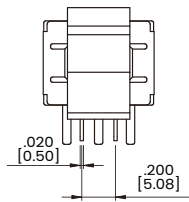

### P.C.MOUNTING

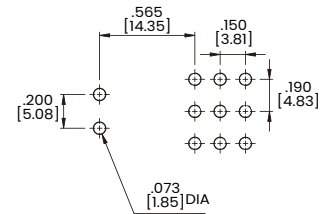

### M7 Four Pole

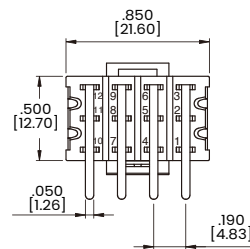
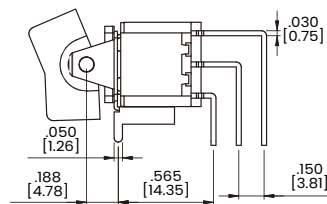
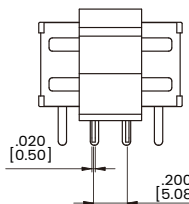

### P.C.MOUNTING

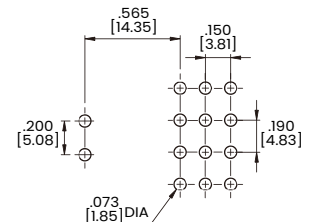

### VS2-VS3 Single Pole

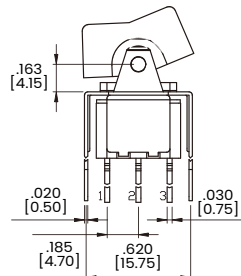
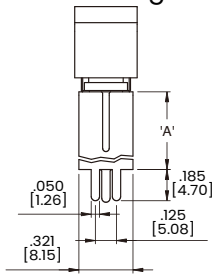

OPTION CODE	DIM.'A'
VS2	.461 [11.70]
VS3	.630 [16.00]

### P.C.MOUNTING

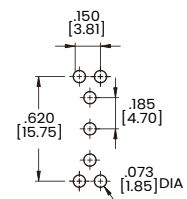

### VS2-VS3 Double Pole

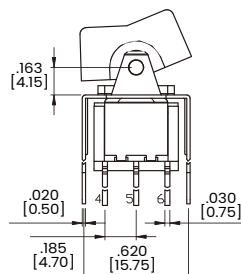
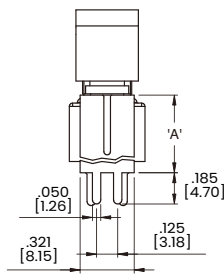

OPTION CODE	DIM.'A'
VS2	.461 [11.70]
VS3	.630 [16.00]

### P.C.MOUNTING

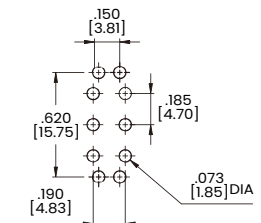

# Dimensional Specs

inches [millimeters]

## Termination Options

### VS4-VS5 Single Pole

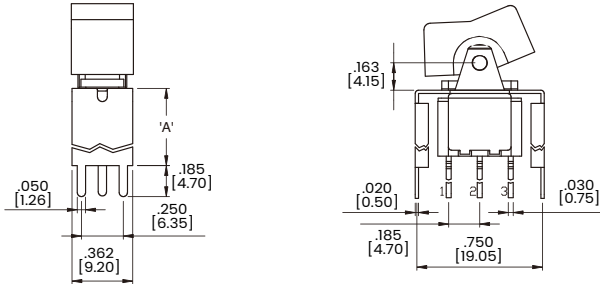

OPTION CODE	DIM.'A'
<b>VS4</b>	.461 [11.70]
<b>VS5</b>	.630 [16.00]

### P.C.MOUNTING

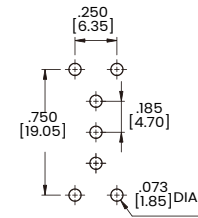

### VS4-VS5 Double Pole

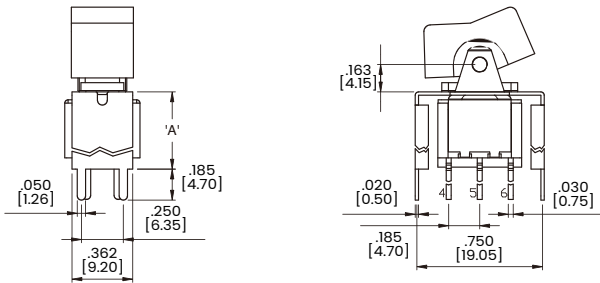

OPTION CODE	DIM.'A'
<b>VS4</b>	.461 [11.70]
<b>VS5</b>	.630 [16.00]

### P.C.MOUNTING

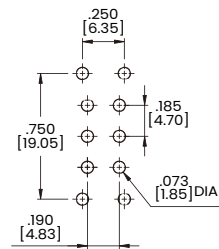

### U4-VS5 Three Pole

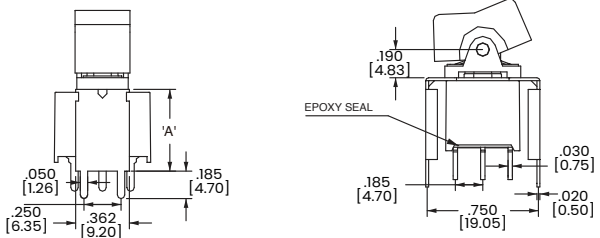

OPTION CODE	DIM.'A'
<b>U4</b>	.551 [14.00]
<b>VS5</b>	.630 [16.00]

### P.C.MOUNTING

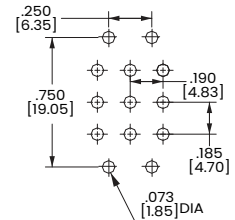

## Snap-In Termination Options

### M61

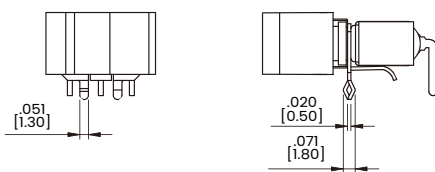

### VS21, VS31

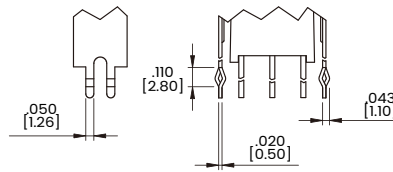

### VS41, VS51

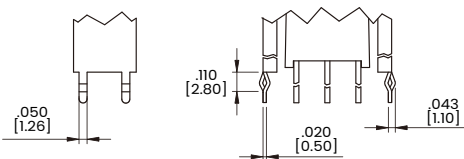

\* PC Mounting for M61, VS21, VS31, VS41, VS51 refer to M6, VS2, VS3, VS4, VS5 respectively.

## Authorized Sales Representatives and Distributors

Click on a region of the map below to find your local representatives and distributors or visit [www.carlingtech.com/findarep](http://www.carlingtech.com/findarep).



## About Carling

Founded in 1920, Carling Technologies is a leading manufacturer of electrical and electronic switches and assemblies, circuit breakers, electronic controls, power distribution units, and multiplexed power distribution systems. With six ISO9001 and IATF16949 registered manufacturing facilities and technical sales offices worldwide, Carling Technologies Sales, Service and Engineering teams do much more than manufacture electrical components, they engineer powerful solutions! To learn more about Carling please visit [www.carlingtech.com/company-profile](http://www.carlingtech.com/company-profile).

To view all of Carling's environmental, quality, health & safety certifications please visit [www.carlingtech.com/environmental-certifications](http://www.carlingtech.com/environmental-certifications).