

LOOSE PIECE		TAPE MOUNTED		SPECIFICATIONS					
MATERIAL NUMBER	ENGINEERING NUMBER	MATERIAL NUMBER	ENGINEERING NUMBER	STUD SIZE	"S" ±.005 [0.13]	"W" ±.010 [0.25]	"C" MIN.	"L" MAX.	"H"
191980044	C-841-06	---	---	6	.146 [3.71]	.375 [9.53]	.301 [7.65]	1.118 [28.40]	.980 [24.89]
191980047	C-841-08	191980048	C-841-08T	8	.173 [4.39]				
191980050	C-841-10	191980051	C-841-10T	10	.198 [5.03]				

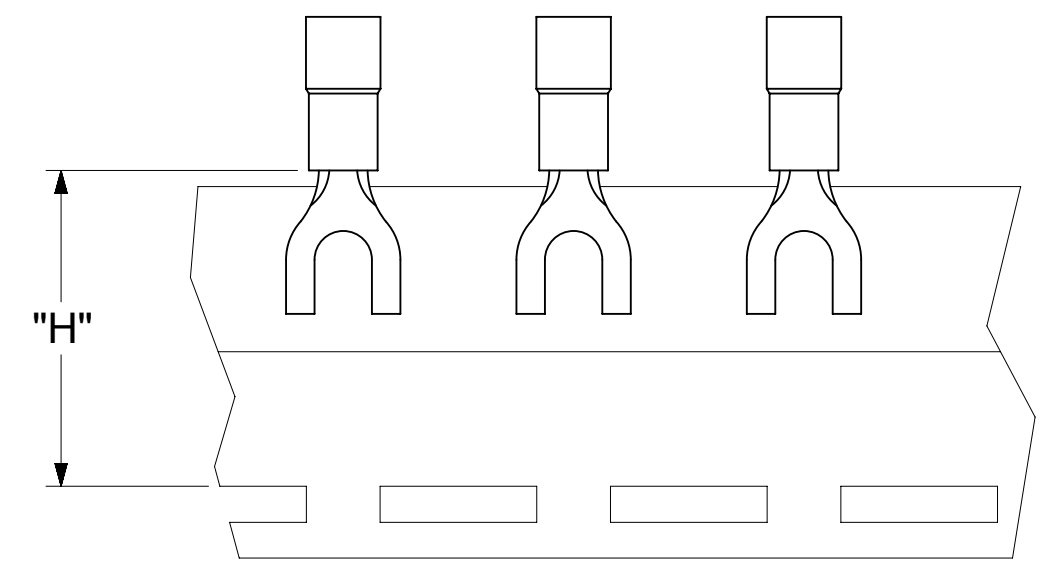
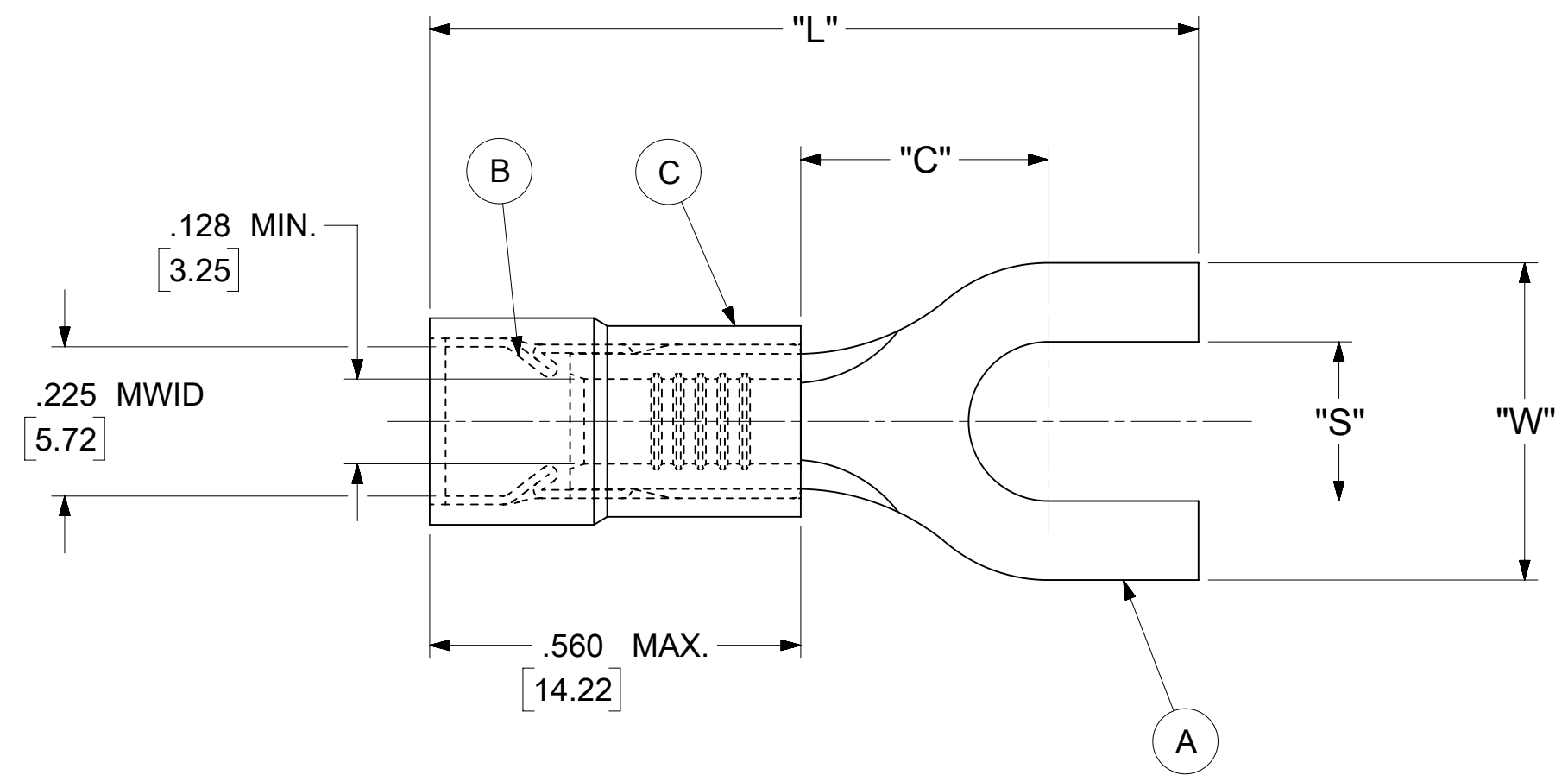

PARTS ON TAPE

NOTES:

- MATERIAL:
  - (A). TERMINAL: COPPER (STOCK THICKNESS .040±.001 [1.02] )  
PLATING: ELECTRO-TIN (.0003 MIN.)
  - (B). TIN-PLATED BRASS FUNNEL FERRULE
  - (C). INSULATION: NYLON (COLOR CODED YELLOW)
- MWID: MAXIMUM WIRE INSULATION DIAMETER
- WIRE SIZE: 12 - 10 AWG  
4.0 - 6.0 MM<sup>2</sup>
- "UL" LISTING #E32244  
"CSA" LISTING #18689
- ALL DIMENSIONS IN INCHES/[MM].
- PARTS ARE ROHS COMPLIANT.
- DIMS. SHOWN ARE FOR REFERENCE ONLY.

<b>SYMBOLS</b> DIMENSION UNITS SCALE CURRENT REV DESC: MIGRATION TO ECTR/NX EC NO: 621540 DRWN: ABENJAMINLW 2019/07/25 CHK'D: GROJAS01 2019/07/29 APPR: JMACNEIL 2019/08/05 INITIAL REVISION: DRWN: JJ 1984/11/12 APPR: JMACNEIL 2019/08/05 DRAFT WHERE APPLICABLE MUST REMAIN WITHIN DIMENSIONS THIRD ANGLE PROJECTION DRAWING SERIES <b>C-SIZE 19198</b>	THIS DRAWING CONTAINS INFORMATION THAT IS PROPRIETARY TO MOLEX ELECTRONIC TECHNOLOGIES, LLC AND SHOULD NOT BE USED WITHOUT WRITTEN PERMISSION			<b>molex</b> SPADE TONGUE TERMINAL AVIKRIMP - 800 SERIES PRODUCT CUSTOMER DRAWING		
	INCH/MM GENERAL TOLERANCES (UNLESS SPECIFIED) 4 PLACES ± --- ± --- 3 PLACES ± --- ± .005 2 PLACES ± 0.13 ± .01 1 PLACE ± 0.25 ± --- 0 PLACES ± --- ± --- ANGULAR TOL ± 0.5 °	NTS MM INCH ± --- ± --- ± .005 ± .01 ± ---	DOCUMENT NUMBER <b>191980044</b> MATERIAL NUMBER SEE TABLE			
	DOCUMENT STATUS <b>P1</b> RELEASE DATE <b>2019/08/05 20:29:27</b>	DIMENSION UNITS: INCH/MM, SCALE: NTS, CURRENT REV DESC: MIGRATION TO ECTR/NX, EC NO: 621540, DRWN: ABENJAMINLW 2019/07/25, CHK'D: GROJAS01 2019/07/29, APPR: JMACNEIL 2019/08/05, INITIAL REVISION: DRWN: JJ 1984/11/12, APPR: JMACNEIL 2019/08/05, DRAFT WHERE APPLICABLE MUST REMAIN WITHIN DIMENSIONS, THIRD ANGLE PROJECTION, DRAWING SERIES: C-SIZE 19198, DOCUMENT NUMBER: 191980044, MATERIAL NUMBER: SEE TABLE, DOC TYPE: PSD, CUSTOMER: GENERAL MARKET, DOC PART: 000, SHEET NUMBER: 1 OF 1, REVISION: A				
	DIMENSIONS: L, C, S, W, H, A, B, C					