

DESCRIPTION: 2MM RECEPTACLES - TR/TC

UNITS = INCHES [MM]

MATERIAL:

HOUSING: NYLON 6T, UL 94V-0, BLACK
CONTACT: PHOSPHOR BRONZE
PLATING: GOLD FLASH ENTIRE CONTACT

ELECTRICAL:

CURRENT RATING: 2 AMPS
CONTACT RESISTANCE: 20mOHMS Max.
INSULATOR RESISTANCE: 5,000MOHMS Min.
DIELECTRIC WITHSTANDING: 500VAC
OPERATING TEMPERATURE: -40° TO +105° C
PROCESS TEMPERATURE: 260° C FOR 10 SECONDS

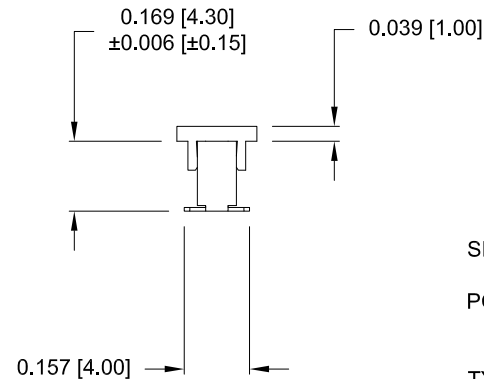
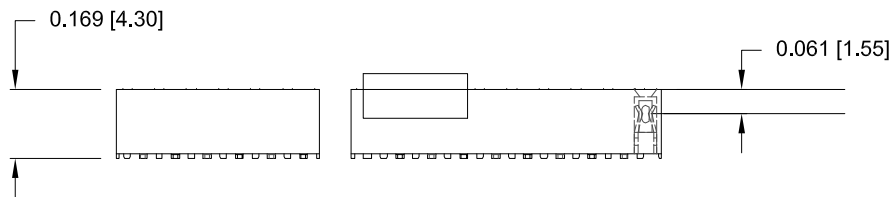
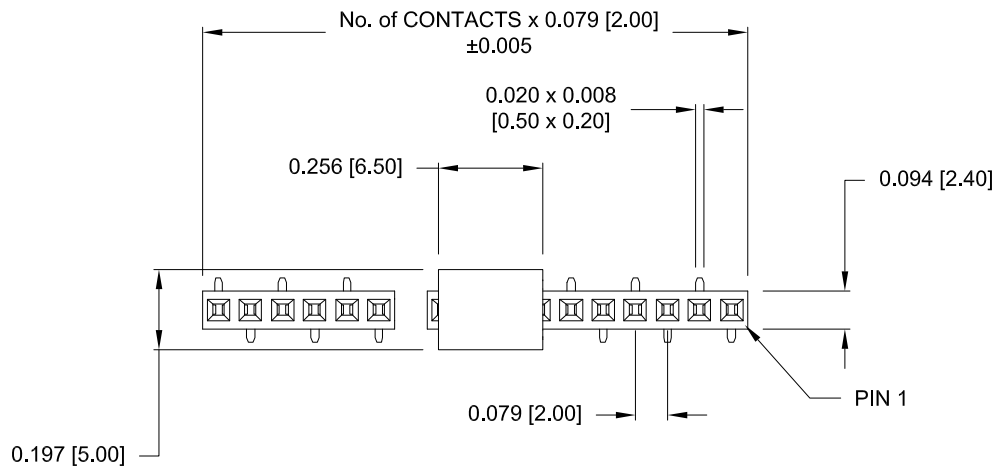

2863 YY 06 R P2 YY

SERIES _____
2863 = SINGLE ROW
POSITIONS _____
SINGLE - INCREMENTS OF 1
(3 TO 40)
TYPE _____
06 = SURFACE MOUNT
RoHS COMPLIANT _____
HIGH TEMP. _____
PLATING _____
P2 = GOLD FLASH
PACKAGING _____
TR = TAPE AND REEL
TC = TUBE PACK WITH PP CAP

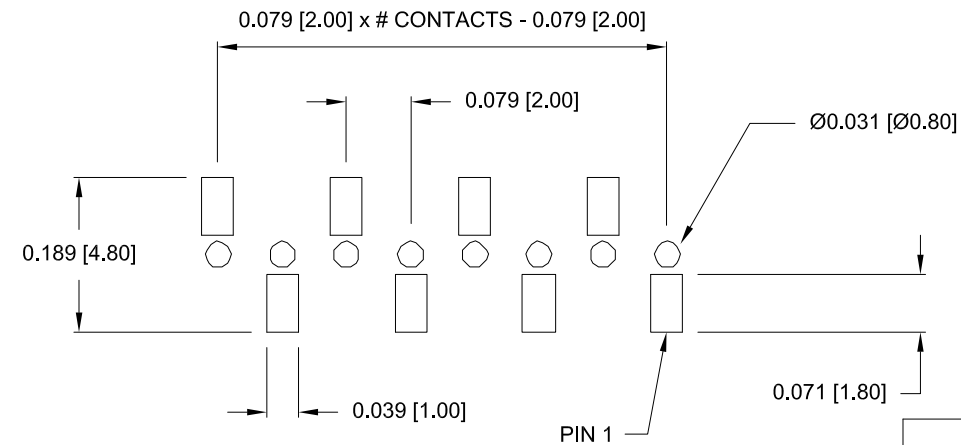

PCB LAYOUT

RoHS COMPLIANT

GENERAL TOLERANCE = $\pm 0.008 [\pm 0.20]$

DO NOT SCALE FROM DRAWING



THESE DRAWINGS AND SPECIFICATIONS ARE THE PROPERTY OF NorComp AND SHALL NOT BE REPRODUCED, COPIED OR USED AS THE BASIS FOR THE MANUFACTURE OR SALE OF APPARATUS WITHOUT WRITTEN PERMISSION.

DRAWN: J. KADEL		DATE: 01/11/2019	
SCALE: NTS	SHEET 1	OF 1	REV 0
DWG NO.		2863YY06RP2YY	

NorComp