

NOTES: UNLESS OTHERWISE SPECIFIED

- CONSTRUCTION:
HOUSING & PLUNGER: NYLON. AVAILABLE IN 10 COLORS
CONTACT BLADE: GOLD PLATED BeCu
SPRING: STAINLESS STEEL
HARDWARE: STAINLESS STEEL.
CONTACT SOCKET: NICKEL PLATED BECU.
- PERFORMANCE:
MAXIMUM CURRENT: 6.9 AMPS WITH 76° TEMPERATURE RISE.
MAXIMUM VOLTAGE: 2.0 KV
MAXIMUM TEMPERATURE: 175°F (79°C)
- FEATURES:
HOOK FITS COMPONENTS UP TO $\phi 0.040$ " [$\phi 1.01$]
 $\phi 0.0163$ " [$\phi 0.414$] BANANA SOCKET.
FIELD SERVICEABLE.

LTR	DESCRIPTION	REVISIONS	
		DATE	APPROVED

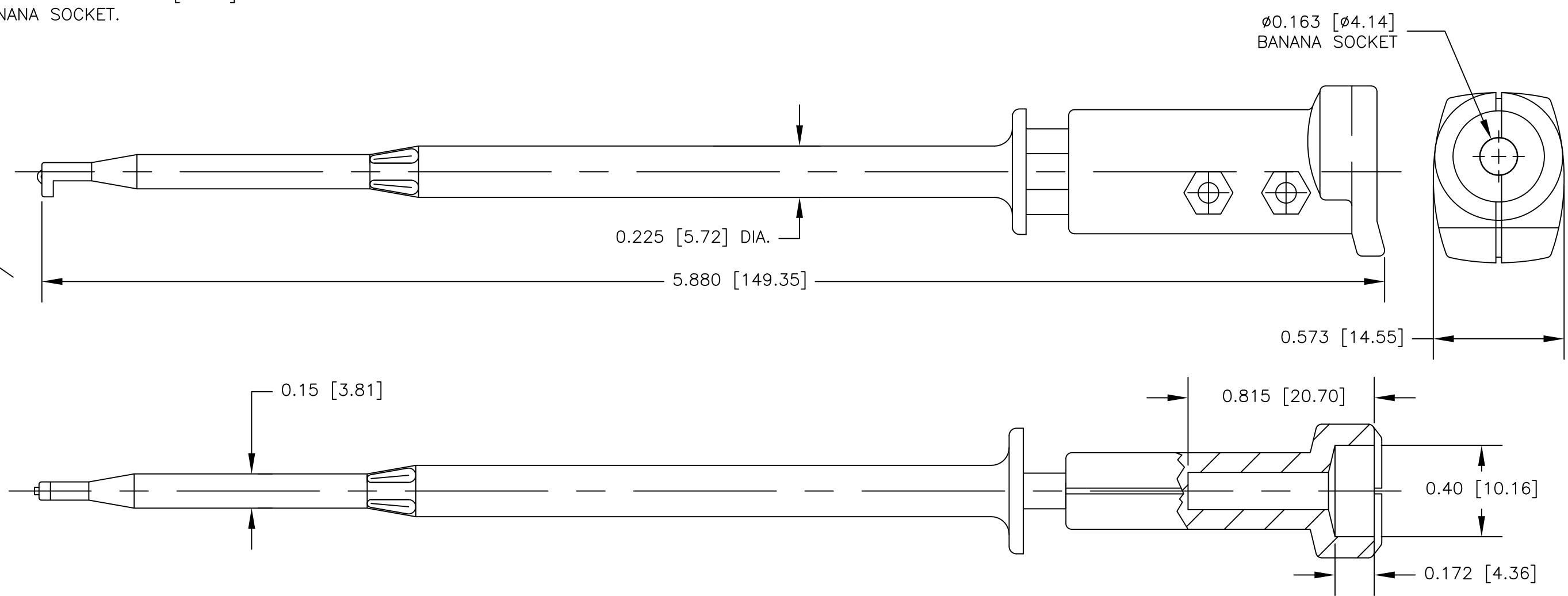
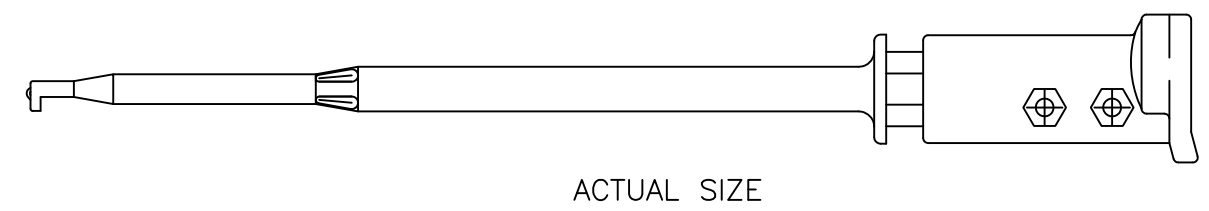

HOOK DETAIL
SCALE: 4:1

UNLESS OTHERWISE SPECIFIED DIMENSIONS ARE IN INCHES TOLERANCES ARE: FRACTIONS DECIMALS ANGLES ± .XX ± ± .XXX ±		CONTRACT NO.		E-Z-HOOK DIVISION OF TEKTEST INC. ARCADIA, CA 91006 U.S.A.	
MATERIAL SEE NOTE.		APPROVALS	DATE		
FINISH SEE NOTE.		DRAWN	R.L. 11/09	DESCRIPTION MINI-HOOK (XLI) W/STD BANANA SOCKET	
NEXT ASSY	USED ON	APPROVED BY		SIZE	CODE IDENT NO.
APPLICATION		DO NOT SCALE DRAWING		B	08505
				DRAWING NO.	REV.
				8038	
				SCALE	2:1
				SHEET 1 OF 1	