

**PLEASE CHECK WWW.MOLEX.COM FOR LATEST PART INFORMATION**

**Part Number:** [0191600022](#)  
**Status:** **Active**  
**Overview:** [Splices](#)  
**Description:** Closed-End Connector Insert for 12-22 AWG Wire

**Documents:**

[Drawing \(PDF\)](#) [RoHS Certificate of Compliance \(PDF\)](#)  
[Product Specification PS-19902-013-001 \(PDF\)](#)

**General**

Product Family	Splices
Series	<a href="#">19160</a>
Crimp Quality Equipment	Yes
Overview	<a href="#">Splices</a>
Product Name	Closed-End Connector Insert
UPC	800755091526

**Physical**

Barrel Type	Closed
Insulation	None
Material - Metal	Copper
Material - Plating Mating	Tin
Material - Plating Termination	Tin
Net Weight	0.359/g
Packaging Type	Bag
Temperature Range - Operating	149°C
Wire Insulation Diameter	N/A
Wire Size AWG	12, 14, 16, 18, 20, 22

**Material Info**

Engineering Number	CE-2212
--------------------	---------

**Reference - Drawing Numbers**

Product Specification	PS-19902-013-001
Sales Drawing	SD-19160-009-001

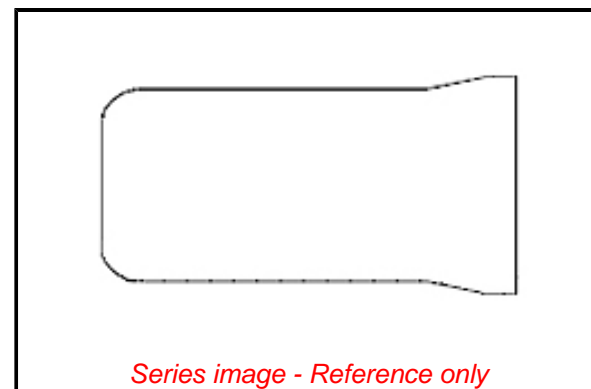

**EU ELV**

**Not Relevant**

**EU RoHS**

**Compliant**

**REACH SVHC**

Not Contained Per -  
D(2021)4569-DC (8  
July 2021)

**Halogen-Free**

**Status**

**Low-Halogen**

For more information, please visit [Contact US](#)

China ROHS

ELV

RoHS Phthalates

**China RoHS**

Green Image

Not Relevant

Not Contained

**Search Parts in this Series**

[19160 Series](#)